



INSTRUCTIONS

J01538

2011-08-19



ENGINE GUARD KITS

GENERAL

Kit Number

49024-02, 49078-04, 49200-07A

Models

For model fitment information, see the P&A Retail Catalog or the Parts and Accessories section of www.harley-davidson.com (English only).

NOTE

These kits will not fit models equipped with Oil Cooler Part Number 26136-05.

Kit Contents

See Figure 6 and Table 1.

▲ WARNING

If Equipped: Front and/or rear guards are not intended to provide protection from bodily injury in a collision with another vehicle or any other object. (00022d)

INSTALLATION

FXSTD models only:

- See Figure 5. Remove the clutch cable (2) from the clamp (1) on the downtube.
- Position the engine guard between the front of the downtubes and behind the clutch cable.

All Models

1. See Figure 1. Check the position of the clutch cable clip (4). The clip should extend outboard. If it does not, rotate the clip 180 degrees as follows:
 - a. Open clutch cable clip (4) on left downtube (2) and remove the clutch cable (5) from the clip.
 - b. Loosen the screw holding the clutch cable clip.
 - c. Rotate the clip 180 degrees.
 - d. Tighten the clutch cable clip screw.
 - e. Install clutch cable back into the clutch cable clip.

NOTE

See Figure 1. When installing engine guard on models with ABS brakes, route the brake line (1) outboard of the frame tube and behind the engine guard (3) as shown. Rotate the brake line retaining clips (6) as shown to allow proper brake line routing.

2. See Figure 2 and Figure 3. Align the top center mounting plate with the frame cross brace, located between the front downtubes.

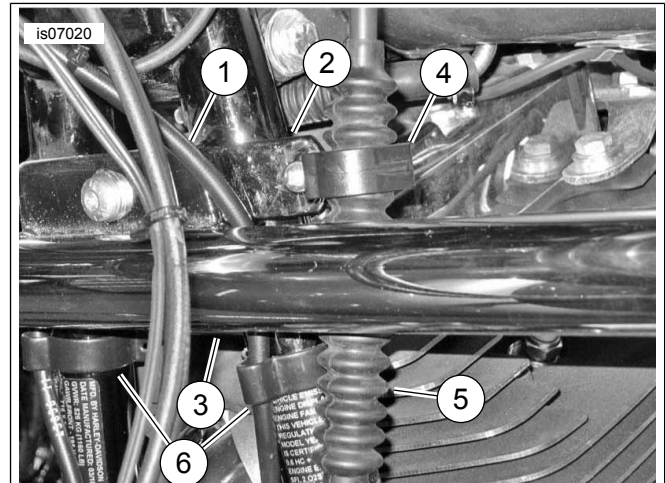

1. ABS brake line
2. Down tube
3. Engine guard
4. Clutch cable clip
5. Clutch cable
6. Brake line clip

Figure 1. Brake Line and Clutch Cable Routing

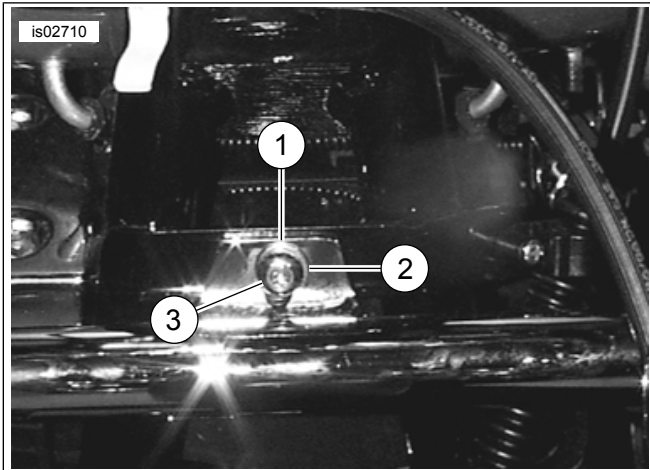

Figure 2. Engine Guard Installed

3. Fasten the mounting plate to the cross brace with screw (3), washer (2), and hex nut (1) as shown. Do not tighten.



- See Figure 6. Install the left side engine guard (1) with a screw (7), washer (6), and locknut (5). Do not tighten.



- Hex nut (behind frame cross brace)
- Washer (2)
- Screw

Figure 3. Engine Guard Mounting Plate (Top Center)

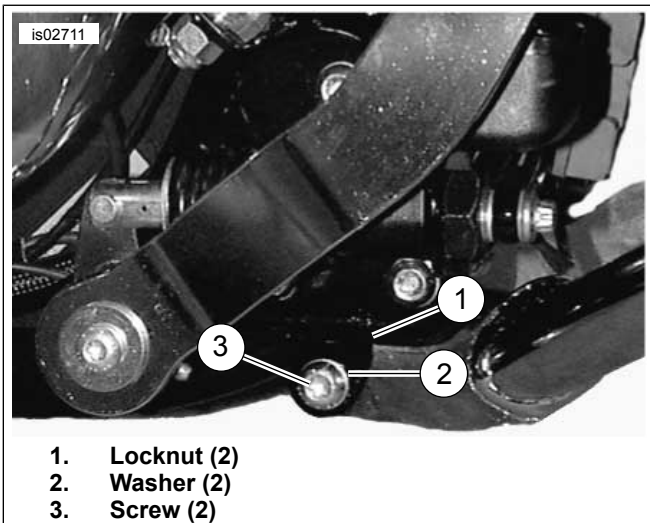

- Locknut (2)
- Washer (2)
- Screw (2)

Figure 4. Engine Guard Lower Mounting (Right Side View)

- See Figure 4. Repeat Step 4 for the right side.
- Tighten the right side screw to 44 N·m (33 ft-lbs). Repeat for the left side.
- Tighten the engine guard top center mounting hardware to 25 N·m (19 ft-lbs).
- FXSTD models only:** See Figure 5. Remove and discard stock clamp (1). Fasten the clutch cable (2) to the downtube and engine guard with the two cable straps (3) from the kit.

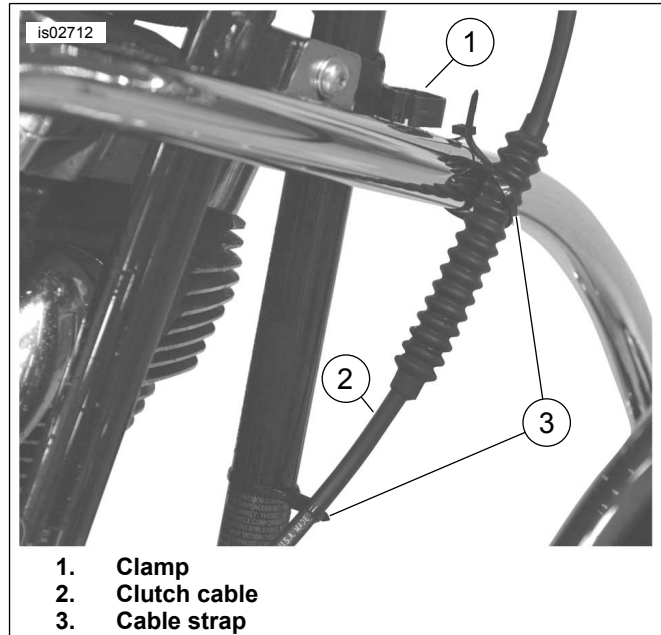

- Clamp
- Clutch cable
- Cable strap

Figure 5. FXSTD Clutch Cable and Cable Strap

SERVICE PARTS

is02713

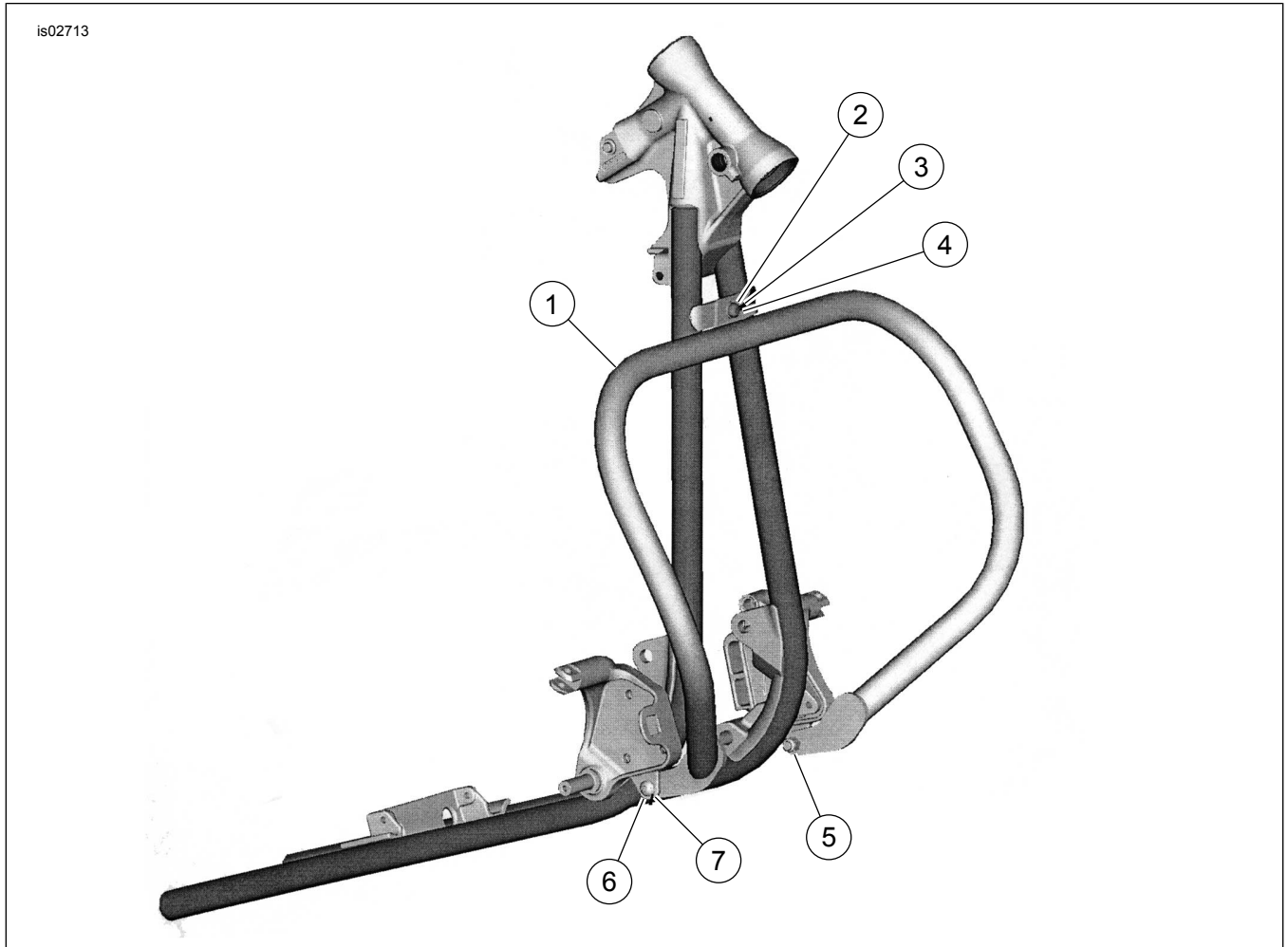

Figure 6. Service Parts: Engine Guard

Table 1. Service Parts: Engine Guard

Item	Description (Quantity)	Part Number
1	Engine guard	Not Sold Separately
2	Hex nut, 5/16 inch	7748W
3	Washer, 5/16 inch (2)	6702
4	Screw, pan head	3655A
5	Locknut, nylon, 3/8-16 (2)	7778
6	Washer, 3/8 inch (2)	6812
7	Screw, buttonhead (2)	4188
	Screw, buttonhead (2) (Kit 49078-04 only)	4459
8	Cable strap (2), (FXSTD only) (not shown)	10081