



INSTRUCTIONS

J00099

2007-02-06



SOFTAIL CUSTOM SEAT KITS

GENERAL

Kit Number

See Table 1 and Table 2.

Models

The kits in Table 1 fit 2000-2006 FLSTF models and 2000-2005 Softail models (except FXSTD, FLSTS, FLSTSC, and FLSTN).

The kits in Table 2 fit 2006 and later FLST, FLSTC, and FLSTSC models.

Kit Contents

See Table 1 and Table 2 for the grab strap associated with each seat kit.

See Figure 1 and Table 3 for the service parts.

Table 1. Kit Numbers and Grab Strap Usage

Kit Number	Grabstrap	Kit Number	Grabstrap
51080-02	51944-01	52458-02	51951-01
51081-02	51944-01	52497-03	51944-01
51082-02	51944-01	52642-04	51944-01
51083-02	51944-01	52664-04	51944-01
51285-02	51944-01	52665-04	51944-01
51286-02	51944-01	52666-04	51944-01
51287-02	51944-01	52671-04	51944-01
51288-02	51944-01	52674-04	51944-01
51662-05	51944-01	53367-02	51951-01
51682-05	51944-01	53368-02	51944-01
51683-05	51944-01	53403-02	51944-01
52065-06	51944-01	54027-04	51944-01
52068-06	51944-01	54028-04	51944-01
52094-06	51944-01	54029-04	51944-01
52119-06	51944-01	54030-04	51944-01
52169-06	51944-01	54031-04	51944-01
52173-06	51944-01	54032-04	51944-01
52312-02	51951-01	54058-05	51944-01
52440-03	51944-01	54059-05	51944-01
52423-02	51951-01	54060-05	51944-01
52436-02	51951-01	54061-05	51944-01
52457-02	51951-01		

Table 2. Kit Numbers and Grab Strap Usage

Kit Number	Grabstrap	Kit Number	Grabstrap
51396-07	51944-01	51695-06	51951-01
51693-06	51944-01	51696-06	51944-01
51694-06	51944-01		

INSTALLATION

NOTE

When performing the following installation procedures, avoid scratching painted surfaces (fender, tank, etc.) with tools or metal seat tabs.

2000-2005 FL Softail Models

1. Remove existing seat, grab strap, and pillion (if applicable) following the instructions in the Owner's Manual.
2. See Figure 1. Install flange nuts (1) onto seat mounting studs on rear fender.
3. Install grab strap (2) using washers (3), screws (4), and stock locknuts (A). Tighten to 25 ft-lbs (33.9 Nm).
4. Slide rear of new seat (5) through grab strap.
5. Fully engage front seat mounting tab on new seat into hole in frame.
6. Fasten new seat (5) to rear fender using knurled knob (6) and neoprene washer (7).

⚠ WARNING

After installing seat, pull upward on seat to be sure it is locked in position. While riding, a loose seat can shift causing loss of control, which could result in death or serious injury. (00070b)

7. Remove adhesive backing from emblem (8) and apply to center recess on knurled knob. Apply even pressure to emblem for one minute.

2006-Later FX Softails (Except FXSTD) and 2007-Later FLSTF Models

1. Remove existing seat, grab strap, and pillion (if applicable) following the instructions in the Owner's Manual.
2. Install grab strap (9) using stock washers (B), screws (4), and stock locknuts (A).
3. Slide rear of new seat (5) through grab strap.
4. Hook front tab of seat into frame and secure seat bracket to fender with knurled knob (6) and neoprene washer (7)

⚠ WARNING

After installing seat, pull upward on seat to be sure it is locked in position. While riding, a loose seat can shift causing loss of control, which could result in death or serious injury. (00070b)

- Remove adhesive backing from emblem (8) and apply to center recess on knurled knob. Apply even pressure to emblem for one minute.

SERVICE PARTS

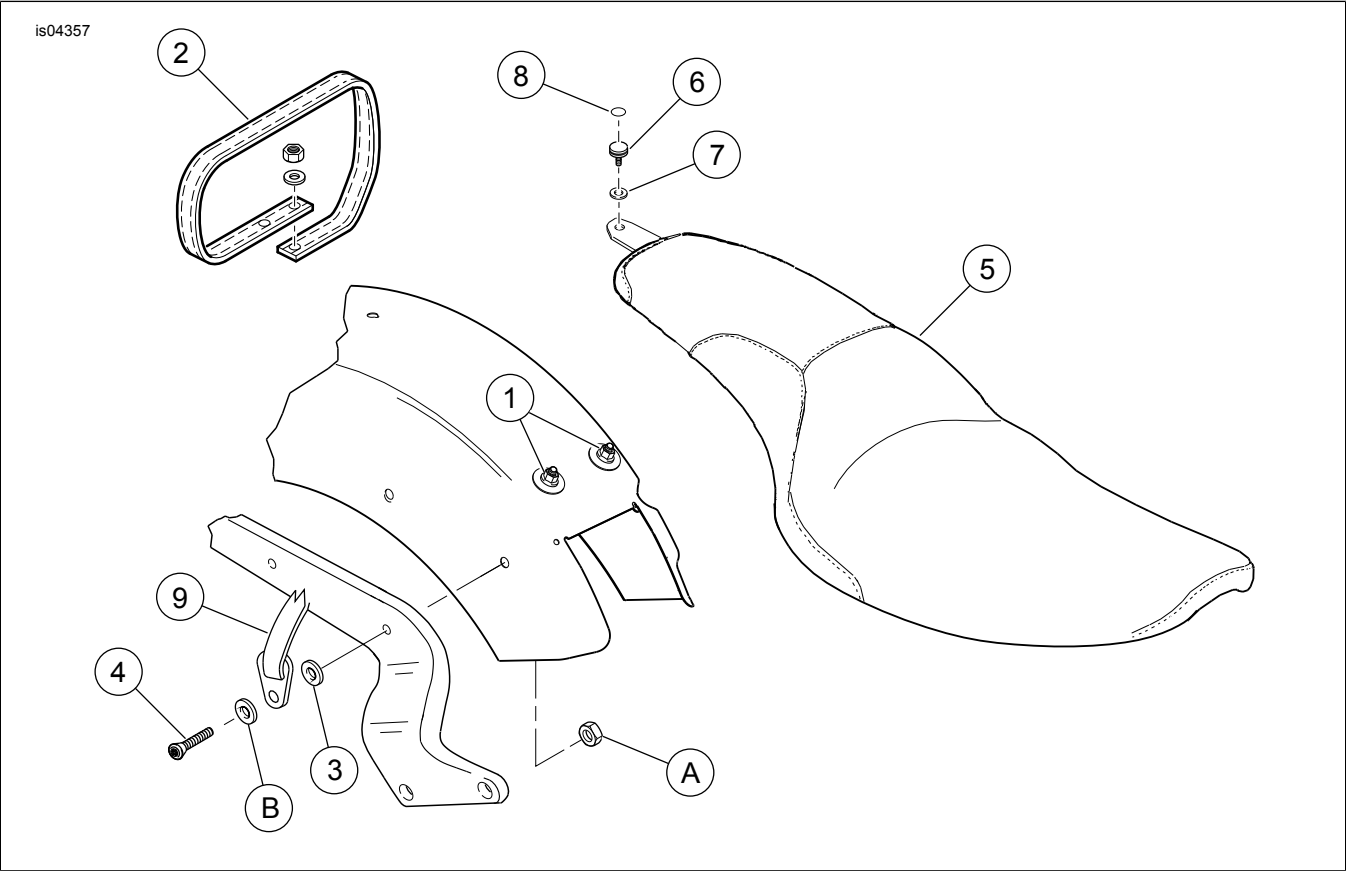

Figure 1. Service Parts: Softail Custom Seat Kits

Table 3. Service Parts Table

Item	Description (Quantity)	Part Number	Item	Description (Quantity)	Part Number
1	Nut, flange (2)	7499	8	Emblem	14628-96
2	Grab strap, FL models	See Tables 1 and 2	9	Grab strap, FX models	See Tables 1 and 2
3	Washer, thick (2)	6019	10	Leather dressing (not shown)	Not Sold Separately
4	Screw (2)	4180	Stock items mentioned in text, but not included in kit.		
5	Seat (generic style seat shown)	Not Sold Separately	A	Locknut	
6	Knurled knob	3649	B	Washer	
7	Washer, neoprene	6205			