



INSTRUCTIONS

J03419

2006-05-06



SOLENOID COVER KIT

GENERAL

Kit Number

31798-04

Models

This kit fits 1999 to 2006 Twin Cam models (except 2006 and later Dyna), 1990 to 2006 Evolution 1340 models, 1995 and later XL883 and 1991 and later XL 1200 models. (Does not fit with Vent Hose Cover Kit, Part Number 37961-02.)

NOTE

A Service Manual for your model motorcycle is available from a Harley-Davidson Dealer.

Kit Contents

See Figure 1 and Table 1.

INSTALLATION

▲ WARNING

To prevent accidental vehicle start-up, which could cause death or serious injury, disconnect battery cables (negative (-) cable first) before proceeding. (00307a)

SERVICE PARTS

is01572

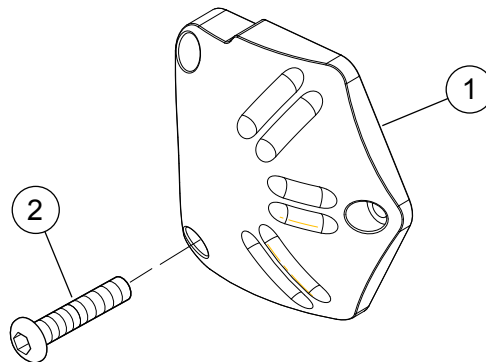

Figure 1. Service Parts: Solenoid Cover

Table 1. Service Parts Table

Item	Description (Quantity)	Part Number
1	Solenoid cover	Not sold separately
2	Screw, M4 - 0.7 x 12mm long with lockpatch (3)	1075M

▲ WARNING

Disconnect negative (-) battery cable first. If positive (+) cable should contact ground with negative (-) cable connected, the resulting sparks can cause a battery explosion, which could result in death or serious injury. (00049a)

1. Disconnect battery cables, negative (-) cable first.
2. Remove screws from solenoid cover plate and discard.
3. Install new solenoid cover plate and screws from kit over the existing cover plate.

▲ WARNING

Connect positive (+) battery cable first. If positive (+) cable should contact ground with negative (-) cable connected, the resulting sparks can cause a battery explosion, which could result in death or serious injury. (00068a)

4. Connect battery cables, positive (+) cable first.