



INSTRUCTIONS

J00876

2009-08-14



SECURITY SYSTEM SMART SIREN KIT

GENERAL

Kit Number

68328-02, 69033-09

Models

For model fitment information, see the P&A retail catalog or the Parts and Accessories section of www.harley-davidson.com (English only).

Additional Parts Required

The motorcycle must be equipped with a Harley-Davidson® Factory Security System before this kit can be installed. See the P&A retail catalog or the Parts and Accessories section of www.harley-davidson.com (English only) for Factory Security Systems and model fitment information.

Tools and Supplies Required

⚠ WARNING

Rider and passenger safety depend upon the correct installation of this kit. Use the appropriate service manual procedures. If the procedure is not within your capabilities or you do not have the correct tools, have a Harley-Davidson dealer perform the installation. Improper installation of this kit could result in death or serious injury. (00333b)

NOTE

Installation for some models refers to service manual information. A service manual for your model motorcycle may be required for this installation and is available from a Harley-Davidson dealer.

Kit Contents

See Figure 21 and Table 1.

PREPARATION

1. Refer to **POWER DISCONNECT** in the owner's manual and follow the instructions to prevent the security module from actuating the siren.

⚠ WARNING

To prevent accidental vehicle start-up, which could cause death or serious injury, disconnect negative (-) battery cable before proceeding. (00048a)

⚠ WARNING

To prevent accidental vehicle start-up, which could cause death or serious injury, remove main fuse before proceeding. (00251b)

2. For ALL models EXCEPT 2002-2003 Touring and 2003-Later Softail: Refer to the owner's manual and follow the instructions to disconnect the battery, negative (-) cable first or remove the main fuse. For 2002-2003 Touring and 2003-Later Softail Models: Remove the seat following the instructions in the service manual and disconnect the battery, negative (-) cable first. Save all seat hardware for installation.

INSTALLATION

2002-2006 VRSCA, VRSCB, VRSCD Models

1. Open the seat.
2. See Figure 1. Remove the splash guard (mud flap) nuts.
3. See Figure 2. Lower the mud flap from the installed position and allow it to rest on the rear tire.

⚠ WARNING

When servicing the fuel system, do not smoke or allow open flame or sparks in the vicinity. Gasoline is extremely flammable and highly explosive, which could result in death or serious injury. (00330a)

4. Remove the fuel cap and the fuel filler boot. Save the boot for installation. Install the fuel cap.

NOTE

See Figure 3. The security siren connector is a three-wire connector, not to be confused with the two-wire connector (3) tied to the harness (except on California models).

5. See Figure 3. Locate the security siren connector (2) at the end of the harness lead that wraps around the top of the fuel tank. Disconnect the fuel pump and sender connector (1) to free the security siren connector. The protective cap and cable strap on the security siren connector can be discarded.
6. See Figure 4. Route the siren harness lead out from under the right side of the fender. Get the siren (1) from the kit and insert connector [142B] (2) into the siren receptacle until the connector latches securely.
7. With the sounder disc (3) facing the mud flap, position the siren on the mud flap as shown in Figure 5. Secure the siren (1) to the existing hook fasteners on the mud flap with the plain-backed loop fastener (2) from the kit.



- Install the mud flap to the underside of the fender. Install and tighten the mud flap nuts to 8–12 N·m (70.8–106.2 in-lbs). Remove the fuel cap. Install the fuel filler boot. Install the fuel cap.

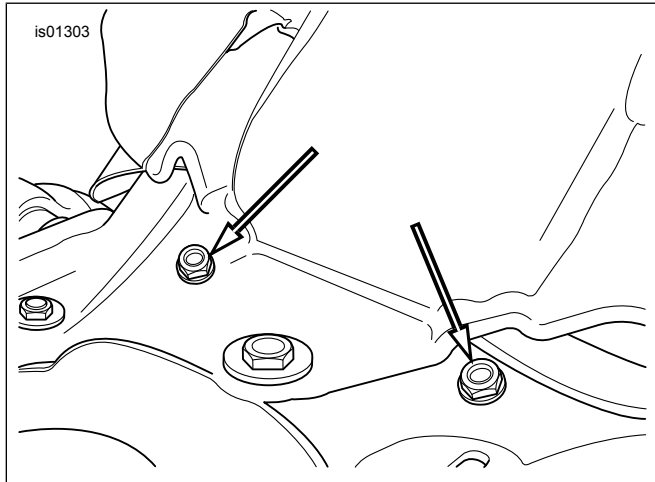

Figure 1. Remove Mud Flap Nuts (2002-2006 VRSCA/B/D)

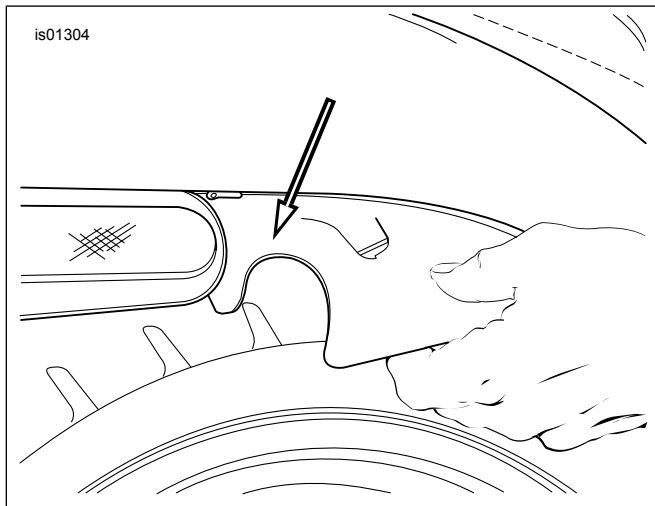

Figure 2. Lower the Mud Flap (2002-2006 VRSCA/B/D)

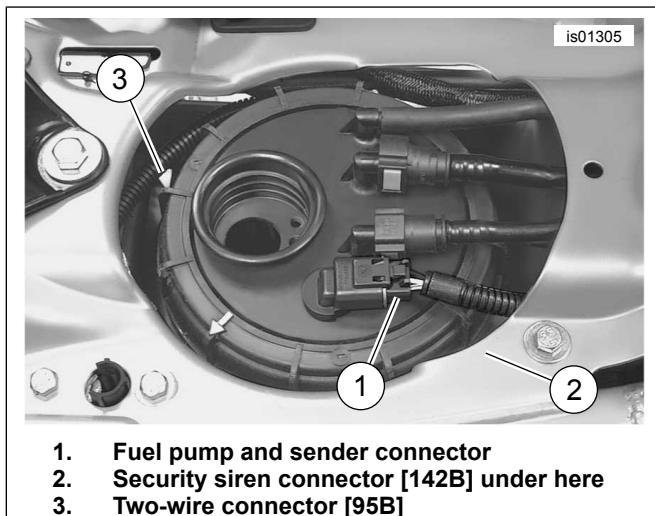

Figure 3. Locate Connector [142B] (All 2002-2006 VRSC Models) (Shown with Fuel Cap and Filler Boot Removed)

NOTICE

When closing the seat, make sure the ignition switch is in the FUEL position. If the ignition switch is in any other position when the seat is closed, the seat latch mechanism could be damaged. (00196a)

- Refer to the owner's manual and follow the instructions to close the seat.

NOTE

Verify that the ignition key switch is in the OFF position before installing the main fuse.

- Install the main fuse following the instructions in the owner's manual.

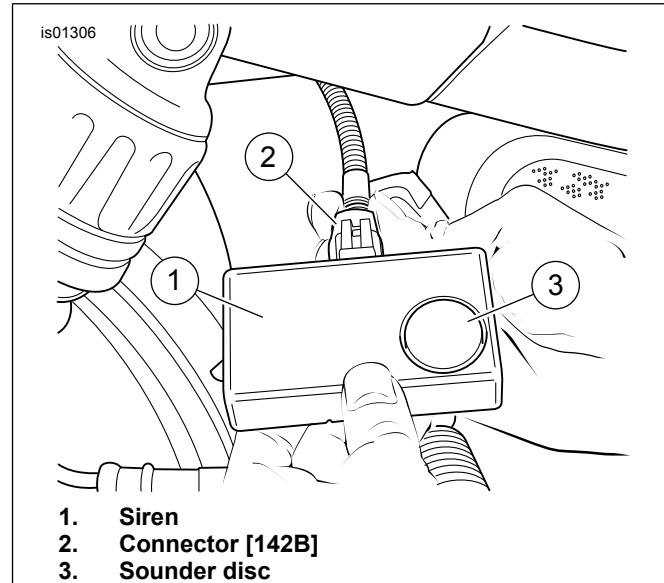

Figure 4. Install Siren Connector (All 2002-2006 VRSC)

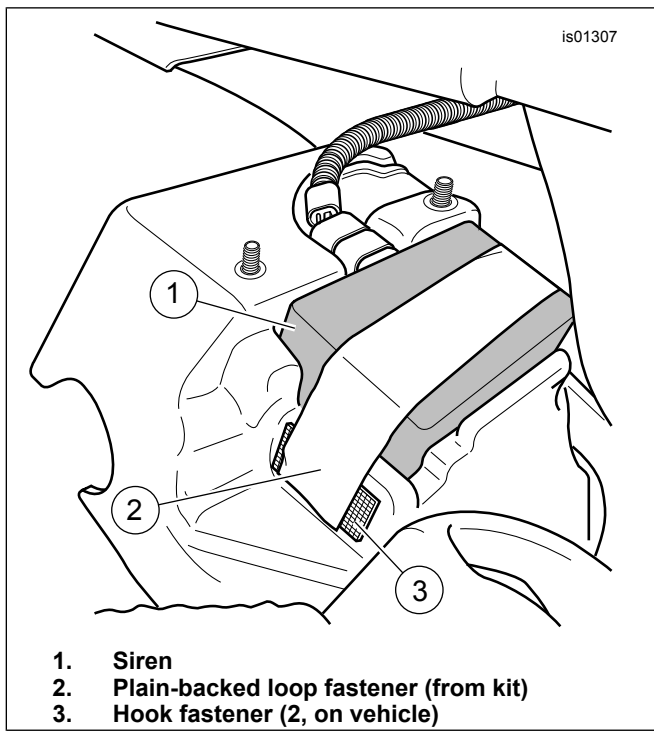

Figure 5. Secure Siren Box (2002-2006 VRSCA/B/D Models)

2006-2007 VRSCR Models

1. Open the seat.

▲ WARNING

When servicing the fuel system, do not smoke or allow open flame or sparks in the vicinity. Gasoline is extremely flammable and highly explosive, which could result in death or serious injury. (00330a)

2. Remove the fuel cap and the fuel filler boot. Install the fuel cap.

NOTE

The security siren connector is a three-wire connector, not to be confused with the two-wire connector (3) tied to the harness (except on California models).

3. See Figure 3. Locate the security siren connector (2), at the end of the harness lead that wraps around the top of the fuel tank. Disconnect the fuel pump and sender connector (1) to free the security siren connector. The protective cap and cable strap on the security siren connector can be discarded.
4. See Figure 6. Remove the flanged hex nut (2) and flat washer (3) that retain the passenger seat (1) and remove the seat.

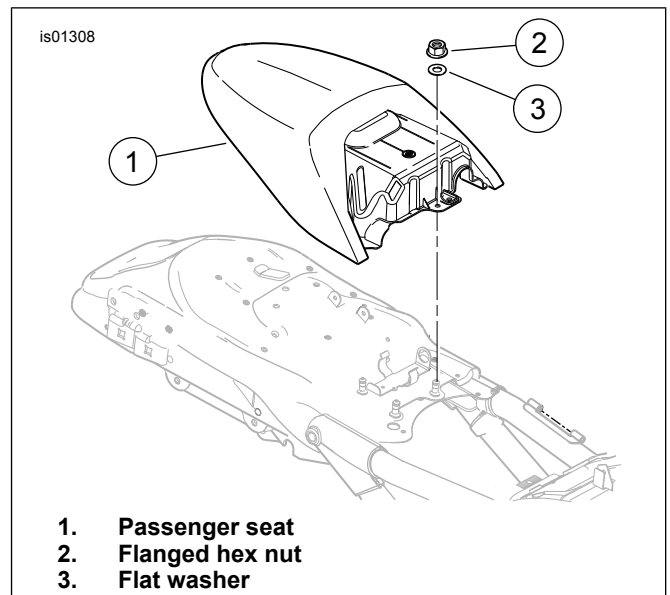

Figure 6. Remove Passenger Seat (2006-2007 VRSCR)

5. See Figure 7. Remove the four hex head screws (2) and spacer washers (3) that retain the rear outer fender (1). Remove the fender by sliding back and lifting up.
6. See Figure 4. Route the siren harness lead out from under the right side of the fender. Get the siren (1) from the kit and insert connector [142B] (2) into the siren receptacle until the connector latches securely.
7. See Figure 8. With the sounder disc (2) facing out, clip the siren (1) onto the mud flap (3) as shown.

NOTE

Verify that the outer fender tabs are latched with the inner fender locking tabs.

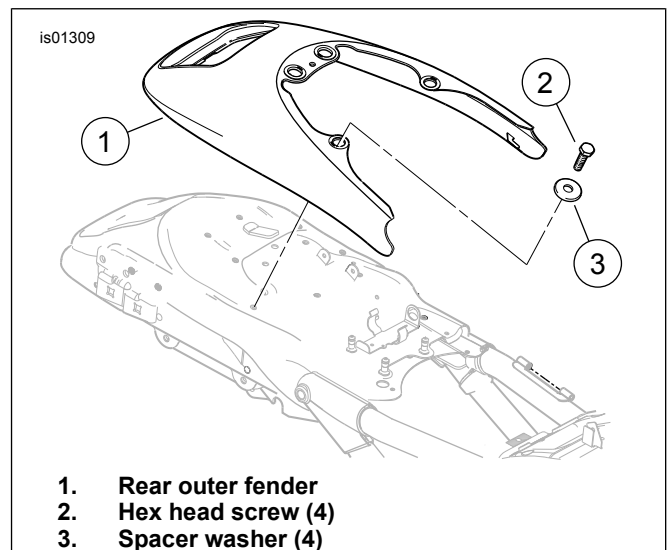
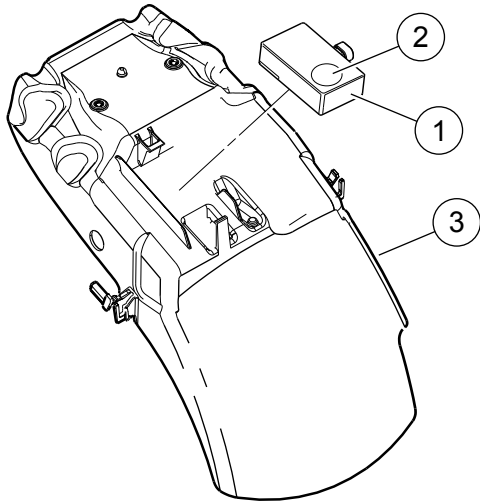

Figure 7. Fender Mounting Fasteners (2006-2007 VRSCR)

is01310



1. Siren
2. Sounder disc
3. Mud flap

Figure 8. Secure Siren Box (2006-2007 VRSCR Models)

8. Install the rear outer fender by sliding the tabs on the front of the fender into the slots on the inner fender locking tabs.
9. Press down gently on the outer fender to seat the fender against the frame.
10. Install the four screws and flat washers that retain the rear outer fender and tighten to 4.5–7.5 N·m (40–66 in-lbs).
11. Install the passenger seat with the flanged hex nut and flat washer removed earlier. Tighten to 20–25 N·m (15–19 ft-lbs).
12. Remove the fuel cap. Install the fuel filler boot. Install the fuel cap.

NOTICE

When closing the seat, make sure the ignition switch is in the FUEL position. If the ignition switch is in any other position when the seat is closed, the seat latch mechanism could be damaged. (00196a)

▲ WARNING

After installing seat, pull upward on seat to be sure it is locked in position. While riding, a loose seat can shift causing loss of control, which could result in death or serious injury. (00070b)

13. Refer to the owner's manual and follow the instructions to close the seat.

NOTE

Verify that the ignition key switch is in the OFF position before installing the main fuse.

14. Install the main fuse per the instructions in the owner's manual.

2007 and Later VRSCA, VRSCD, VRSCF Models

1. Open the seat.
2. Remove the passenger seat (pillion) mounting nut and washer at the left front of the seat. Remove the rider seat retaining post at the right front.
3. Slide the passenger seat forward slightly to detach it from the mounting tab on the fender, then slide it back and out from under the grab strap. Lift the seat away from the motorcycle.

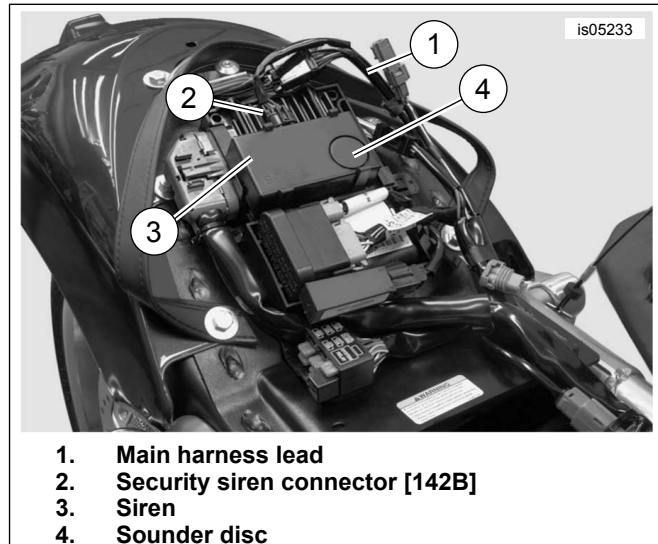

1. Main harness lead
2. Security siren connector [142B]
3. Siren
4. Sounder disc

Figure 9. Secure Siren Box (2007 and Later VRSCA, VRSCD, VRSCF Models)

4. See Figure 9. Locate the three-wire security siren connector [142B] (2), tied back to the harness lead (1) that travels alongside the TSSM mounting caddy. Cut the tape to free the connector and wires.
5. Insert siren connector [142B] into the siren receptacle until the connector latches securely.
6. With the sounder disc (4) facing out, clip the siren onto the TSSM mounting caddy as shown.
7. If necessary, secure the connector wiring to the existing wiring with a cable strap (not provided).
8. Slide the passenger seat under the grab strap, and engage the mounting tab on the fender into the slot in the underside of the seat. Make sure harnesses are not pinched under the passenger seat frame.

▲ WARNING

After installing seat, pull upward on seat to be sure it is locked in position. While riding, a loose seat can shift causing loss of control, which could result in death or serious injury. (00070b)

- Fasten the passenger seat with the rider seat retaining post at the right front, and the seat mounting nut and washer at the left front. Tighten the nuts to 11–17 N·m (97–150 in-lbs).

NOTE

Verify that the ignition key switch is in the OFF position before installing the main fuse.

- Install the main fuse.

2002-2007 FL Touring Models

- Remove the right side saddlebag per the instructions in the owner's manual. Gently pull the side cover from the frame downtubes.
- See Figure 10. Remove the two flange nuts (2) from the electrical bracket (1). Pull the bracket assembly, with the electronic control module (ECM) and connector attached, away from the side of the battery box.

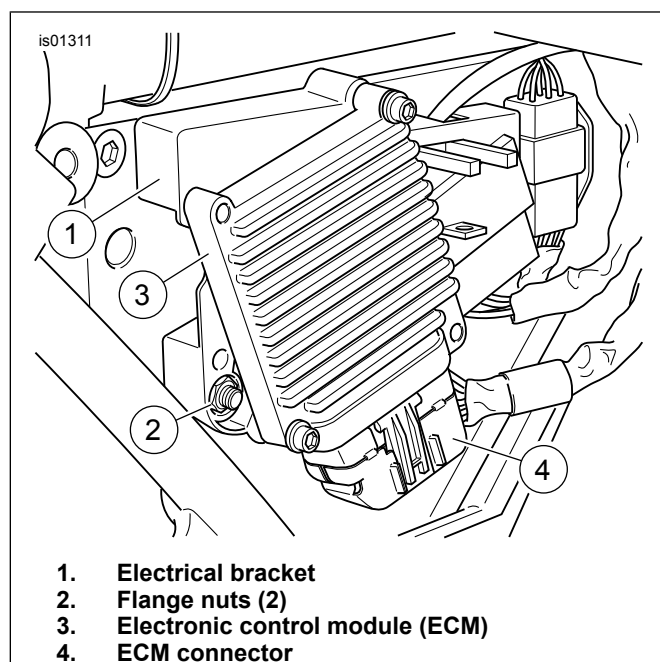

Figure 10. Electrical Bracket (2002-2007 FL Touring Models)

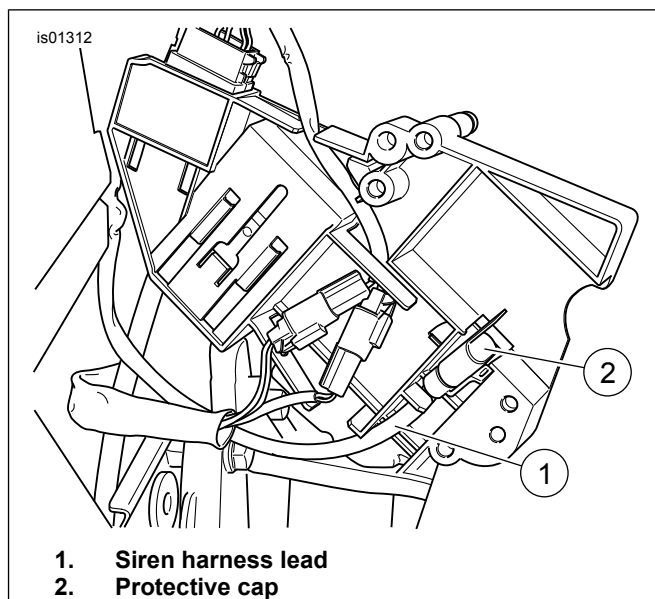

Figure 11. Siren Wire Harness (2002-2007 FL Touring)

- Refer to Figure 11. Remove the siren harness lead (1) from the back of the electrical bracket, and take the protective cap (2) off of the security siren connector [142B].
- See Figure 12. Insert the security siren connector [142B] (2) into the siren box receptacle until the connector latches securely.
- Refer to Figure 13. Slide the siren (2) into place on the back of the electrical bracket (1) so the sounder disc faces out.

NOTE

Be sure that the cables and conduit are properly routed so they are not pinched during assembly.

- See Figure 14. Install the electrical bracket assembly with the siren back onto the studs on the side of the battery box. Install the two flange nuts onto the studs and tighten to 4.1–5.4 N·m (36–48 in-lbs).

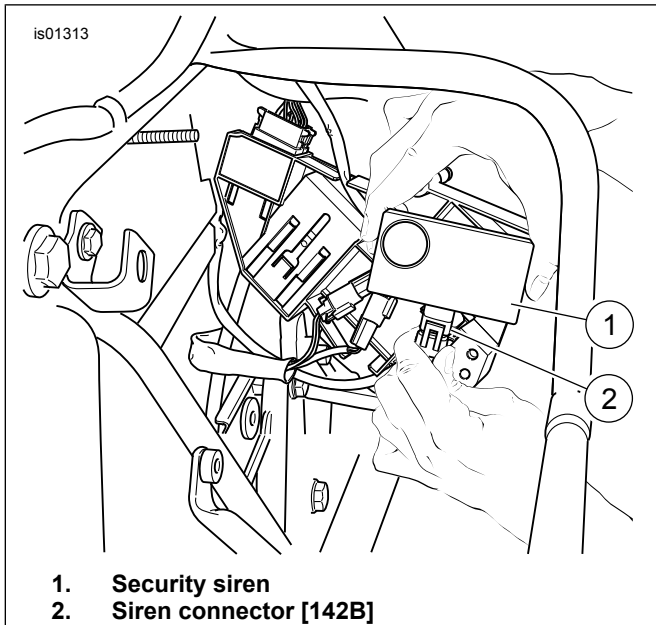

Figure 12. Insert Siren Connector (2002-2007 FL Touring)

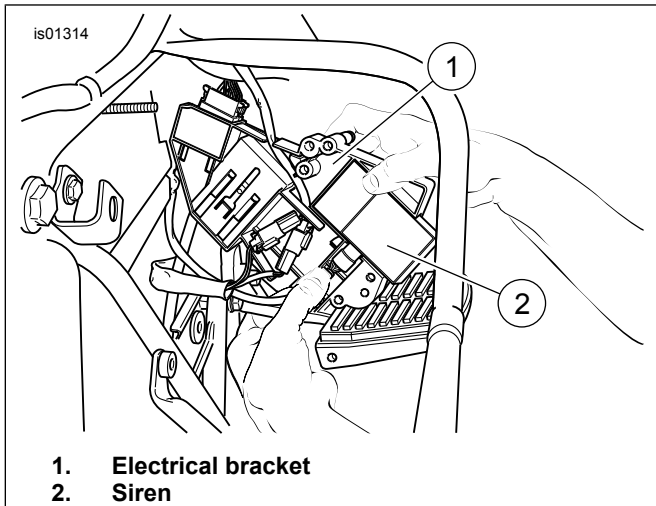

Figure 13. Slide Siren into Place (2002-2007 FL Touring)

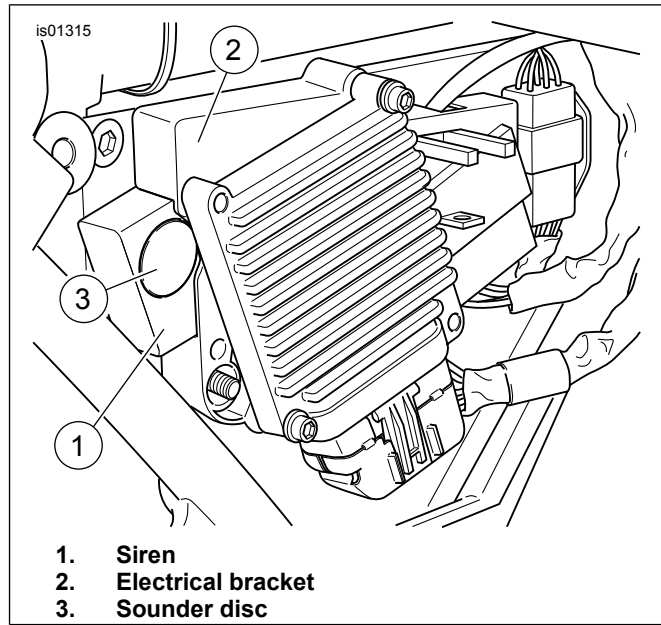

Figure 14. Siren and Electrical Bracket Installed (2002-2007 FL Touring Models)

7. Align the barbed studs on the side cover with the grommets in the frame and push side cover firmly into place.
8. Install the right side saddlebag per the instructions in the owner's manual.

NOTE

Verify that the ignition key switch is in the OFF position **before** installing the main fuse or attaching the battery cables.

9. **For 2004-2007 models:** Refer to the owner's manual and follow the instructions to install the main fuse. **For 2002-2003 models:** Apply a light coat of Harley-Davidson electrical contact lubricant (H-D Part No. 99861-02), petroleum jelly or corrosion retardant material to the negative battery terminal. Refer to the owner's manual and follow the instructions to attach the negative battery cable.

▲ WARNING

After installing seat, pull upward on seat to be sure it is locked in position. While riding, a loose seat can shift causing loss of control, which could result in death or serious injury. (00070b)

10. Refer to the owner's manual, and follow instructions to install the seat.

2008 and later FL Touring and Trike Models

1. Follow the instructions in the owner's manual to remove the left side saddlebag. Gently pull the side cover from the frame downtubes.
2. See Figure 15. Remove the security siren connector [142B] (3) from the retainer on the electrical caddy. Insert security siren connector [142B] into the security siren receptacle (5) until the connector latches securely.

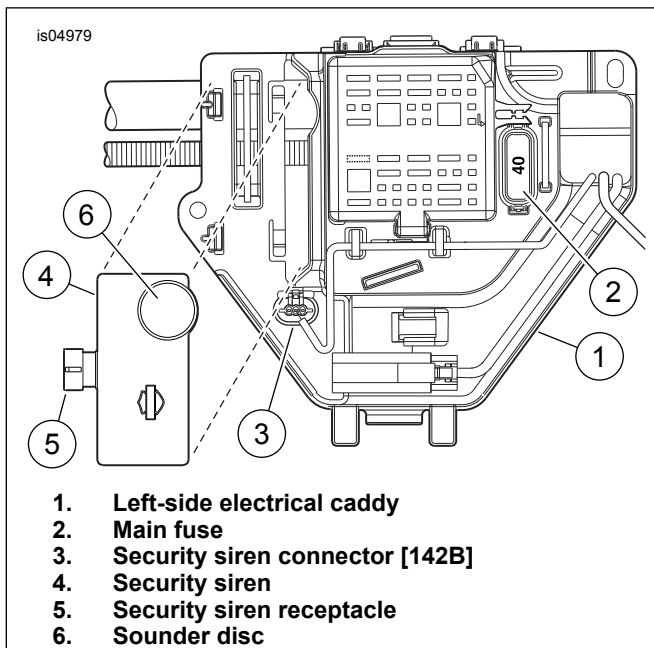

Figure 15. Siren Installation (2008 and Later FL Touring)

- Slide the siren into place on the left side of the electrical caddy so the sounder disc (6) faces out.

NOTE

Verify that the ignition key switch is in the OFF position **before** installing the main fuse.

- Refer to the owner's manual and follow the instructions to install the main fuse.
- Align the barbed studs on the side cover with the grommets in the frame and push the side cover firmly into place.
- Install the left side saddlebag per the instructions in the owner's manual.

2003 and later Softail Models EXCEPT FXCW/C

- Remove the right side saddlebag (if equipped) per the instructions in the owner's manual.

NOTE

The siren connector is installed on an electrical panel under the rear fender on all Softail models. The rear of the motorcycle may have to be raised slightly to allow removal of the splash guard.

- Remove the two bolts at the bottom of the splash guard. Bend the upper right corner of the splash guard toward the rear tire and lift up to unhook the splash guard from the tab on the rear fork. Remove the guard from beneath the fender.

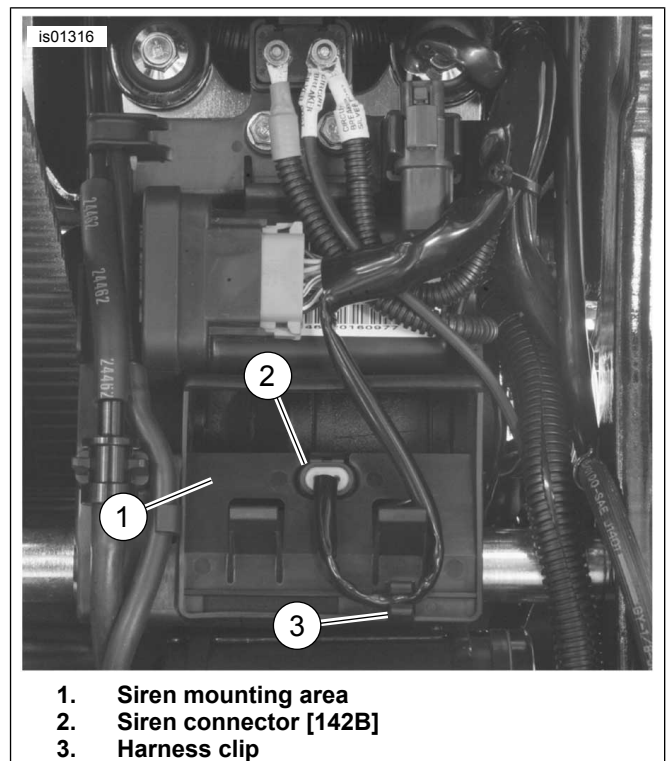

Figure 16. Siren Connector (Softail Models EXCEPT FXCW/C) (Rear Fender View with Rear Wheel Removed)

- See Figure 16. Remove the siren connector [142B] (2) from the receptacle in the siren mounting area (1) of the electrical panel.
- Insert the siren connector [142B] into the siren box receptacle until the connector latches securely.
- See Figure 17. Orient the siren (1) as shown, with the harness connector (2) toward the bottom and the sounder disc (5) facing out. Carefully snap the siren into the electrical panel.
- Insert the siren harness lead (4) into the harness clip (3) to keep the harness clear of other components.
- If necessary, secure the connector wiring to the electrical panel wiring with a cable strap (not provided).
- Hook the slot at the top of the splash guard over the tab on the rear fork and install the guard with the two screws removed earlier. Tighten securely.
- Install the right side saddlebag (if equipped) per the instructions in the owner's manual.

NOTE

Verify that the ignition key switch is in the OFF position **before** attaching the negative battery cable.

- Apply a light coat of Harley-Davidson electrical contact lubricant (H-D Part No. 99861-02), petroleum jelly or corrosion retardant material to the negative battery terminal. Refer to the owner's manual and follow the instructions to connect the negative battery cable.

▲ WARNING

After installing seat, pull upward on seat to be sure it is locked in position. While riding, a loose seat can shift causing loss of control, which could result in death or serious injury. (00070b)

11. Refer to the owner's manual and follow the instructions to install the seat.

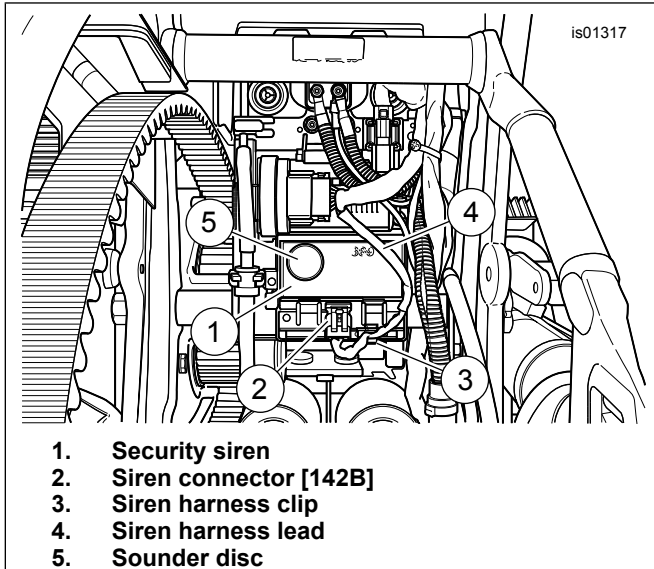

Figure 17. Siren Mounting (Softtail Models EXCEPT FXCW/C)

2008 and later FXCW/C (Rocker) Models

NOTE

Note the fender wire routing and hardware locations before removal.

1. Remove the rear fender from the vehicle. Refer to the service manual and follow the instructions to:
 - a. Disconnect the rear wiring harness connector [7] halves.
 - b. Remove the lower fender mounting bolts and washers.
 - c. Remove the upper fender mounting screws and washers.
 - d. Remove the fender.
2. See Figure 18. Unfasten the harness (1) clipped to the right side of the electrical compartment cover (splash guard, already removed in photo) just forward of the rear wheel. Remove the two hex socket head screws with washers fastening the cover and remove the cover from the vehicle.

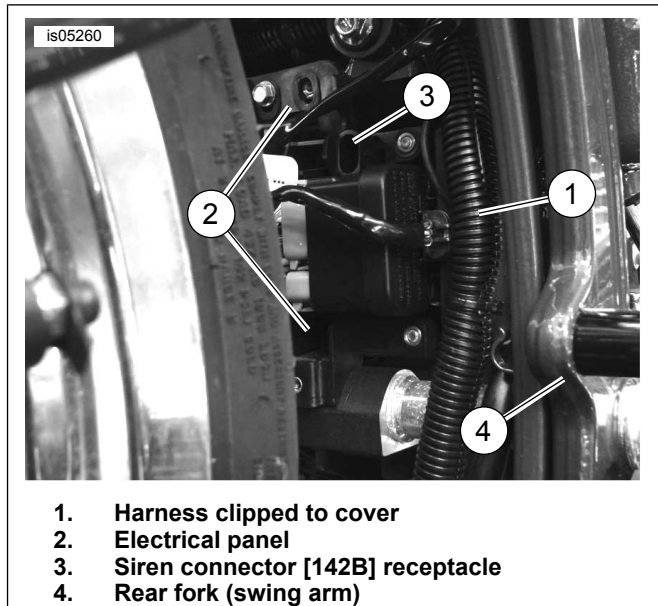

Figure 18. Electrical Panel (FXCW/C Models)

3. Remove the siren connector [142B] from the receptacle (3) near the top of the electrical panel (2).
4. Insert siren connector [142B] into the siren box receptacle until the connector latches securely.
5. See Figure 19. Position the siren box (1) with the harness connector toward the rear and the sounder disc (2) facing out. Carefully snap the siren box into the pocket (3) on the right side of the electrical panel.
6. Install the electrical compartment cover. Install the screws and washers. Tighten the screws to 4.1–6.8 N-m (36–60 in-lbs).

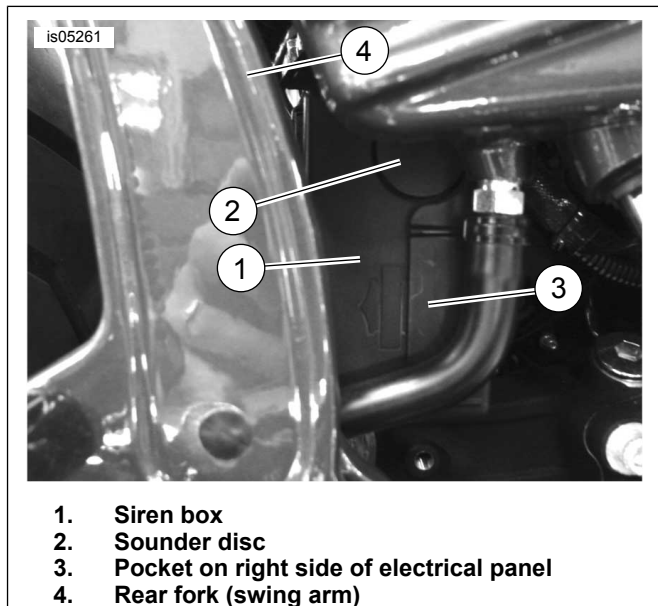

Figure 19. Siren Mounting (FXCW/C Models)

7. Refer to the service manual and follow the instructions to:
 - a. Set the fender into position.

- b. Loosely install the fender mounting hardware.
- c. Tighten the fender mounting hardware, in the indicated sequence, to the specified torque.
- d. Connect the rear wiring harness connector [7] halves.

NOTE

Verify that the ignition key switch is in the OFF position **before** attaching the negative battery cable.

8. Apply a light coat of Harley-Davidson electrical contact lubricant (H-D Part No. 99861-02), petroleum jelly or corrosion retardant material to the negative battery terminal. Refer to the service manual and follow the instructions to connect the negative battery cable.

▲ WARNING

After installing seat, pull upward on seat to be sure it is locked in position. While riding, a loose seat can shift causing loss of control, which could result in death or serious injury. (00070b)

9. Refer to the service manual and follow the instructions to install the seat.

2004 and later Dyna Models

1. See Figure 20. Firmly grasp both sides of the electrical caddy cover (1) and pull out to remove.
2. Remove the front electrical caddy screw and washer (2). Remove the two top electrical caddy screws and washers (7).

NOTE

When pulling the electrical caddy away from the motorcycle, make sure that the wiring connections are not disturbed. Pull the caddy away just far enough to allow installing the siren.

3. Get the siren (5) from the kit. Tip the top of the electrical caddy (3) away from the vehicle slightly. Turn the siren so the sounder disc (6) faces up and the wire receptacle is facing the motorcycle as shown.
4. Remove the siren harness lead from behind the electrical caddy and remove the black dust cap from the security siren connector [142B].
5. Insert connector [142B] into the siren receptacle until the connector latches securely. Insert the siren into the back of the caddy, beneath the ignition control module (4).
6. Install, but do not tighten, the front electrical caddy screw and washer (2). Install the top electrical caddy screws and washers (7). Tighten the top screws to 11.3 N·m (100 in-lbs). Tighten the front screw to 5.6 N·m (50 in-lbs).

NOTE

Verify that the ignition key switch is in the OFF position **before** installing the main fuse.

7. Refer to the owner's manual and follow the instructions to install the main fuse.
8. Install the electrical caddy cover.

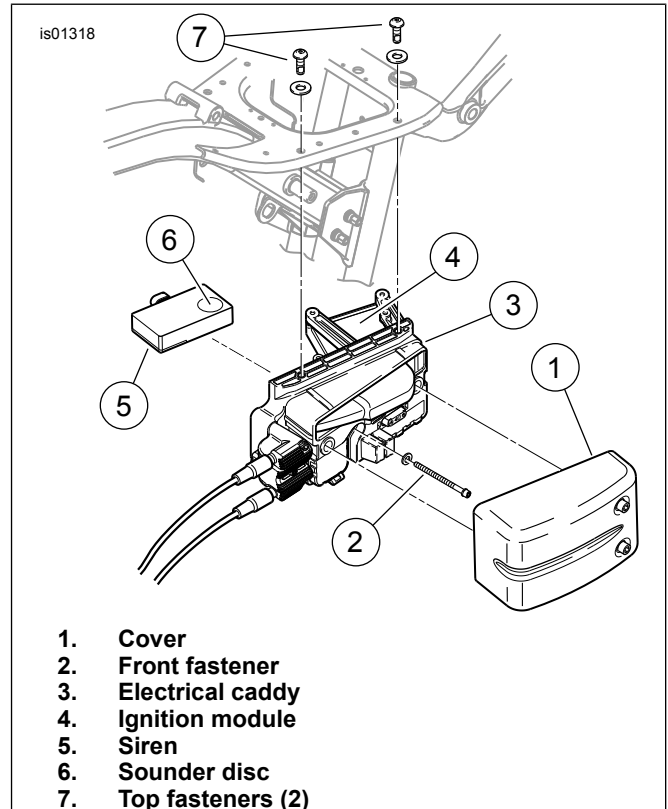

Figure 20. Install Siren in Electrical Caddy (Dyna Models)

ALL Models

NOTE

The siren may not function properly when first installed. Nickel metal hydride (NiMH) rechargeable batteries discharge fairly rapidly when stored. They will lose as much as 1%-2% of their charge per day, and after a few months of storage at room temperature will be mostly discharged. If stored for a very long period without charging, they may need a few charging cycles to regain their full capacity.

To charge the NiMH battery, operate the motorcycle for a minimum of four hours.

SIREN DIAGNOSTICS

- If the siren is armed and the internal siren battery is dead, shorted, disconnected, or has been charging for a period longer than 24 hours, the siren will respond with three chirps on arming instead of two.
- The internal siren battery may not charge if the vehicle's charging system is producing less than 12.5 volts.
- If the siren does not chirp two or three times on a valid arming command from the security system, the siren is either in chirpless mode, not connected, not working, or the siren wiring was opened or shorted while the siren was disarmed.

- If the siren enters the self-driven mode where it is powered from the siren's internal 9 volt battery, the turn signal lamps may or may not alternately flash. If the security system activates the siren, the turn signal lamps will alternately flash. If the siren has been armed and a security event occurs, and the siren is in self-driven mode, the siren will alarm for 20-30 seconds and then turn off for 5-10 seconds. This alarm cycle will be repeated ten times if the siren is in the self-driven mode.

SMART SIREN BATTERY REPLACEMENT

The siren's internal 9-volt battery is rechargeable and does not need to be replaced on a regular basis. Battery life under normal conditions is approximately three to six years.

NOTE

When battery replacement is needed, only a **nickel metal hydride (NiMH) 9 volt battery** should be used in the siren. These are widely available at local battery outlets.

To Replace the Battery:

1. Refer to **POWER DISCONNECT** in the owner's manual and follow the instructions to prevent the security module from actuating the siren.
2. Remove the siren box from the vehicle. Refer to the siren installation procedures for your model in this instruction sheet.
3. Open the battery cover by inserting a flat-blade screwdriver into one of the slots on the side of the siren box. Press until one corner of the cover pops up slightly.
4. Insert the screwdriver into the second slot, and press until the cover pops open. Remove the cover and gasket.
5. Remove the old battery from the siren box, and gently unfasten the snap connector from the battery. Save the grease coating the terminals.
6. Coat the terminals of the snap connector and the **new** NiMH nine-volt battery completely with the grease from the old connection.

NOTE

If not enough lubricant remains to completely cover the terminals, *Electrical Contact Lubricant (H-D Part No. 99861-02)* is compatible, and is available from a Harley-Davidson dealer

7. Snap the connector onto the new battery, and install the battery into the siren box.
8. Set the siren box on a work surface with the battery opening facing up. Position the gasket and battery cover onto the siren box with the rounded corners facing out.
9. Press the cover down onto the siren box and press the tabs in with the screwdriver until the tabs snap into the slots in the box.
10. Install the siren box into the vehicle.
11. Dispose of the old NiMH battery in accordance with local regulations.

SERVICE PARTS

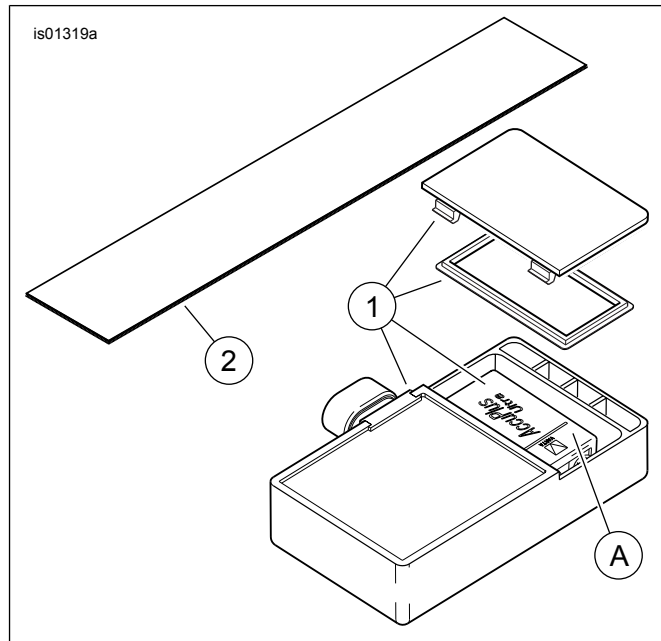

Figure 21. Service Parts, Smart Siren Kit

Table 1. Service Parts

Item	Description (Quantity)	Part Number
1	Smart Siren, security system	68958-07C
2	Loop fastener, plain-backed, 210 mm x 38 mm (8-1/4 in x 1-1/2 in) - Used for 2002-2006 VRSCA/B/D models only	59274-01
Item mentioned in text, but not included in kit.		
A	Battery, 9 volt NiMH (purchase locally)	