



INSTRUCTIONS

J02820

2013-11-01



CHROME IGNITION SWITCH COVER

GENERAL

Kit Number

71527-04

Models

For model fitment information, see the P&A retail catalog or the Parts and Accessories section of www.harley-davidson.com (English only).

NOTE

There are no Service Parts available with this kit.

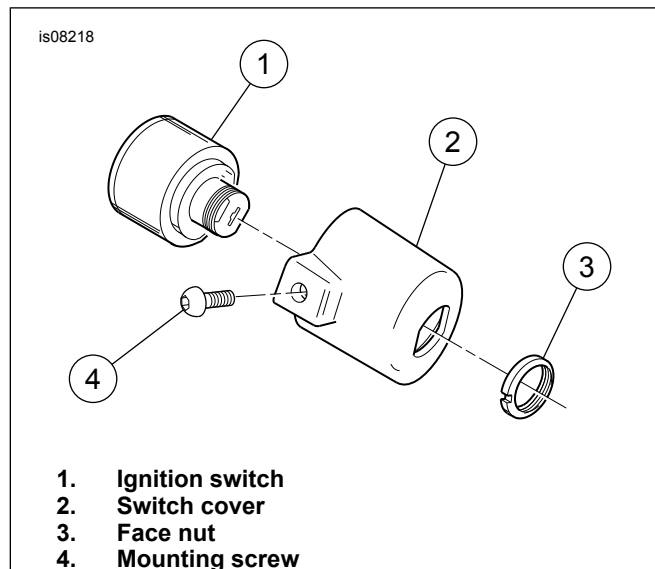

Figure 1. Ignition Switch Cover Installation

INSTALLATION

1. See Figure 1. Remove the ignition switch face nut (3).

NOTE

To avoid damaging the fuel tank finish, lift the front of the tank to provide clearance for removing and installing the screw.

2. Remove the front mounting bolt on the fuel tank.
3. Remove the ignition cover mounting screw, then remove and discard the original ignition switch cover.
4. Place the chrome ignition switch cover in position, and install the original mounting screw. Tighten the screw to 3-7 ft-lbs (4-9 Nm).
5. Install the front fuel-tank mounting bolt. Tighten the bolt to 8-16 ft-lbs (11-22 Nm).
6. Install the face nut to secure the switch to the cover, and tighten securely.