



INSTRUCTIONS

J00884

2006-05-19



PASSENGER FOOTPEG MOUNTING KIT

GENERAL

Kit Number

50198-97B

Models

This kit fits 1993 and later FLT, FLHT, FLHS, and FLHR model motorcycles.

Kit Contents

See Figure 1 and Table 1.

INSTALLATION

1. On each side of the motorcycle, remove the socket head capscREW and lockwasher that attaches each footpeg support (A) and footpeg to motorcycle. Remove both footpeg supports along with their footpegs.

2. See Figure 1. Place the right (2) and left (3) footpeg support in position (the supports can be installed in one of two different height positions to suit passenger preference) and securely fasten to motorcycle with lockwasher and capscREW removed in Step 1.
3. Install footpegs (sold separately) on each footpeg support using capscREWS (1), spring washers (4), and locknuts (5). The spring washer goes between the jaws of the footpeg supports along with the mounting end of the footpeg. Tighten hardware securely.

NOTE

Footpegs must fold up at a 45° angle (from vertical) toward rear of motorcycle. This angle allows footpegs to fold up if they accidentally strike the ground when making a sharp turn. Failure to install footpegs with the proper fold-up angle could result in death or serious injury.

SERVICE PARTS

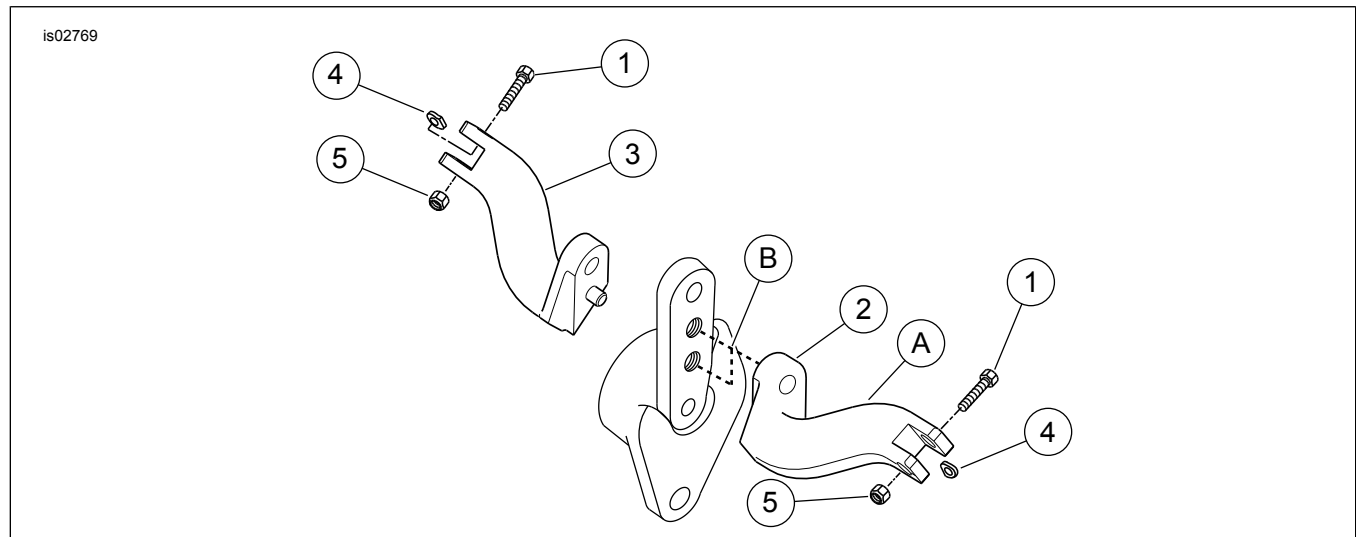

Figure 1. Service Parts: Passenger Footpeg Mounting Kit

Table 1. Service Parts Table

Item	Description (Quantity)	Part Number
1	Capscrew, hex head (2)	4721
2	Passenger footpeg support (right)	49025-97A
3	Passenger footpeg support (left)	49026-97A
4	Spring washer (2)	50912-72
5	Locknut (2)	7778
Items mentioned in text, but not included in kit:		
A	Footpeg support	
B	Optional upper and lower footpeg support holes	