



# INSTRUCTIONS

J02099

2006-04-09



## NEUTRAL SWITCH COVER KIT

### GENERAL

#### Kit Number

33919-00

#### Models

This kit is designed to fit 1998-2005 Dyna® and 1998 to 2006 Touring model motorcycles.

#### Kit Contents

See Figure 1.

#### NOTE

There are no serviceable parts in this kit. Chrome buttonhead screw Harley-Davidson Part No. 94378-92T can be used as a replacement for the chrome-plated stainless steel 8-32 x .50 buttonhead screw provided in this kit.

### INSTALLATION

#### ⚠ WARNING

To prevent accidental vehicle start-up, which could cause death or serious injury, disconnect negative (-) battery cable before proceeding. (00048a)

#### ⚠ WARNING

Disconnect negative (-) battery cable first. If positive (+) cable should contact ground with negative (-) cable connected, the resulting sparks can cause a battery explosion, which could result in death or serious injury. (00049a)

1. Disconnect the battery cables, negative cable first.
2. Unplug neutral switch wires from the switch.
3. See Figure 1. Loosely start the set screws (5) into the mounting bracket (2).
4. Install the mounting bracket (2) over the switch hex. Bracket surface should rest against the transmission top cover with threaded holes facing up toward the rear cylinder.
5. Alternately tighten the set screws (5) against the switch hex using the wrench (6) provided in kit.
6. Plug in the switch wires.
7. Install the cover (1) over the mounting bracket (2) using the washer (3) the 8-32 buttonhead screw (4) and the wrench (6) provided. Do not pinch wires.
8. Reconnect the battery cables, positive cable first.

#### ⚠ WARNING

Connect positive (+) battery cable first. If positive (+) cable should contact ground with negative (-) cable connected, the resulting sparks can cause a battery explosion, which could result in death or serious injury. (00068a)

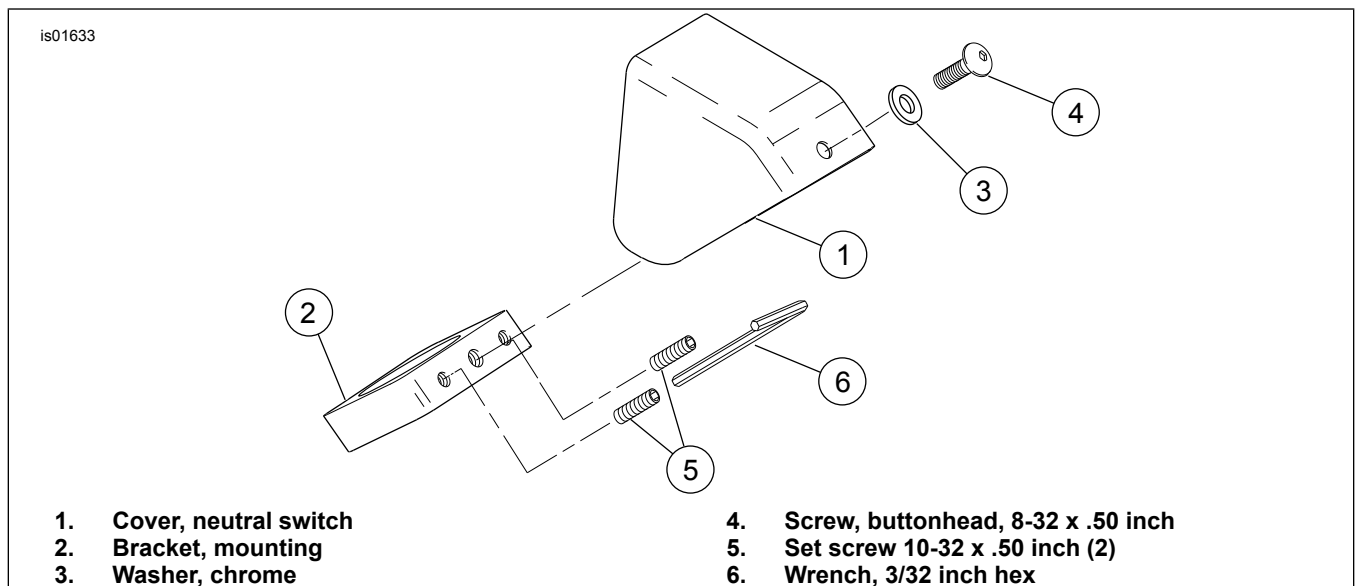

Figure 1. Neutral Switch Cover Assembly