



INSTRUCTIONS

J02132

2007-08-02



ENGINE GUARD FOOTPEG CHROME HARDWARE KIT

GENERAL

Kit Number

94140-02

Models

For model fitment information, please see the P&A Retail Catalog or the Parts and Accessories section of www.harley-davidson.com (English only).

Kit Contents

Table 1. Service Parts

Item	Description (Quantity)	Part Number
1	Locknut w/nylon insert, chrome (2)	94030-92T
2	Screw 3/8-16x1-1/2 inch, chrome	Not Sold Separately
3	Lockwashers, chrome (2)	94083-94T
4	Screw, 1/2-20x5/8 inch, chrome	Not Sold Separately
Items mentioned in text, but not included in kit.		
A	Spring washer	

NOTE

Substitute mounting hardware in kit Part Number 50964-98 with the chrome mounting hardware from this kit (Substitute Part for Part). Discard original hardware.

⚠ WARNING

Position footpegs so rider can operate foot controls without interference. Failure to have full access to foot controls can cause loss of control, which could result in death or serious injury. (00313a)

⚠ WARNING

If footpeg mounting location increases motorcycle width, maintain clearance between motorcycle and surrounding persons or objects. Failure to maintain clearance could result in death or serious injury. (00314a)

INSTALLATION

1. Remove the small buttonhead screws that hold the 3-piece clamp together. Place clamp around engine guard and reinstall the buttonhead screws.
2. See Figure 1. Pull the 3-piece clamp tabs together with a clamp, or clamping pliers, and install the 1/2 inch diameter screw (4), lockwasher (3), and footpeg mount as shown. Tighten screw securely.

3. Install the footpegs (purchased separately) using the 3/8 inch diameter screws (2), spring washers (A) and locknuts (1) included in kit. Make sure the spring washer (saved from original hardware kit Part Number 50964-98) is positioned inside the footpeg mount with the square edge towards the inside of the mount. Tighten locknuts to 26 N-m (19 ft-lbs).

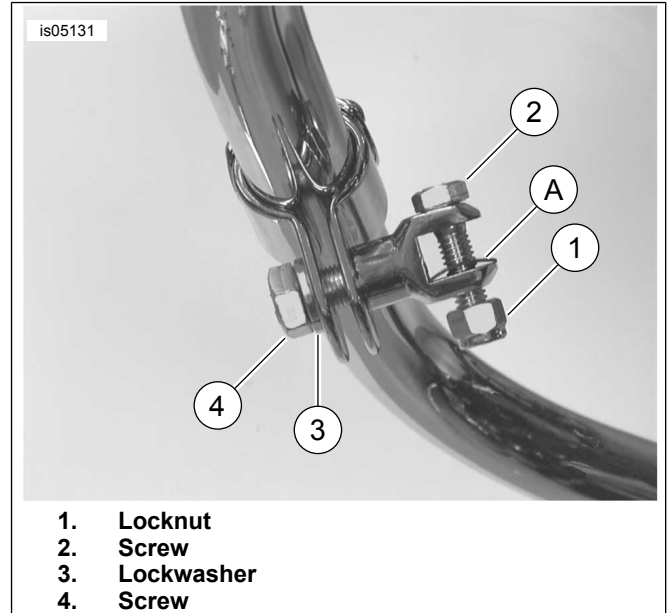

Figure 1. Installing Mounting Hardware (footpeg not shown)