



INSTRUCTIONS

J01615

2007-11-20



HEX SPACER KIT

GENERAL

Kit Number

49352-00

Models

For model fitment information, please see the P&A Retail Catalog or the Parts and Accessories section of www.harley-davidson.com (English only).

Kit Contents

Table 1. Kit Contents

Description (Quantity)	Part Number
Extension, footpeg, passenger	Not Sold Separately
Socket head cap screw	4201
Socket head cap screw	4310
Washer	6379W

For model fitment information, please see the P&A Retail Catalog or the Parts and Accessories section of www.harley-davidson.com (English only).

Additional Parts Required

This kit is required if a Toolbox Kit, Part Number 64937-00, 64938-00 or 64219-96 is being installed using passenger footpegs.

⚠ WARNING

Rider and passenger safety depend upon the correct installation of this kit. Use the appropriate service manual procedures. If the procedure is not within your capabilities or you do not have the correct tools, have a Harley-Davidson dealer perform the installation. Improper installation of this kit could result in death or serious injury. (00333b)

NOTE

This instruction sheet references Service Manual information. A Service Manual for your model motorcycle is required for this installation and is available from a Harley-Davidson Dealer.

INSTALLATION

⚠ WARNING

To prevent accidental vehicle start-up, which could cause death or serious injury, disconnect negative (-) battery cable before proceeding. (00048a)

1. Disconnect negative (-) battery cable.
2. Refer to the applicable Service Manual and remove footpeg and hardware from vehicle frame.

3. See Figure 1. From the inboard side of the vehicle, install 3/8-16 x 1-3/4 in. bolt (1) and washer (2) (use 3/8-16 x 2-1/4 in. bolt if dresser bars are installed) through the hole in the dresser bar bottom flange (if present), saddlebag relocation bracket (if present) and into the vehicle frame member (3). Tighten bolt to 35-45 ft. lbs. (47.8-61.0 Nm).
4. Install passenger footpeg extension (4) to the end of the bolt. Tighten extension to 35-45 ft. lbs. (47.8-61.0 Nm).
5. Install passenger footpeg support with 3/8-16 x 1-3/4 in. hex socket head bolt (5), or original equipment hex socket head bolt, to end of footpeg extension. Tighten bolt to 35-45 ft. lbs. (47.8-61.0 Nm).

⚠ WARNING

Footrests must fold up and toward rear of motorcycle if struck. Failure to set footrests to fold up and back could result in death or serious injury. (00366a)

6. Install footpeg as described in the applicable Service Manual.
7. If applicable, attach the loose end of the saddlebag relocation bracket to the lower leg of the saddlebag support with the fasteners from the relocation bracket kit.
8. Continue installation as outlined in the Toolbox Assembly Kit assembly instructions.
9. Connect negative (-) cable to the battery.
10. Discard remaining original and kit mounting hardware.

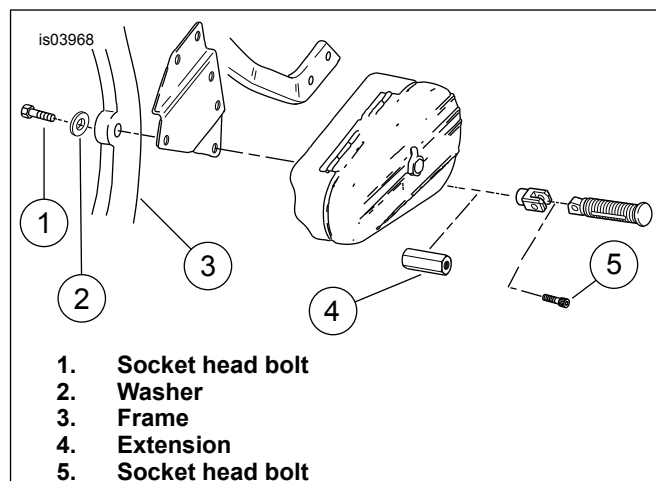

Figure 1. Hex Spacer Kit

