



# INSTRUCTIONS

J01173

2003-03-06



## ENGINE-GUARD FOOTPEG MOUNTING KIT

### GENERAL

#### Kit Number

50964-98

#### Models

These footpeg mountings fit all H-D 1-1/4 in. diameter front engine guards except VRSC models.

#### Kit Contents

Table 1. Kit Contents

Description (Quantity)	Part Number
Three-piece clamp (2)	50903-85T
Large diameter screw (2)	2348
Lockwasher (2)	7068
Footpeg support kit consisting of:	50900-72TA
Footpeg mount (2)	Not Sold Separately
Small diameter screw (2)	Not Sold Separately
Spring washer (2)	50912-72
Lock nut (2)	Not Sold Separately

### INSTALLATION

#### ⚠ WARNING

Position footpegs so rider can operate foot controls without interference. Failure to have full access to foot controls can cause loss of control, which could result in death or serious injury. (00313a)

1. Remove the four small buttonhead screws that hold the 3-piece clamp (1) together. Place the clamp around the engine guard, positioning the clamp on the straight, upright section of the guard. Re-install the buttonhead screws and torque to 1 N·m (9 in-lbs).
2. See Figure 1. Pull the 3-piece clamp tabs together with a clamp, or clamping pliers, and install the large diameter screw (2), lockwasher (3), and footpeg mount (5) as shown. Hand-tighten the screw at this time. Repeat for the opposite footpeg mount.

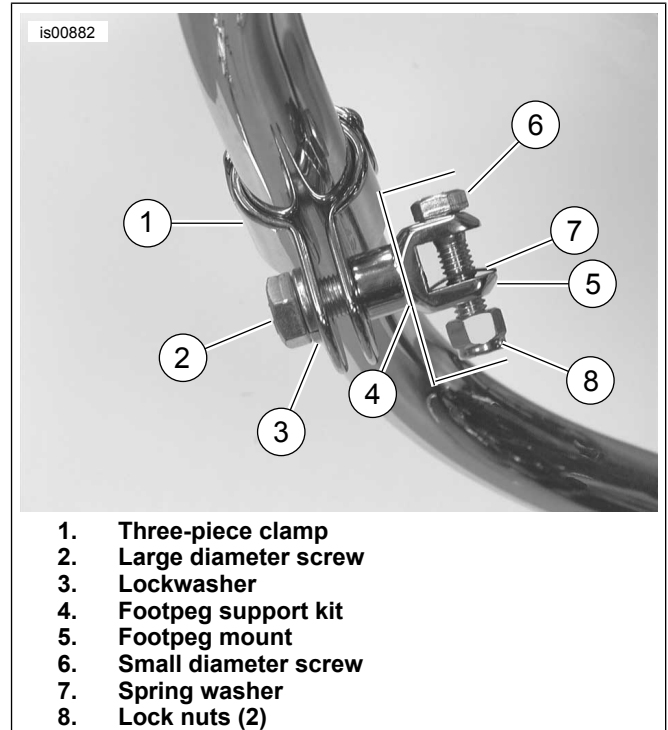

Figure 1. Footpeg Mounting Kit Installation (Footpeg Not Shown)

#### ⚠ WARNING

Footrests must fold up and toward rear of motorcycle if struck. Failure to set footrests to fold up and back could result in death or serious injury. (00366a)

3. Install the footpegs (purchased separately) using the small diameter screws (6), spring washers (7) and locknuts (8) included in this kit. Make sure the spring washer is positioned inside the footpeg mount with the square edge towards the inside of the mount. Hand tighten the locknuts at this time.
4. Rotate the footpegs so they fold upward and to the rear, then torque the screws (2) to 64 N·m (47 ft-lbs).
5. Torque the locknuts (8) to 26 N·m (19 ft-lbs).

### IN USE

#### ⚠ WARNING

If footpeg mounting location increases motorcycle width, maintain clearance between motorcycle and surrounding persons or objects. Failure to maintain clearance could result in death or serious injury. (00314a)