



INSTRUCTIONS

J03525

2010-01-15



FLHRC SADDLEBAG LOCK SET KIT

GENERAL

Kit Number

46316-04

Models

For model fitment information, see the P&A Retail Catalog or the Parts and Accessories section of www.harley-davidson.com (English only).

NOTE

The lock can be keyed to match the motorcycle's ignition key. Specify the key code when ordering the lock.

Kit Contents

See Figure 2 and Table 1.

⚠ WARNING

Rider and passenger safety depend upon the correct installation of this kit. If the procedure is not within your capabilities or you do not have the correct tools, have a Harley-Davidson dealer perform the installation. Improper installation of this kit could result in death or serious injury. (00308b)

INSTALLATION

Install FLHRS Lock Set Kit

1. See Figure 2. Obtain FLHRS Saddlebag Lock Set Kit (11) components from this kit.
2. Install kit to one saddlebag, following the instructions in the FLHRS Saddlebag Lock Set Kit (46287-04).

Install Saddlebag Lid Parts

1. See Figure 1. Using a 3/16 in. diameter drill bit, carefully drill out four rivets retaining buckle straps to saddlebag lid. Note front and rear strap, and set them aside.

NOTE

Take care not to damage the leather surface of the saddlebag lid when performing this step.

2. See Figure 2. Insert rivets (3) into holes in saddlebag lid from outside.
3. Place front and rear buckle straps onto rivets on underside of saddlebag lid.
4. Install roof bracket (5) from kit onto rivets, over buckle straps, and thread screws (4) into rivets. Tighten securely.

Install Saddlebag Base Parts

1. See Figure 2. Position inner plate (1) from kit on inside of saddlebag base, curved end tight against front of saddlebag, lining up top of inner plate with top outboard edge of saddlebag.
2. Lightly clamp inner plate to saddlebag to hold it in place, avoiding the holes.

NOTE

Take care not to damage the leather surface of the saddlebag base during the next two steps.

3. See Figure 1. Using a 1/8 in. diameter drill bit, carefully drill six pilot holes in saddlebag base rim, using inner plate as a template.
4. Remove inner plate and, using a 7/32 diameter drill bit, carefully drill out six holes.
5. See Figure 2. From the outside, insert rivets (3) into second and third holes from rear in saddlebag base.
6. Position inner plate (1) onto two rivets.
7. Obtain inner plate guard (2) from kit and place it onto the rivets. Thread two screws (4) into rivets, but do not fully tighten.

⚠ WARNING

Wear safety glasses or goggles when removing or installing retaining rings. Retaining rings can slip from the pliers and could be propelled with enough force to cause serious eye injury. (00312a)

8. From the outside, insert rivets into remaining holes in saddlebag base and inner plate. Thread screws into rivets, but do not fully tighten.

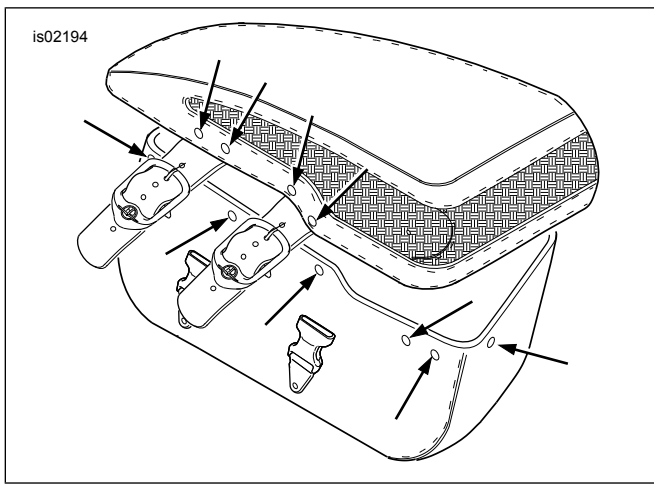

Figure 1. Rivet Positions in Saddlebag Lid and Base

Install Actuator Cable

1. See Figure 2. Obtain the actuator cable assembly (7) from kit.
2. Remove retaining ring at adjustment-nut end of cable.

NOTE

Make sure you are using the correct retaining-ring pliers. Verify that tips of pliers are not excessively worn or damaged.

3. Insert cable end through hole in lock set backing plate (14), and insert the cable into slot in lock set actuator rod so ball on end of cable fits into depression.
4. Install retaining ring into cable fitting groove.
5. Install cover (15) over lock set actuating rod and cable end, and fasten with two hex washer head Hi-Lo self-tapping screws (20).

Install Latch and Spring

1. See Figure 2. Obtain latch and spring kit (6).
2. Insert free end of actuator cable through spring, and insert cable into slot in latch actuator so ball on end of cable fits into depression.
3. Position latch actuator inside tabs of roof bracket (5), and latch shroud outside tabs, lining up the holes.
4. Insert clevis pin through holes and fasten with spring clip.
5. Insert key into lock set, and turn to unlock if necessary. Press key inward and check latch for proper operation.

Final Assembly

1. Close lid and install saddlebag onto the vehicle.
2. Repeat all Steps for the opposite saddlebag.

SERVICE PARTS

is02207

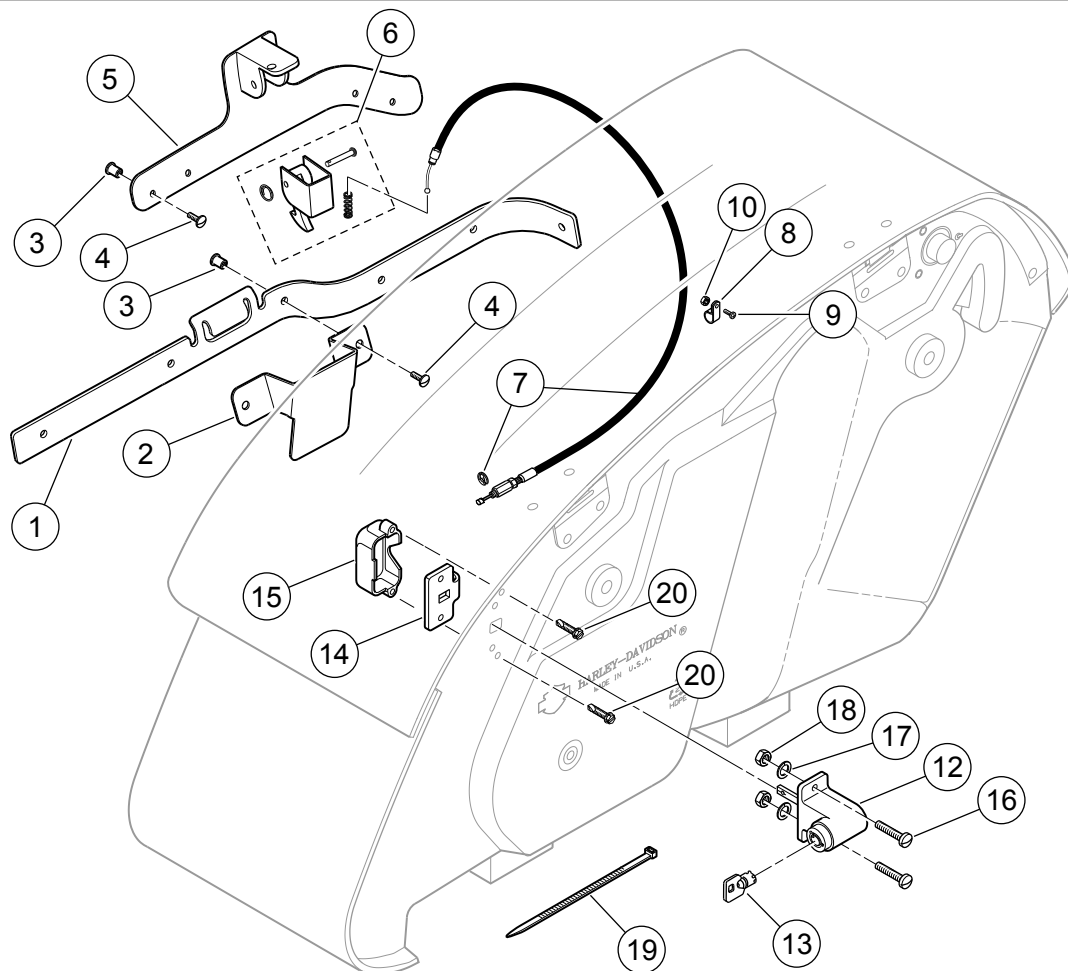

Figure 2. Service Parts: FLHRC Saddlebag Lock Set Kit

Table 1. Service Parts: FLHRC Saddlebag Lock Set Kit

Item	Description (Quantity)	Part Number	Item	Description (Quantity)	Part Number
1	Plate, inner (left, shown)	Not Sold Separately	10	Nut with lockwasher, #6-32 (4)	7889
	Plate, inner (right, not shown)	Not Sold Separately	11	FLHRS Saddlebag Lock Set Kit (Kit contains items 12 through 20. See kit package for part numbers.)	46287-04
2	Guard, inner plate (2)	Not Sold Separately	12	Lock set, saddlebag (2)	
3	Rivet, #8-32 post (25)	8564	13	Key	
4	Screw, slotted special (25)	8567	14	Backing plate (2)	
5	Bracket, roof (left, shown)	Not Sold Separately	15	Cover (2)	
	Bracket, roof (right, not shown)	Not Sold Separately	16	Screw (4)	
6	Latch and spring kit (left, shown)	91445-04	17	Lockwasher (4)	
	Latch and spring kit (right, not shown) (Kits each contain one actuator, spring, shroud, clevis pin, and spring clip)	91411-04	18	Nut, hex (4)	
7	Cable assembly, actuator (2)	Not Sold Separately	19	Tie strap (2)	
8	Wire clip (4)	Not Sold Separately	20	Screw, hex washer hd (4)	
9	Screw, pan hd #6-32 x 5/8 (4)	3225			