



INSTRUCTIONS

J02185

2013-11-01



WATER PUMP HOSE COVER KIT

GENERAL

Kit Number

29770-01

Models

For model fitment information, see the P&A retail catalog or the Parts and Accessories section of www.harley-davidson.com (English only).

⚠ WARNING

Rider and passenger safety depend upon the correct installation of this kit. If the procedure is not within your capabilities or you do not have the correct tools, have a Harley-Davidson dealer perform the installation. Improper installation of this kit could result in death or serious injury. (00308b)

Kit Contents

See Figure 4 and Table 1.

NOTE

A Service Manual for your vehicle is available from your Harley-Davidson dealer.

INSTALLATION

⚠ CAUTION

At operating temperature, radiators and oil coolers contain hot fluids. Contact with a radiator or oil cooler can result in minor or moderate burns. (00141b)

NOTE

Do not remove the stock hose clamp fastening the bottom of the hose to the cooling system. This installation does not require opening the cooling system.

1. Allow the engine and radiator system to cool before servicing the radiator system.
2. Remove the hose clamp fastening the stock hose cover to the water-pump hose to remove the cover from the hose.
3. See Figure 1 and Figure 2. Align the bottom edge of the new front and rear brackets to the top edge of the stock hose clamp located on the bottom of the hose. Fasten the front and rear brackets using the 13mm-long screws provided. Tighten the screws to 1.1-1.4 Nm (10-12 in-lb).
4. Fasten the hose clamp around the top tab on the front bracket and around the heat-shrink seal at the top of the hose. Position the hose-clamp screw to the engine-side of the hose, behind the hose heat-shrink seal, with the screw head facing to the rear. Tighten the hose clamp until snug.

5. Fasten the hose cover to the front bracket using the 6.5mm-long screws provided. Tighten the screws to 1.1-1.4 Nm (10-12 in-lb).

NOTE

See Figure 3. Adjust the front and back bracket assembly vertically on the hose to allow the hose cover to be installed without the top of the hose cover contacting the underside of the frame.

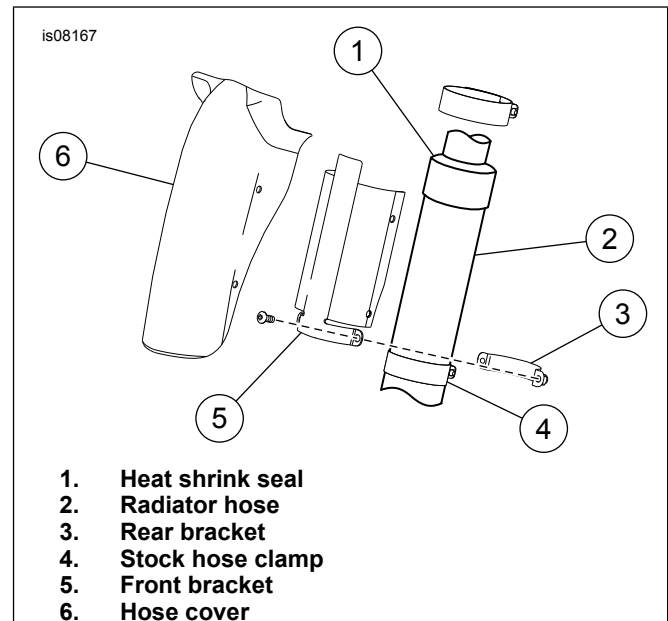

Figure 1. Hose Cover and Hose Components

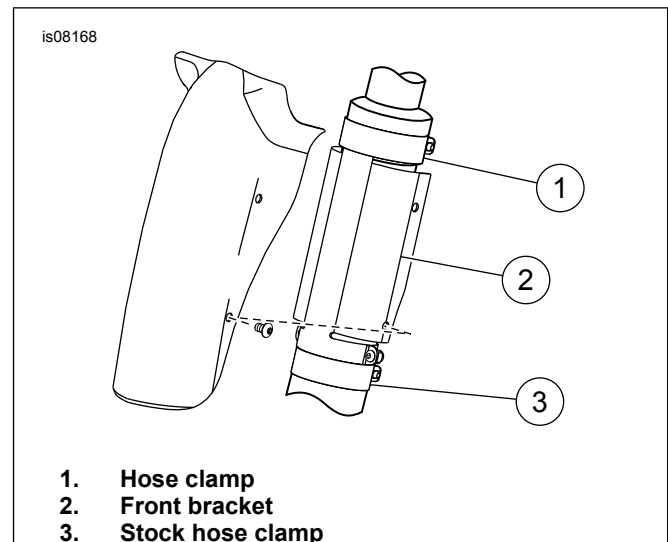

Figure 2. Bracket Position on Hose



Figure 3. Hose Cover Installed

Service Parts

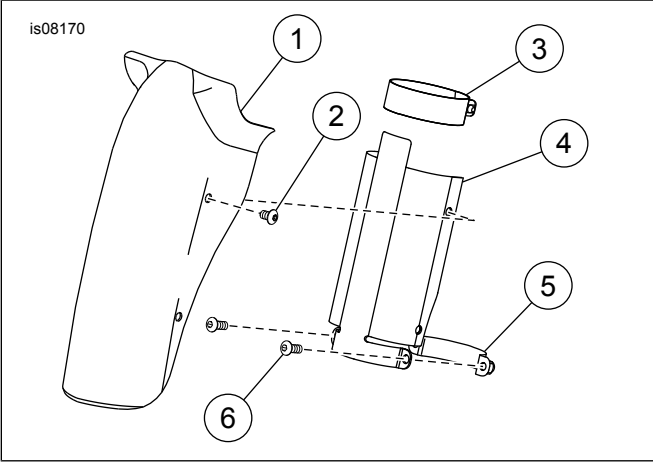

Figure 4. Service Parts

Table 1. Service Parts

Item	Description (Quantity)	Part Number
1	Hose Cover	Not sold separately
2	Screw, 4mm x 6.5mm (4)	94429-02
3	Hose clamp	26730-01
4	Front Bracket	Not sold separately
5	Rear Bracket	Not sold separately
6	Screw, 4mm x 13mm (2)	94427-02