



INSTRUCTIONS

J01209

2015-01-17



ROAD KING SOLO BUCKET AND PASSENGER PILLION

GENERAL

Kit Number

51928-01, 51929-01, 51092-04

Models

For model fitment information, see the P&A Retail Catalog or the Parts and Accessories section of www.harley-davidson.com (English only).

Installation Requirements

⚠ WARNING

Rider and passenger safety depend upon the correct installation of this kit. If the procedure is not within your capabilities or you do not have the correct tools, have a Harley-Davidson dealer perform the installation. Improper installation of this kit could result in death or serious injury. (00308b)

⚠ WARNING

Do not install these seat kits on motorcycles that are not equipped with an appropriate grab strap and passenger footpegs. If footpegs and grab strap are not installed, passenger could fall from moving motorcycle or grab onto operator, causing loss of control and death or serious injury. (00410b)

To install the Solo Bucket and Passenger Pillion together on Road King Classic models, install Kit Number 52903-01.

Kit Contents

See Figure 1 and Table 1.

NOTICE

Detach passenger seat strap before removing seat. Failure to do so can result in damage to rear fender paint. (00225a)

INSTALLATION

Solo Saddle Only

1. **All models:** Remove seat and grab strap. See service manual. Retain hardware.

2.
 - a. **For Road King standard models:** See Figure 1. Remove the screws and seat mount bracket from the back of the seat. Save the screws and bracket.
 - b. **For 2000 and later models:** Remove the retainer washer from the stud plate. See Figure 1. Install the two black washers (2). Do not allow the stud plate to fall through the fender.
3.
 - a. **For Road King standard models:** Install seat mount bracket using screws removed earlier.
 - b. **For Road King classic custom models:** Install solo seat mount bracket (12) using screws (11).

Solo and Pillion

1. **All models:** Remove seat and grab strap. See service manual. Retain hardware.
2. **For Road King standard models:** Install seat mount bracket using screws removed earlier.
3.
 - a. **For Road King Custom models:** See Figure 1. Install solo seat mount bracket (12) using screws (11).
4.
 - a. **For Road King standard models:** Install seat mount bracket using screws removed earlier.
 - b. **For Road King classic custom models:** Install solo seat mount bracket (12) using screws (11).
5.
 - a. **1999 and Later Road King standard models:** Secure the rear mount bracket with stock nuts (10) and two washers (6). Tighten to 8.1 N·m (72 in-lbs).
 - b. **1998 and Earlier Road King standard models:** Install solo seat by sliding front of seat into holder bracket on vehicle. Secure the rear mount bracket with the two screws (11) and two star washers (5). Tighten to 23 N·m (17 ft-lbs).
 - c. **Road King classic custom models:** Install solo seat (7) by sliding front of seat into holder on back of motorcycle.
 - d. **1999 and later Road King classic custom models:** Secure the rear mount bracket with nuts (10) and two washers (6). Tighten to 8.1 N·m (72 in-lbs).

- e. **1998 and earlier Road King classic custom models:** Secure the rear mount bracket with two screws (11) and two washers (5). Tighten to 23 N·m (17 ft-lbs).
6. Install the rear mount bracket onto the rear of pillion (9). Tighten to 4.5–6.8 N·m (40–60 in-lbs).
7. Slide the pillion mount bracket (front and bottom of pillion) onto the bolts/nuts.
1. **Solo Saddle models:** Install seat by sliding the front of the seat into seat holder bracket. Pull up on the nose of the seat to verify that the seat is securely installed. **1999 and Later Models:** Install star washers (6), spacers (4) and acorn nuts (3) onto rear mount studs. Tighten to 8.1 N·m (72 in-lbs). **Solo and Pillion:** See Figure 1. Secure the rear of the pillion (9) with the screws removed earlier. Pull up on the front of the pillion to verify that the seat is secure. Install grab strap (8) in the same holes as the stock grab strap was installed.
2. Pull up on the front and rear of the seat again to verify that it is properly secured.

Completion

⚠ WARNING

After installing seat, pull upward on seat to be sure it is locked in position. While riding, a loose seat can shift causing loss of control, which could result in death or serious injury. (00070b)

SERVICE PARTS

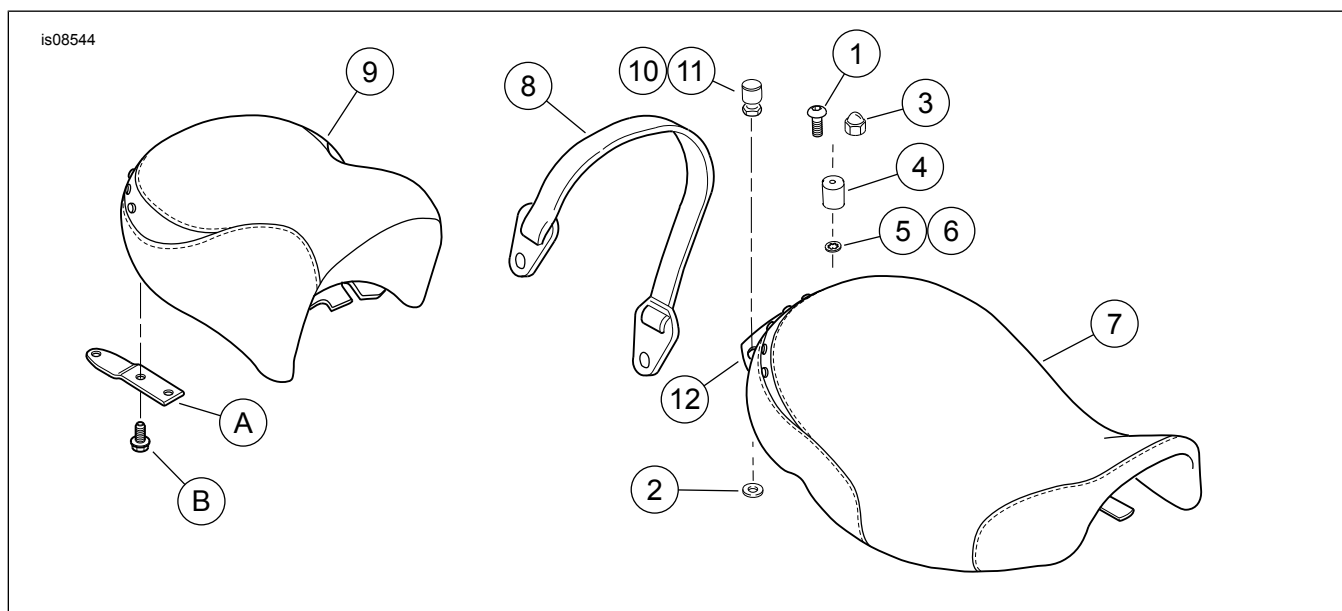

Figure 1. Service Parts: Road King Solo Bucket and Pillion

Table 1. Service Parts Table: Road King Solo Bucket and Pillion

Kit	Item	Description (Quantity)	Part Number
Kit 51928-01	1	Screw (2), (1998 and earlier models)	4092
	2	Washer (not required on 1999 models)	7451
	3	Acorn nut (1999 and later models)	31589-80
	4	Spacer (2), (1999 and later models)	6386
	5	Lockwasher (2), (1998 and earlier models)	31589-80
	6	Lockwasher (2), (1999 and later models)	6386
	7	Solo seat	Not sold separately
Kit 51092-04	1	Screw (2), (1998 and earlier models)	4092
	2	Washer (not required on 1999 models)	7451
	3	Acorn nut (1999 and later models)	31589-80
	4	Spacer (2), (1999 and later models)	6386
	5	Lockwasher (2), (1998 and earlier models)	31589-80
	6	Lockwasher (2), (1999 and later models)	6386
	7	Solo seat	Not sold separately
Kit 51929-01	8	Grabstrap	51627-98
	9	Pillion	Not sold separately
Kit 52903-01	10	Seat mounting nut	3638
	11	Seat mounting screw	3662A
	12	Solo mounting bracket (stock on FLHR standard)	52008-97

Table 1. Service Parts Table: Road King Solo Bucket and Pillion

Kit	Item	Description (Quantity)	Part Number
Items mentioned in text, but not included in kit:			
A		Mounting bracket	
B		Screw (2)	