



INSTRUCTIONS

J02188

2013-11-01



POLISHED STAINLESS STEEL FOOTPEG MOUNTING PINS

GENERAL

Kit Number

42679-01

Models

For model fitment information, see the P&A retail catalog or the Parts and Accessories section of www.harley-davidson.com (English only).

NOTE

A Service Manual for your model motorcycle is available from your Harley-Davidson Dealer.

Table 1. Service Parts

Item	Description (Quantity)	Part Number
1	Clevis pin (2)	42680-01
2	Spring washer (2)	50912-72
3	Washer (2)	6379W
4	Retaining ring (2)	11304

INSTALLATION

⚠ WARNING

Footrests must fold up and toward rear of motorcycle if struck. Failure to set footrests to fold up and back could result in death or serious injury. (00366a)

1. See Figure 1. For each footpeg, remove nut (1), screw (2), footpeg (3) and spring washer (4).
2. Install the footpeg inserting a new spring washer between the footpeg and the footpeg support (5).
3. Insert the new clevis pin (6) through the footpeg support and the footpeg. Notice that the new pin has two grooves. Position the retaining ring (7) in the groove that allows the least amount of free play for the clevis pin. The kit also contains a flat washer (8), which can be used to further reduce the amount of free play for the clevis pin. (Use of this washer is optional.)
4. Once the best combination is found, secure the retaining ring (7) onto the pin (6).

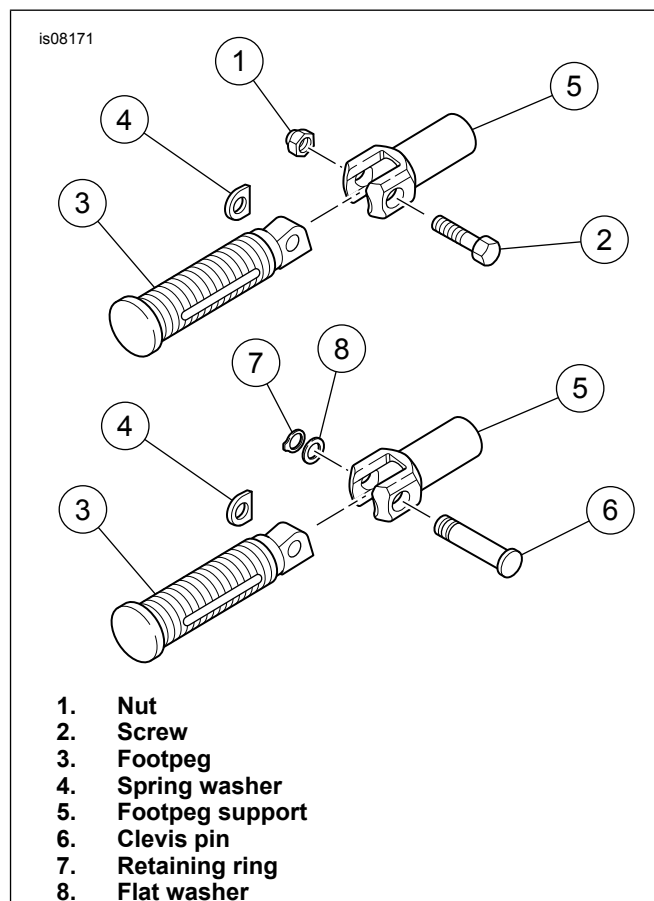

Figure 1. Footpeg Mounting Pins