



INSTRUCTIONS

J02252

2006-03-21



"SKULL" FRONT FENDER SKIRT KIT

GENERAL

Kit Number

59582-02A

Models

This kit is designed for installation on 1980 and later Touring Models, 1986 and later FLSTC and 1993 to 1996 FLSTN and 2006 FLST models (except FLSTSC) equipped with original fender skirt.

Kit Contents

See Figure 2 and Table 1.

There are no Service Parts available with this kit.

INSTALLATION

1. See Figure 2. Remove screws, washers and nuts securing existing fender skirt to fender. Discard fender skirt and hardware.

NOTE

Some early models have rivets for fasteners. These rivets will need to be drilled out. Drill the rivet heads to a sufficient depth to remove the head from the rivet shaft.

Do not attempt to drill the rivet all the way through. This may scratch the fender's painted surface.

2. Thoroughly clean the fender where skirt will be mounted.

NOTE

For FLSTC Models and applications in which the skirt overlaps the fender, cut the foam strip into three pieces making two slightly larger to cover the heads of the screws that hold medallion in place. Use the smaller piece on the middle inside/bottom of the skirt. The foam strips will prevent rattling and unwanted noise.

When performing the following step, the washers are installed on the inside of the fender.

3. Obtain the new Fender Skirt (1), Fender Skirt Mounting Screws (2), Washers (3) and Nuts (4) from kit. Orient the fender skirt as shown and install skirt to fender. Tighten mounting hardware securely.

Clean Fender Installation

NOTE

To install this skirt kit on H-D Accessory Clean Fenders (Part Numbers 59022-96, 50054-96) or FLTR with clean fenders), see Figure Inset and perform the following.

1. See Figure 1. Clean area of fender where fender skirt will be mounted and cover that portion of fender with masking tape to protect painted surface during positioning of skirt and drilling of mounting holes (1).

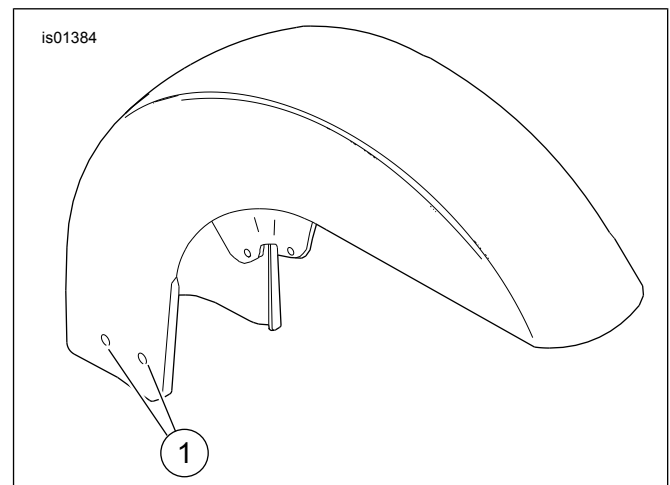

Figure 1. Clean Front Fender Hole Locations

2. Place fender skirt in desired location and mark mounting hole locations with felt tip pen. The lower edge of the fender skirt should be approximately level, but slightly lower than the lower edge of the fender.
3. Remove fender skirt and carefully center punch holes at locations marked.
4. Drill mounting holes using an 1/8 inch diameter drill bit.
5. Remove masking tape and attach fender skirt as described in Installation procedures, Steps 1 through 3.



SERVICE PARTS

is01385

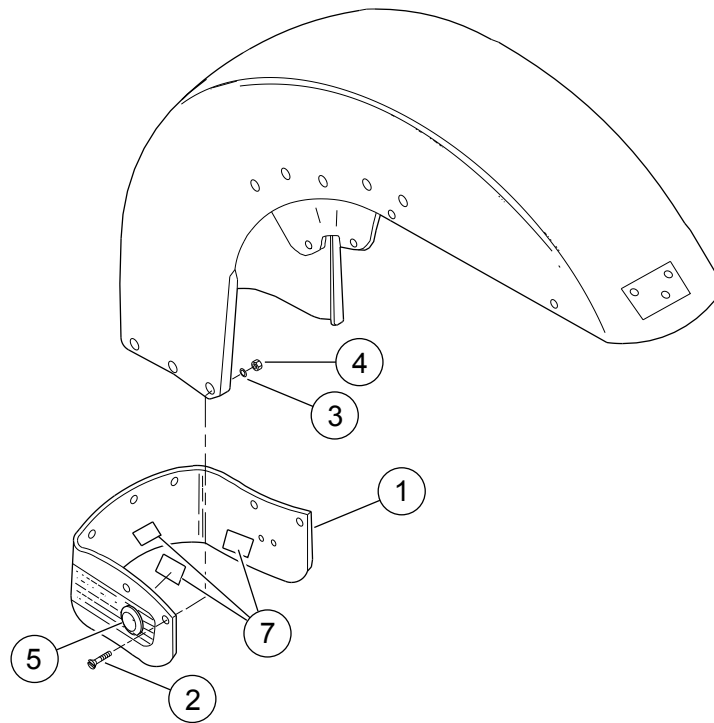

Figure 2. Service Parts: Skull Front Fender Skirt Kit

Table 1. Service Parts Table

Item	Description (Quantity)	Part Number
1	Skirt, front fender	Not Sold Separately
2	Screw, stainless (6)	Not Sold Separately
3	Washer stainless (6)	Not Sold Separately
4	Nut, stainless (6)	Not Sold Separately
5	Medallion, skull (2) (pre-installed)	Not Sold Separately
6	Screw, self tapping (4) (pre-installed, not shown)	Not Sold Separately
7	Adhesive foam strip	Not Sold Separately