



INSTRUCTIONS

J02882

2006-12-06



XL JIFFYSTAND EXTENSION

GENERAL

Kit Number

50250-04

Models

For model fitment information, please see the P&A Retail Catalog or the Parts and Accessories section of www.harley-davidson.com (English only).

Kit Contents

See Figure 2 and Table 1.

INSTALLATION

1. Block the motorcycle under the frame so that it is securely upright (not leaning to either side), and so that the jiffy stand may be moved without restriction, through its normal range of travel.
2. Figure 1. Obtain the jiffy stand cover (1) from kit and slide the cover over the jiffy stand until it is in the outermost position.
3. Use a marker and mark the jiffy stand at the center of the hole.
4. With the underside of the jiffy stand flat section supported by a wood block(s), remove the jiffy stand cover and using a punch, indent the center of the mark deep enough to keep the drill bit from drifting.
5. Drill a starter hole through the jiffy stand (at center of punch indentation) using a 1/8 inch drill bit at a slow speed. Use of a cutting oil is also recommended.
6. Obtain a 9/32 inch drill bit and drill hole through the jiffy stand at the starter hole. Remove any burrs or rough edges.
7. Obtain the screw (3), jiffy stand extension (2), lockwasher (4) and nut (5) from kit.
8. Using Figure 1 as a reference, orient the jiffy stand extension as shown and assemble the extension kit using the hardware stackup shown.
9. Tighten the hardware to 11 N·m (8 ft-lbs).

⚠ WARNING

The jiffy stand locks when placed in the full forward (down) position with vehicle weight on it. If the jiffy stand is not in the full forward (down) position with vehicle weight on it, the vehicle can fall over which could result in death or serious injury. (00006a)

⚠ WARNING

Be sure jiffy stand is fully retracted before riding. If jiffy stand is not fully retracted, it can contact the road surface causing a loss of vehicle control, which could result in death or serious injury. (00007a)

10. Check the jiffy stand and extension for unrestricted movement through their normal range of travel.

NOTE

The jiffy stand extension is intended only to improve the rider's access to the jiffy stand. It is not intended to be used as an indicator of jiffy stand position.

NOTE

Do not step on the jiffy stand extension or it may be damaged.

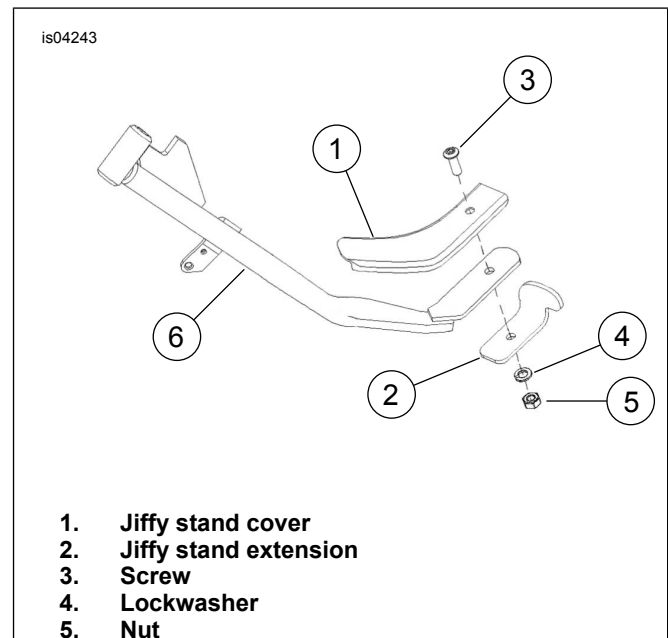

Figure 1. Jiffy Stand Extension Assembly

SERVICE PARTS

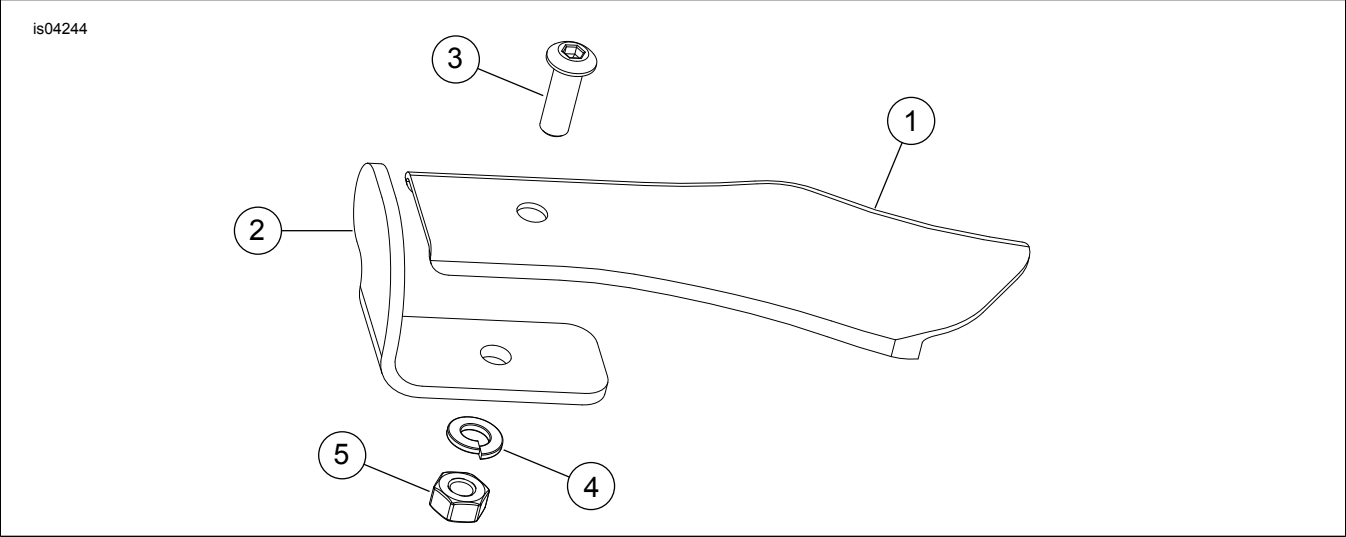

Figure 2. Service Parts: XL Jiffy Stand Extension Kit

Table 1. Service Parts Table

Item	Description (Quantity)	Part Number
1	Cover, jiffy stand extension	Not Sold Separately
2	Extension, jiffy stand	Not Sold Separately
3	Screw	94386-92T
4	Lockwasher	94041-90T
5	Nut	94941-90T