



# INSTRUCTIONS

J03240

2005-12-06



## QUICK-RELEASE SADDLEBAG BUCKLE SERVICE KIT

### GENERAL

#### Kit Number

90454-04

#### Models

This kit fits Saddlebag Kit 79300-04, 79300-06, and 88224-06

#### Kit Contents

Table 1. Kit Contents

Description (Quantity)	Part Number
Buckle receptacle (1)	Not Sold Separately
Backing plate (1)	Not Sold Separately

There are no Service Parts available with this kit.

#### NOTE

Do not "test" assemble the two pieces of the kit before installing on the saddlebag. Disassembly will destroy the functionality of the parts.

### INSTALLATION

#### Removing the Broken Buckle Receptacle

#### NOTE

The saddlebag should remain mounted on the motorcycle for this installation.

DO NOT attempt to pry off the existing receptacle from the outside of the saddlebag. Damage to the leather surface will occur.

1. See Figure 1. From the inside of the saddlebag only, use a large, flat-bladed screwdriver at the top (location 1) to carefully pry the two upper ratchet pegs (5) on the existing backing plate (4) away from the buckle receptacle (3).

#### NOTE

Ratchet pegs will break off or ratchet teeth will strip during the above step.

2. Once the upper part of the backing plate has been pulled away from the saddlebag, insert the screwdriver under the side of the backing plate (location 2), and continue to pry the lower ratchet pegs out from the buckle receptacle. Remove and discard the old receptacle and backing plate.

#### Installing the New Buckle Receptacle

1. From the inside of the saddlebag, insert the four ratchet pegs on the new backing plate through the three holes in the saddlebag.

2. From the outside of the saddlebag, line up the "D"-shaped holes on the back of the new buckle receptacle with the ratchet pegs protruding through the side of the saddlebag.
3. Press the buckle receptacle and backing plate together. There will be a number of audible "clicks" as the ratchet teeth on each peg lock in to the receptacle. Continue pressing the two pieces together until the receptacle is solidly attached to the saddlebag.

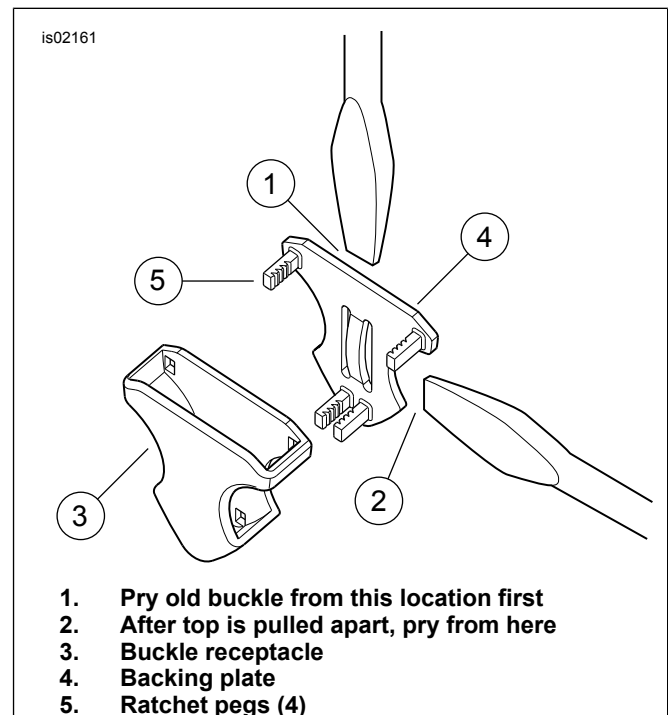

Figure 1. Saddlebag Buckle Receptacle