



# INSTRUCTIONS

J03552

2005-01-19



## SKULLFIRE REAR WHEEL KIT

### GENERAL

#### Kit Number

41321-05, 41402-05.

#### Models

Table 1. Models

| Kits     | Models  |
|----------|---|
| 41321-05 | All 2003 and later FL Softail motorcycles, <b>except</b> FLSTS/I (Heritage Springer) and FLTSC/I (Softail Springer Classic) |
| 41402-05 | All 2000 through 2002 Softail motorcycles, <b>except</b> FLSTS/I (Heritage Springer) and FXSTD/I (Deuce)                    |
|          | All 2000 through 2004 XL (Sportster) models   |
|          | All 2000 and later Dyna models  |
|          | All 2000 through 2001 FL Touring models   |

#### Additional Parts Required

##### ⚠ WARNING

Rider and passenger safety depend upon the correct installation of this kit. Use the appropriate service manual procedures. If the procedure is not within your capabilities or you do not have the correct tools, have a Harley-Davidson dealer perform the installation. Improper installation of this kit could result in death or serious injury. (00333b)

##### NOTE

This instruction sheet references Service Manual information. A Service Manual for your model motorcycle is required for this installation and is available from a Harley-Davidson Dealer.

#### Kit Contents

See Figure 1 and Table 2.

### INSTALLATION

Refer to the appropriate Service Manual for wheel removal and installation procedures.

##### NOTE

The wheel should be installed so that the valve stem is on the **right side** of the motorcycle.

##### NOTICE

**Do not re-use brake disc/rotor screws. Re-using these screws can result in torque loss and damage to brake components. (00319c)**

See Figure 1 and Table 2. This kit contains the necessary parts for wheel installation. However, you will need to save the axle, axle nut, spring clip, brake disc, and the drive pulley with related hardware for re-installation.

##### NOTE

Apply two drops of LOCTITE 262 (red) to each of the five sprocket mounting screws. Follow the bolt torque procedure in your Service Manual or, if installing an accessory hardware kit, in the Instruction Sheet included with the hardware kit.

### MAINTENANCE AND CLEANING

Chrome parts must be maintained regularly to ensure that they keep their original shine and luster.

1. Clean heavily-soiled wheel surfaces using Harley Wheel and Tire Cleaner, Part Number 94658-98, applied with Harley Wheel and Spoke Brush, Part Number 43078-99.
2. Thoroughly clean chrome with a good quality chrome cleaner, such as Harley Bright Chrome Cleaner, Part Number 94683-99.
3. After cleaning and polishing, seal the finish with a good quality sealer such as Harley Glaze Polish and Sealant, Part Number 99701-84.

### BEARING REPLACEMENT

The disc side (right side) of the wheel is the main bearing side. When installing replacement bearings, install this main bearing first, referring to the applicable Service Manual and using a WHEEL BEARING REMOVER/ INSTALLER, Part Number HD-44060.



# SERVICE PARTS

is00087

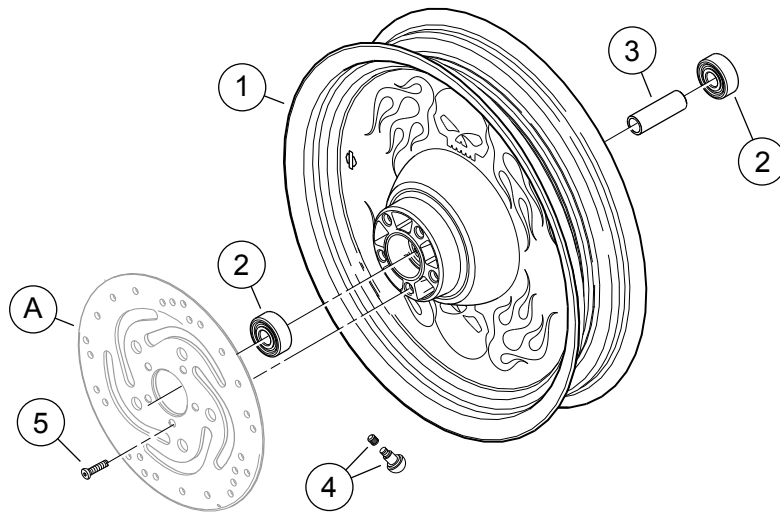

Figure 1. Skullfire Rear Wheel, Kit J03552

Table 2. Service Parts Table

| Item  | Description (Quantity)  | Part Number         |
|---|-------------------------|---------------------|
| 1   | Wheel, rear (Skullfire) | Not Sold Separately |
| 2   | Bearing (2)             | 9267                |
| 3   | Sleeve bearing spacer   | 43608-00            |
| 4   | Valve stem              | 43206-01            |
| 5   | Screw, brake disc (5)   | 43567-92            |
| 6   | Label, rim (not shown)  | Not Sold Separately |
| <b>Item shown, but not included in kit:</b> |                         |                     |
| A   | Brake disc, rear        |                     |