



INSTRUCTIONS

J03806

2006-03-16



CHROME 17 INCH REAR WHEEL KITS

GENERAL

Kit Number

41648-06, 41647-06, 41655-06, 42137-07, and 43179-07

Models

Kits 41648-06, 41647-06, and 41655-06 fit 2006 FX Softail models (except FXSTD).

Kits 42137-07 and 43179-07 fit 2007 FLSTF, FXST, FXSTB, and FXSTC Softail models.

Table 1. Kit Descriptions

Kits	Description
41648-06	Chrome cast 17 x 6 inch wheel with round holes.
41647-06	Chrome forged 17 x 6 inch solid dish wheel.
41655-06	Chrome Road Winder 17 x 6 inch wheel.
42137-07	2007 Chrome Road Winder 17 x 6 inch wheel.
43179-07	Mirror finished forged 17 x 6 inch solid disc wheel.

Additional Parts Required

New sprocket mounting screws must be purchased separately in order to install this wheel. Contact a Harley-Davidson dealer for required hardware.

▲ WARNING

Rider and passenger safety depend upon the correct installation of this kit. Use the appropriate service manual procedures. If the procedure is not within your capabilities or you do not have the correct tools, have a Harley-Davidson dealer perform the installation. Improper installation of this kit could result in death or serious injury. (00333b)

NOTE

This instruction sheet references Service Manual information. A Service Manual for your model motorcycle is required for this installation and is available from a Harley-Davidson Dealer.

Kit Contents

See Figure 1 and Table 2.

INSTALLATION

NOTICE

Do not re-use brake disc/rotor screws. Re-using these screws can result in torque loss and damage to brake components. (00319c)

NOTICE

Do not re-use sprocket mounting screws. Re-using sprocket mounting screws can result in torque loss and damage to the sprocket and/or belt assembly. (00480b)

NOTE

Prior to removing or installing the wheel, the rear brake caliper must be removed.

Refer to the appropriate Service Manual for wheel removal and installation procedures.

See Figure 1. This kit contains the necessary parts for wheel installation, however you will need to save the axle, axle nut, brake disc, and the drive pulley for reinstallation.

NOTE

Inspect the cotter pin and replace as needed. This part is available for purchase from your dealer. See your dealer for the correct part number for your model motorcycle.

New sprocket mounting screws must be purchased to install this wheel. Follow the bolt torque procedure in your Service Manual, or if installing an accessory hardware kit, in the instruction sheet included with the hardware kit.

MAINTENANCE AND CLEANING

Chrome parts must be maintained regularly to ensure that they keep their original shine and luster.

1. Clean heavily-soiled wheel surfaces using Harley Wheel and Tire Cleaner (94658-98) applied with Harley Wheel and Spoke Brush (43078-99).
2. Thoroughly clean chrome with a good quality chrome cleaner, such as Harley Bright Chrome Cleaner (94683-99).
3. After cleaning and polishing, seal the finish with a good quality sealer such as Harley Glaze Polish and Sealant (99701-84).

NOTE

The machined groove on hub face and/or valve stem indicates the primary bearing side.



SERVICE PARTS

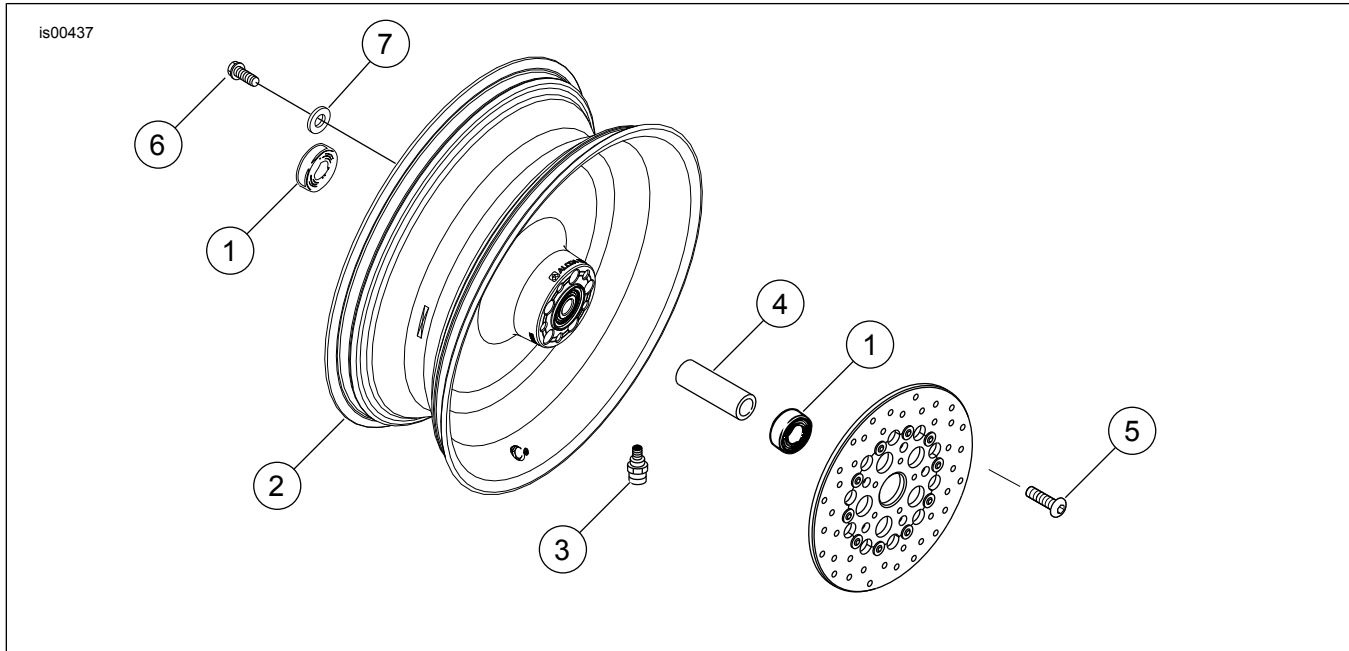

Figure 1. Service Parts: Chrome 17 Inch Rear Wheel Kits (solid dish wheel shown)

Table 2. Service Parts: Chrome 17 Inch Rear Wheel Kits

Kit	Item	Description (Quantity)	Part Number
Kit 41647-06 Kit 41648-06 Kit 41655-06	1	Bearing (2)	9267
	2	Wheel	Not Sold Separately
	3	Valve stem	43157-83A
Kit 42137-07 Kit 43179-07	4	Sleeve spacer	43618-06
	5	Screw (5)	43567-92
Items Requiring Separate Purchase:	1	Bearing (2)	9267
	2	Wheel	Not Sold Separately
	3	Valve stem	43157-83A
	4	Sleeve spacer	43618-07
	5	Screw (5)	43567-92
	6	Screw (5) (for 2006 models)	3737A
		Screw (5) (for 2007 models)	3109
	7	Washer (5) (for 2006 models)	6516HW

Note: Figure 1 shows chrome forged 17 x 6 inch solid dish wheel.