



INSTRUCTIONS

J02917

2004-02-18



SPORTSTER GEAR CASE COVER CHROME HARDWARE KIT

GENERAL

Kit Number

94280-04

Models

This kit fits 2004 and later XL model motorcycles.

Additional Parts Required

NOTE

A Service Manual for your model motorcycle is available from your Harley-Davidson Dealer.

Kit Contents

See Figure 1 and Table 1.

INSTALLATION

⚠ WARNING

To prevent accidental vehicle start-up, which could cause death or serious injury, disconnect negative (-) battery cable before proceeding. (00048a)

1. Refer to the Service Manual and follow the instructions given to remove the seat and disconnect the negative battery cable.
2. Follow the procedure found in the Service Manual to remove and discard the hardware from the gear case cover. Secure the gear case cover with all the new chrome screws and washers.
3. Consult the Service Manual for screw locations, torque values and recommended gasket replacement.
4. Reconnect negative (-) battery cable
5. Refer to the Service Manual and follow instructions to install the seat.

⚠ WARNING

After installing seat, pull upward on seat to be sure it is locked in position. While riding, a loose seat can shift causing loss of control, which could result in death or serious injury. (00070b)

SERVICE PARTS

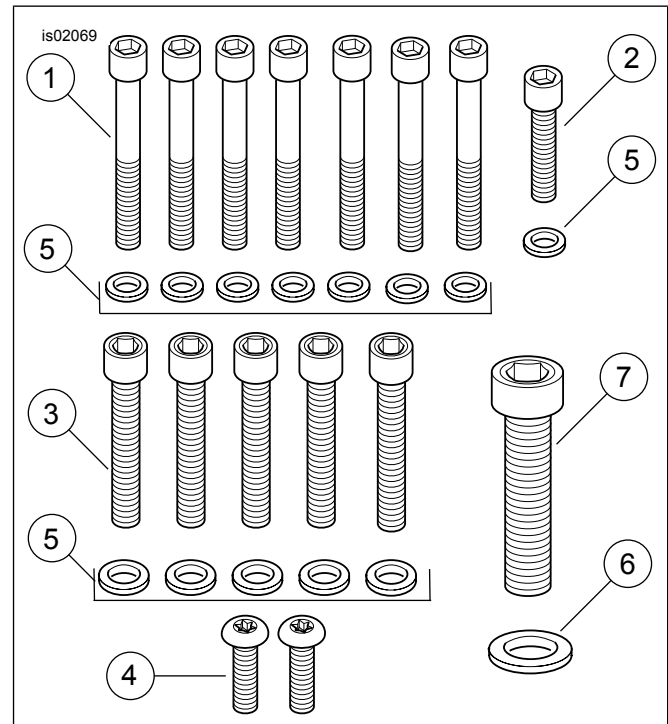

Figure 1. Service Parts: Gear Case Cover Chrome Hardware Kit

Table 1. Service Parts: Gear Case Cover Chrome Hardware Kit

Item	Description (Quantity)	Part Number
1	Screw, Chrome, Socket head (1/4-20 x 2-1/4 inch long) (7)	94319-91TS*
2	Screw, Chrome, Socket head (1/4-20 x 1-1/4 inch long) (1)	94315-91TS*
3	Screw, Chrome, Socket head (1/4-20 x 1-3/4 inch long) (5)	94317-93TS*
4	Screw, Chrome, Button head TORX® (#8-32 x 1/2 inch long) (2)	94587-98*
5	Washer, Chrome (1/4 inch I.D. x 7/16 inch O.D. x 1/16 inch thick) (13)	94062-03
6	Washer, Chrome (3/8 inch I.D.) (1)	94067-90T
7	Screw, Chrome (3/8-16 x 2-1/2 inch long) (1)	94360-91TS*

*These screws are shipped with threadlocker applied. If replacement screws are ordered, apply LOCTITE® THREAD-LOCKER® 243 (blue) (Harley Davidson Part Number 99642-97) to the threads before installing.