



# INSTRUCTIONS

J02960

2005-04-25



## REDUCED EFFORT CLUTCH KIT

### GENERAL

#### Kit Number

36808-05

#### Models

This kit fits all 2005 and earlier model motorcycles equipped with a Twin Cam 88<sup>®</sup> or Twin Cam 88B<sup>™</sup> engine.

#### Additional Parts Required

Proper installation of this kit requires the separate purchase of a primary chaincase cover gasket and a transmission clutch release cover gasket.

#### ▲ WARNING

Rider and passenger safety depend upon the correct installation of this kit. Use the appropriate service manual procedures. If the procedure is not within your capabilities or you do not have the correct tools, have a Harley-Davidson dealer perform the installation. Improper installation of this kit could result in death or serious injury. (00333b)

#### NOTE

This instruction sheet references Service Manual information. A Service Manual for your model motorcycle is required for this installation and is available from a Harley-Davidson Dealer.

### Kit Contents

See Figure 1 and Table 1.

### INSTALLATION

#### Replace Diaphragm Spring

#### NOTE

Refer to the appropriate Service Manual for detailed information on the following generalized steps.

1. Remove the primary chaincase cover.
2. Partially disassemble the clutch pack in order to remove the diaphragm spring.
3. Assemble the clutch pack using the diaphragm spring from the kit.
4. Install the primary chaincase cover.

#### Replace Inner and Outer Ramps

#### NOTE

Refer to the appropriate Service Manual for detailed information on the following generalized steps.

1. Remove and disassemble the transmission clutch release cover.
2. Clean and inspect transmission clutch release cover components.
3. Assemble and install the transmission clutch release cover, using the inner and outer ramps from the kit.

### SERVICE PARTS

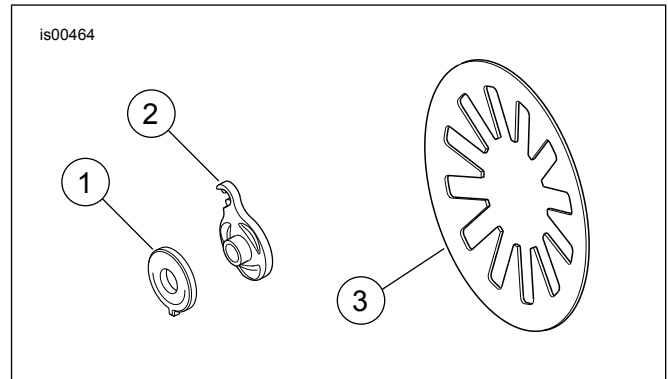

Figure 1. Service Parts for Reduced Effort Clutch Kit

Table 1. Service Parts

Item	Description (Quantity)	Part Number
1	Outer ramp	25605-00A
2	Inner ramp	25604-00A
3	Spring, diaphragm	37882-06

