



INSTRUCTIONS

J02340

2006-11-24



SOFTAIL BLACK REAR SADDLEBAG GUARDS

GENERAL

Kit Number

49269-02

Models

For model fitment information, please see the P&A Retail Catalog or the Parts and Accessories section of www.harley-davidson.com (English only).

Additional Parts Required

Heritage-Style Saddlebag Bracket Relocation Kit, Part Number 90238-00, must also be or previously been installed when installing this Rear Saddlebag Guard Kit on FLSTC models with factory-installed leather saddlebags, and on other Softail models equipped with Heritage-Style Saddlebag Kit, Part Number 90835-90.

⚠ WARNING

Rider and passenger safety depend upon the correct installation of this kit. Use the appropriate service manual procedures. If the procedure is not within your capabilities or you do not have the correct tools, have a Harley-Davidson dealer perform the installation. Improper installation of this kit could result in death or serious injury. (00333b)

NOTE

This instruction sheet references Service Manual information. A Service Manual for your model motorcycle is required for this installation and is available from a Harley-Davidson Dealer.

⚠ WARNING

If Equipped: Front and/or rear guards are not intended to provide protection from bodily injury in a collision with another vehicle or any other object. (00022d)

Kit Contents

See Figure 3 and Table 1.

INSTALLATION

1. Remove saddlebag, if equipped, from motorcycle.

2. Remove passenger footpeg or passenger footboard assembly (including footboard mount) from vehicle.
3. See Figure 1. Remove nut, seat strap bracket (if equipped) and 3/8 inch diameter bolt from indicated position on rear fender support (immediately to the rear of the front seat). Discard the bolt, but save the nut for reinstallation. This location is where the upper part of the saddlebag guard will mount.

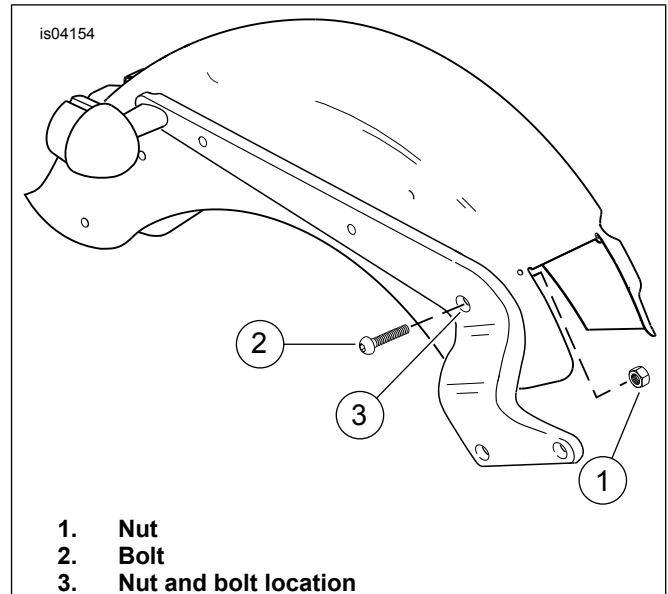
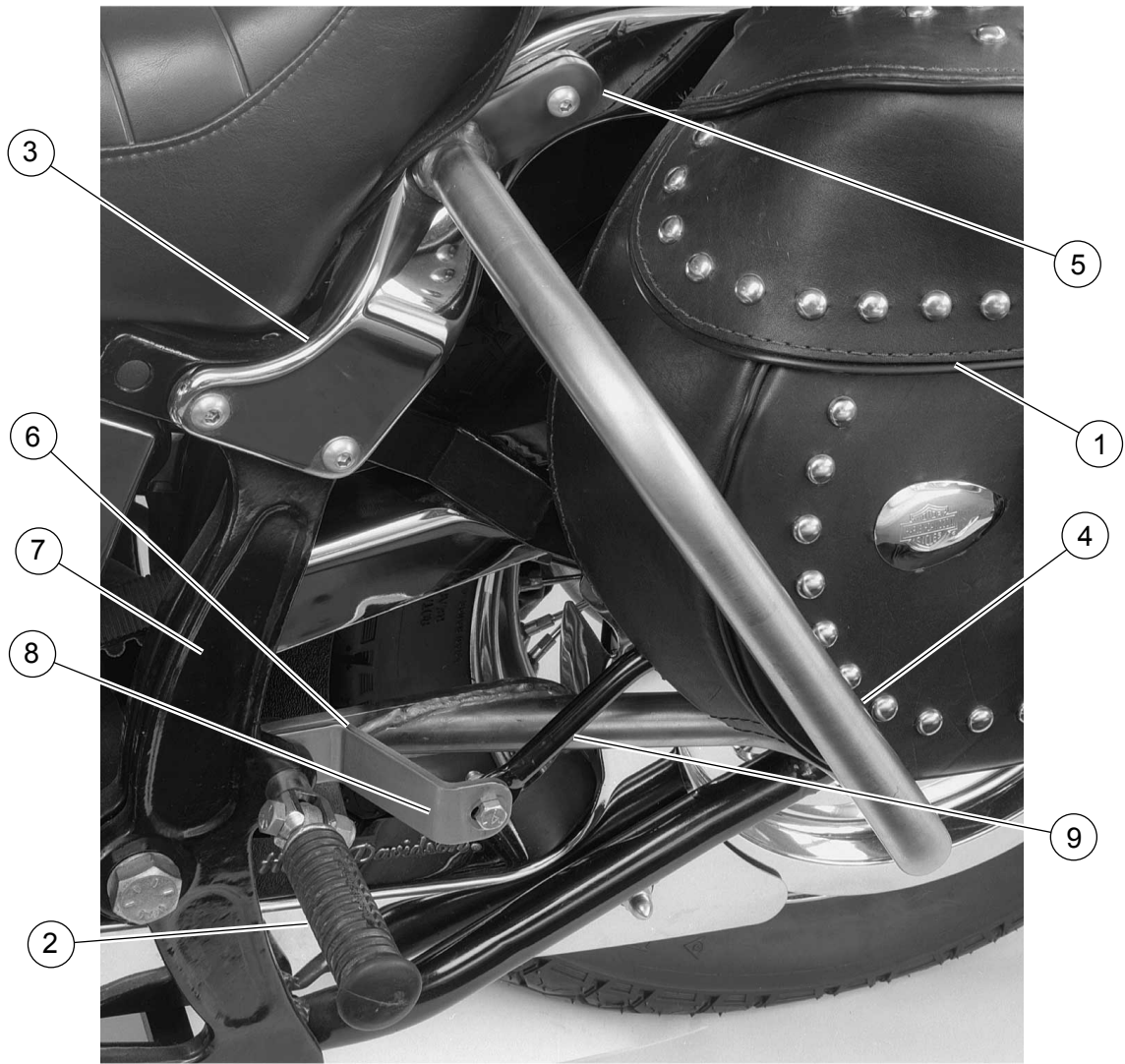

Figure 1. Remove Hardware

4. See Figure 2. Install saddlebag guard top flange against fender support. Install 3/8-16 x 1-3/4 inch button head bolt with the seat strap bracket (if equipped) and hardware removed in Step 3 (if equipped) and nut in same direction as bolt removed in step 3. Finger tighten only.
5. Position bottom flange of saddlebag guard against inboard surface of motorcycle frame at location where passenger footpeg (or passenger footboard bolt) attaches. If Heritage-Style Saddlebag relocation kit, Part Number 90238-00 is to be installed, the bracket should be positioned between the saddlebag guard flange and the motorcycle frame member. Follow installation instructions included with that kit.





- | | |
|-------------------------------|----------------------------------|
| 1. Heritage-style saddlebag | 6. Saddlebag guard bottom flange |
| 2. Passenger footpeg | 7. Motorcycle frame member |
| 3. Rear fender support | 8. Saddlebag relocation bracket |
| 4. Saddlebag guard | 9. Saddlebag support |
| 5. Saddlebag guard top flange | |

Figure 2. Rear Saddlebag Guard Install (Left side)

▲ WARNING

Footrests must fold up and toward rear of motorcycle if struck. Failure to set footrests to fold up and back could result in death or serious injury. (00366a)

6. See Figure 2 and Figure 3. Determine your model application and follow the applicable installation procedure below: **On models with passenger footpeg, but without saddlebag relocation bracket:** Install 3/8-16 x 2-3/4 inch socket head cap screw through footpeg support. Install support to frame. Tighten support bolt to 35-45 ft-lbs (47-61 N-m). Install lower saddlebag guard flange over bolt protruding from inboard surface of frame member. Install 3/8-16 lock nut to end of bolt. Tighten to 35-45 ft-lbs (47-61 N-m). Install footpeg according to Service Manual instructions. **On models with passenger footpeg and saddlebag relocation bracket:** Install 3/8-16 x 2-3/4 inch socket head cap screw through footpeg support. Install support to frame. Tighten support bolt to 35-45 ft-lbs (47-61 N-m). Position saddlebag relocation bracket over bolt. Install lower saddlebag guard flange over bolt protruding from inboard surface of frame member. Install 3/8-16 lock nut to end of bolt. Tighten nut to 35-45 ft-lbs (47-61 N-m). Install footpeg per Service Manual instructions. **On models with passenger footboard with or without toolbox:** Install 3/8-16 x 2-1/4 inch socket head cap screw through passenger footboard mount and toolbox bracket (if equipped). Tighten footboard mounting bolt to 35-45 ft-lbs (47-61 N-m). Position saddlebag relocation bracket over bolt. Install lower saddlebag guard flange over bolt protruding from inboard surface of frame member. Install 3/8-16 lock nut to end of bolt. Tighten nut to 35-45 ft-lbs (47-61 N-m). **On models with passenger footpegs and tool box:** Install 3/8-16 x 2-1/4 inch socket head cap screw, from the inboard side of the motorcycle, through hole in saddlebag guard bottom flange, saddlebag relocation bracket into the the motorcycle frame member. Tighten bolt to 35-45 ft-lbs (47-61 N-m). Install passenger footpeg spacer to the end of the bolt. Tighten footpeg spacer to 35-45 ft-lbs (47-61 N-m). Install passenger footpeg support to end of footpeg spacer. Tighten to 35-45 ft-lbs (47-61 N-m). Install footpeg per Service Manual instructions.
7. Final tighten nut that secures saddlebag guard top flange (See step 4) to 21-27 ft-lbs (27-37 N-m). Reinstall saddlebag, if equipped, to motorcycle. If not already connected, attach loose end of the saddlebag relocation bracket to the lower leg of the saddlebag support with the fasteners from the relocation bracket kit. Repeat Steps 1-7 for installing saddlebag guard on opposite side of motorcycle.
8. Discard remaining original and kit mounting hardware.

SERVICE PARTS

is04156

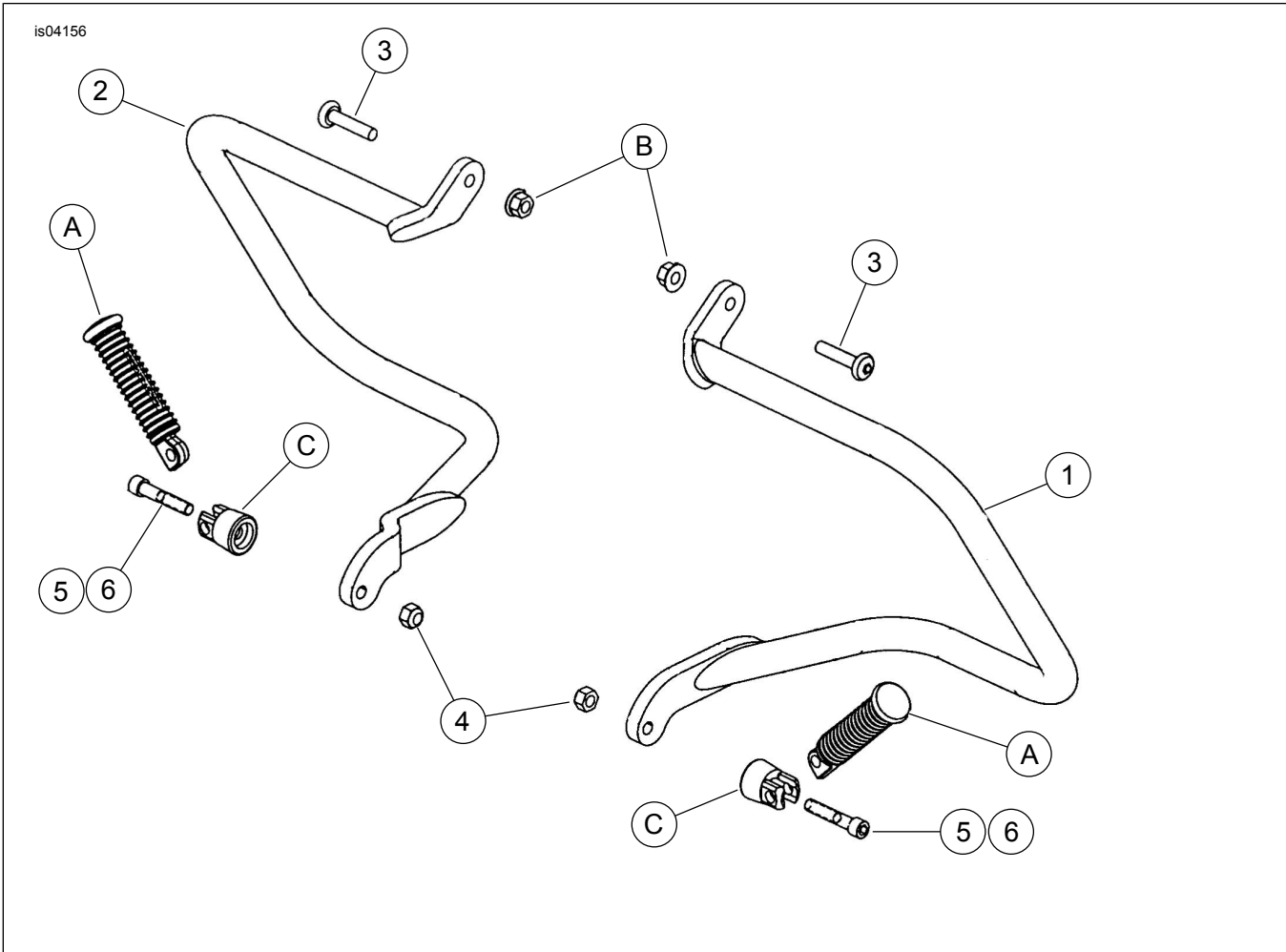

Figure 3. Service Parts: Black Softail Rear Saddlebag Guard

Table 1. Service Parts Table

Item	Description (Quantity)	Part Number
1	Saddlebag guard, left (black)	49273-02
2	Saddlebag guard, right (black)	49272-02
3	Screw, button head (2)	4203
4	Locknut (2)	7778
5	Screw, socket head, 2-1/4 inch (2)	4201
6	Screw, socket head, 2-3/4 inch (2)	4209
Items mentioned in text, but not included in kit:		
A	(footpeg) (2)	
B	Nut (2)	
C	Footpeg support (2)	