



INSTRUCTIONS

J01335

2004-01-01



TRANSMISSION TOP COVER KIT

GENERAL

Kit Number

66513-00

Models

This kit fits 1999-2005 Dyna models and must be used with one of the following interface cover kits: 66515-00, 66038-99, or 66018-99. This kit does not fit with covers 18248-99 or 32753-01.

There are no Service Parts available with this kit.

Kit Contents

See Figure 3 for a list of kit contents.

INSTALLATION

NOTE

A Service Manual for your motorcycle is available at your Harley-Davidson Dealership.

1. See Figure 1. Remove two forward screws (1) from top transmission cover (2). Save hardware for reinstallation.

NOTE

If one of the engine transmission side covers is already installed on your motorcycle, it may be necessary to remove the cover to allow for easier installation of the transmission top cover. Reinstall the side cover according to the directions given in the applicable instruction sheet. See Figure 3. The foam pad (5) on the small top cover (4) will rest underneath the edge of the side cover.

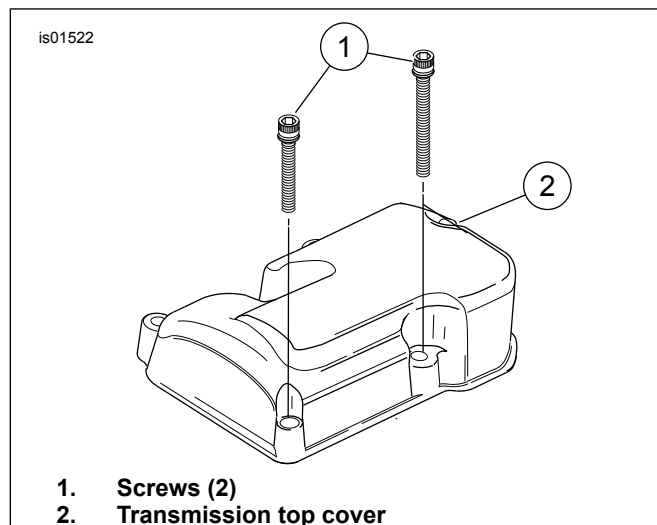

Figure 1. Transmission Top Cover Screws

2. See Figure 2. Carefully slide the new large top cover (1) into place and install as shown with screws (5) saved from Step 1. Tighten screws to 60-72 **in-lbs** (6.8-8.1 Nm).
3. Install small top cover (4) with chrome buttonhead screw (2) and washer (3) from kit. Tighten to 25-32 **in-lbs** (2.8-3.6 Nm).

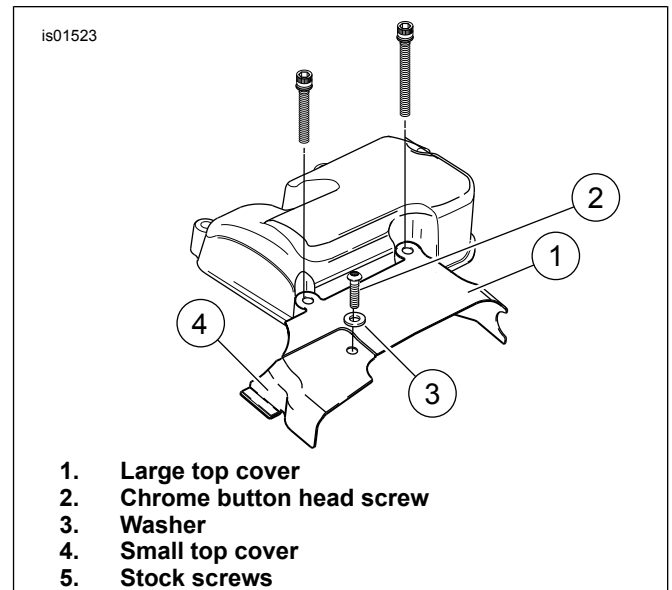

Figure 2. Cover Assembly

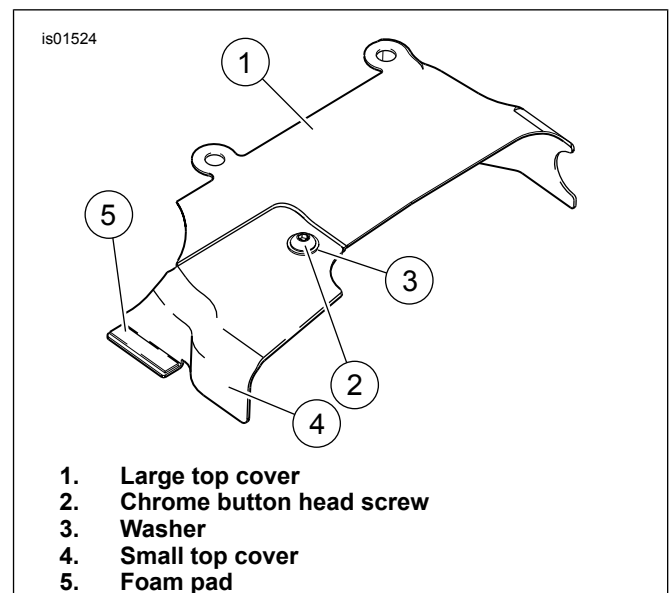

Figure 3. Kit Contents