



# INSTRUCTIONS

J01353

2006-08-21



## ADJUSTABLE PASSENGER FOOTBOARD MOUNTING KIT

### GENERAL

#### Kit Number

50789-99A

#### Models

For the most up-to-date fitment information, please see the product label or [www.harley-davidson.com](http://www.harley-davidson.com).

#### Kit Contents

This kit contains two footboard supports.

There are no Service Parts available with this kit.

### INSTALLATION

1. Remove passenger footboard assemblies from motorcycle. Save all hardware for reinstallation.
2. See Figure 1. Remove footboards (8) from footboard supports (1) by carefully lifting up on the inside corners of the footboard's rubber pad (9) to expose the pivot pins (do not fully remove the footboard pad from the footboard as it would be difficult to reinstall).
3. Remove pivot pins (3) by pushing pins toward the outside of the footboard until the footboard is free of the mounting lugs. Removing the footboard will expose a spring (4) and steel ball (5) in the footboard support. These pieces, as well as the pivot pins, will be re-used when installing the new accessory footboard supports.
4. Install the new footboard supports (1) in the desired height position using the washer (7) and mounting bolt (6) saved from Step 1. Tighten mounting bolts to 30-35 ft-lbs (40.7-47.5 Nm).
5. Install springs (4) into the retaining holes in the footboard supports. Rest steel balls (5) on top of springs.
6. Position each footboard on support being careful not to unseat steel ball.
7. Press down on footboards so that pivot holes align and insert pivot pins (3) through footboard and into the two mounting lugs on footboard support. Check to be certain steel ball is seated in detent on underside of footboards.
8. Push rubber pads back into place being sure pin ends are seated in recesses of rubber pads. Also, be sure the rubber extensions at the extreme outer edges of pad are seated in outside pin holes in footboards.

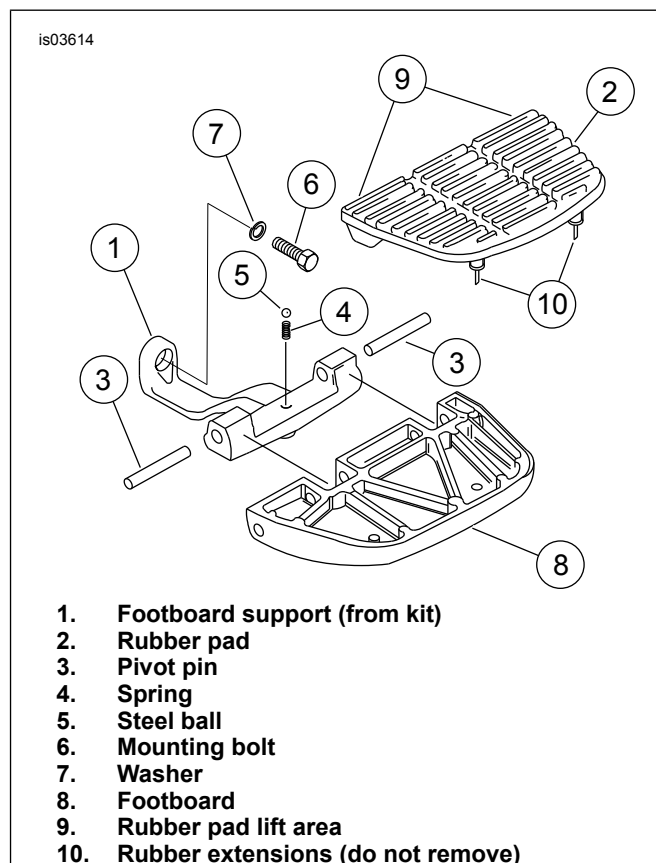

Figure 1. Footboard Mounting