



INSTRUCTIONS

J01370

2013-11-01



CONSOLE WASHER

GENERAL

Kit Numbers

94753-99

Models

For model fitment information, see the P&A retail catalog or the Parts and Accessories section of www.harley-davidson.com (English only).

Kit Contents

Table 1. Kit Contents

Description	Part Number
Console washer	Not sold
Screw, 3/4 in., used on FLHR only	Not sold
Screw, 1 in., used on Softail only	Not sold
Bar and Shield hole plug	94754-99

NOTE

All Service Parts available for this kit are listed above.

INSTALLATION

1994 and later Road King Models

1. See Figure 1. Remove the stock washer and bolt from the location shown. Discard hardware.
2. Install new console washer with 3/4 inch screw as shown.
3. Snap bar and shield hole plug into place over screw head.

1984 and later Softail Models

1. See Figure 2. Remove the stock washer and bolt from the location shown. Discard hardware.
2. Install new console washer with 1 inch screw as shown.
3. Snap bar and shield hole plug into place over screw head.

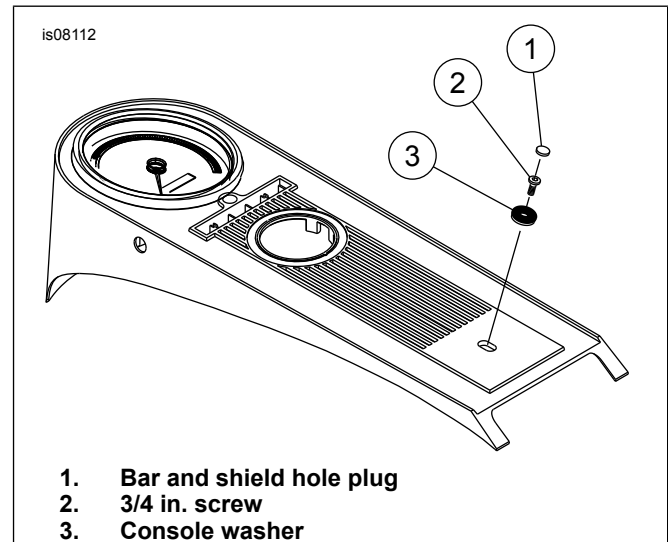

Figure 1. Installation on FLHR Instrument Panel

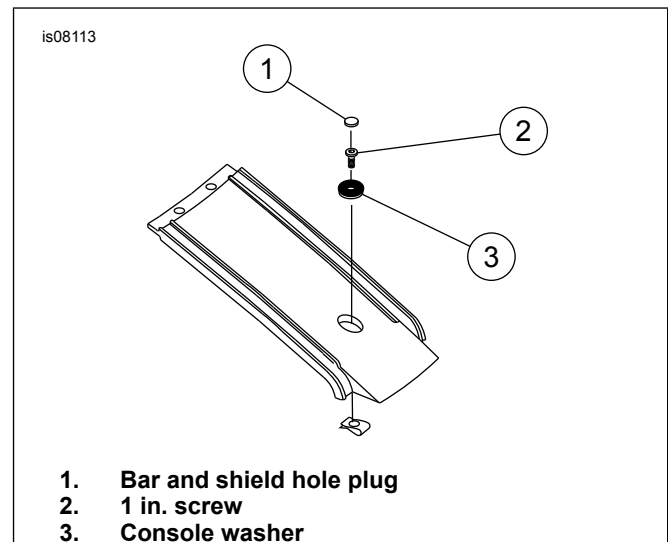

Figure 2. Installation on Softail Tank Panel