



# INSTRUCTIONS

J04054

2012-07-16



## FRONT DETONATOR WHEELS

### GENERAL

#### ⚠ WARNING

Install only wheels and installation kits approved for your model motorcycle. Contact a Harley-Davidson dealer to verify fitment. Mismatching wheels and installation kits or installing wheels not approved for your model can cause loss of control, which could result in death or serious injury. (00610c)

### Kit Number

44550-07, 44552-08, 44660-07, 44661-07 and 44556-07

### Models

For model fitment information, see the P&A Retail Catalog or the Parts and Accessories section of [www.harley-davidson.com](http://www.harley-davidson.com) (English only).

#### NOTE

Accessory hub caps are not compatible with this wheel.

### Kit Contents

See Figure 1 and Service Parts Tables.

### Additional Parts Required

These kits include the custom wheel only. Some kits also include a hub cap.

Proper installation of these kits require the separate purchase of the following parts which are available at a Harley-Davidson dealer.

- Wheel Installation Kit (See Table 2 and Table 8 to determine required installation kit.)
- 10 Brake Disc/Hub Cap Screws (3655A) or 2 Chrome screw kits (46646-05)
- Wheel Bearing Remover and Installer (94134-09A)

The following Harley-Davidson Genuine Motor Accessories are recommended for proper maintenance and cleaning:

- Harley® Bright™ Chrome Cleaner (94683-99)
- Harley® Glaze™ Polish and Sealant (99701-84)
- Harley® Wheel and Spoke Brush (43078-99)
- Harley-Davidson® Wheel and Tire Cleaner (94658-98)
- Harley® Preserve™ Bare Aluminum Protectant (99845-07)

#### ⚠ WARNING

Rider and passenger safety depend upon the correct installation of this kit. Use the appropriate service manual procedures. If the procedure is not within your capabilities or you do not have the correct tools, have a Harley-Davidson dealer perform the installation. Improper installation of this kit could result in death or serious injury. (00333b)

#### NOTE

This instruction sheet references service manual information. A service manual for your model motorcycle is required for this installation and is available from a Harley-Davidson dealer.

### INSTALLATION

1. Remove existing front wheel assembly. Save axle, axle nut, brake disc and wheel spacers for kit installation. Discard moon-style hub cap on FLSTC and FLSTN models. Discard left side spacer on FXSTS models and tapered spacer on FXSTD models. Refer to FRONT WHEEL in service manual. **For FLSTC and FLSTN Models:** Discard moon-style hub cap.

#### NOTE

Install long valve stem (43206-01) included in the installation kit. Discard all other valve stems.

#### NOTICE

**Do not re-use brake disc/rotor screws. Re-using these screws can result in torque loss and damage to brake components. (00319c)**

2. See Figure 1. Install valve stem assembly (M) on wheel. Refer to TIRES in service manual.
3. Assemble wheel installation kit components and brake disc(s) to wheel, using the appropriate service parts table. Refer to FRONT WHEEL in Service Manual.

#### NOTE

Install primary bearing first using the applicable service manual and WHEEL BEARING REMOVER/INSTALLER.

**Kit 44550-07:** The left side of the wheel has a groove machined in the hub to identify it as the disc side for installation, as well as the primary bearing side. The wheel should be installed so that the valve stem is on the right side of the motorcycle.

**Kits 44660-07 and 44661-07:** The wheel should be installed so that the hub markings are on the left side of the motorcycle. An arrow engraved into the rim of 44661-07 indicates the direction of rotation. A groove is machined in the left-side hub face to indicate the primary bearing side.



- **Dual-disc models:** Install the brake discs according to the service manual procedures. The Chrome hub cap (2) is not used.
- **Single-disc models:** Install the brake disc according to the service manual procedures. Install the chrome hub cap (2) on the side opposite the brake disc.

**Kit 44660-07:** The gross axle weight rating is unaffected by the installation of this wheel on a vehicle originally equipped with 21-inch wheels.

**Kit 44661-07:** The gross axle weight rating is unaffected by the installation of this wheel on a vehicle originally equipped with 19-inch wheels.

**Kit 44552-08:** The left side of the wheel has a groove machined in the hub to identify it as the left side for installation, as well as the primary bearing side. The wheel should be installed so that the valve stem is on the right side of the motorcycle.

**Kit 44556-07:** The right side of the wheel has a groove machined in the hub to identify it as the right side for installation. There is an arrow on the left side of the hub to indicate the direction of rotation.

- *For 2006 and later FXDWG Models:* When correctly installed, the tire will be 2–5 mm (0.08–0.2 in) off of center, compared to the fender.

- **For all 2006 and earlier FXST, FXSTS, FXSTB, FXSTD Models and 2007 and earlier FXDWG Models:** The right side is the primary bearing side .
  - **For 2007 and later FXST, FXSTB, FXSTC, FXSTD Models and 2008 and later FXDWG Models:** The left side is the primary bearing side .
4. *For FLSTC and FLSTN models:* Install wheel kit and right hand wheel spacer provided in the kit. **For FXSTD Models:** Install wheel kit and axle spacer (G) provided in the kit. **For FXSTS Models:** Install wheel kit, stock axle spacers and axle spacer (H) between the fork and left side axle spacer. The right side is the brake disc side. *All other models:* Install wheel spacers previously removed.
  5. Install front wheel (1), stock axle and stock axle nut. Refer to FRONT WHEEL in service manual.

## MAINTENANCE AND CLEANING

Chrome parts must be maintained regularly to keep their original shine and luster.

1. Clean heavily-soiled wheel surfaces using Harley-Davidson Wheel and Tire Cleaner, applied with Harley Wheel and Spoke Brush.
2. Thoroughly clean chrome with a good quality chrome cleaner, such as Harley Bright Chrome Cleaner.
3. After cleaning and polishing, seal the finish with a good quality sealer, such as Harley Glaze Polish and Sealant.

## SERVICE PARTS

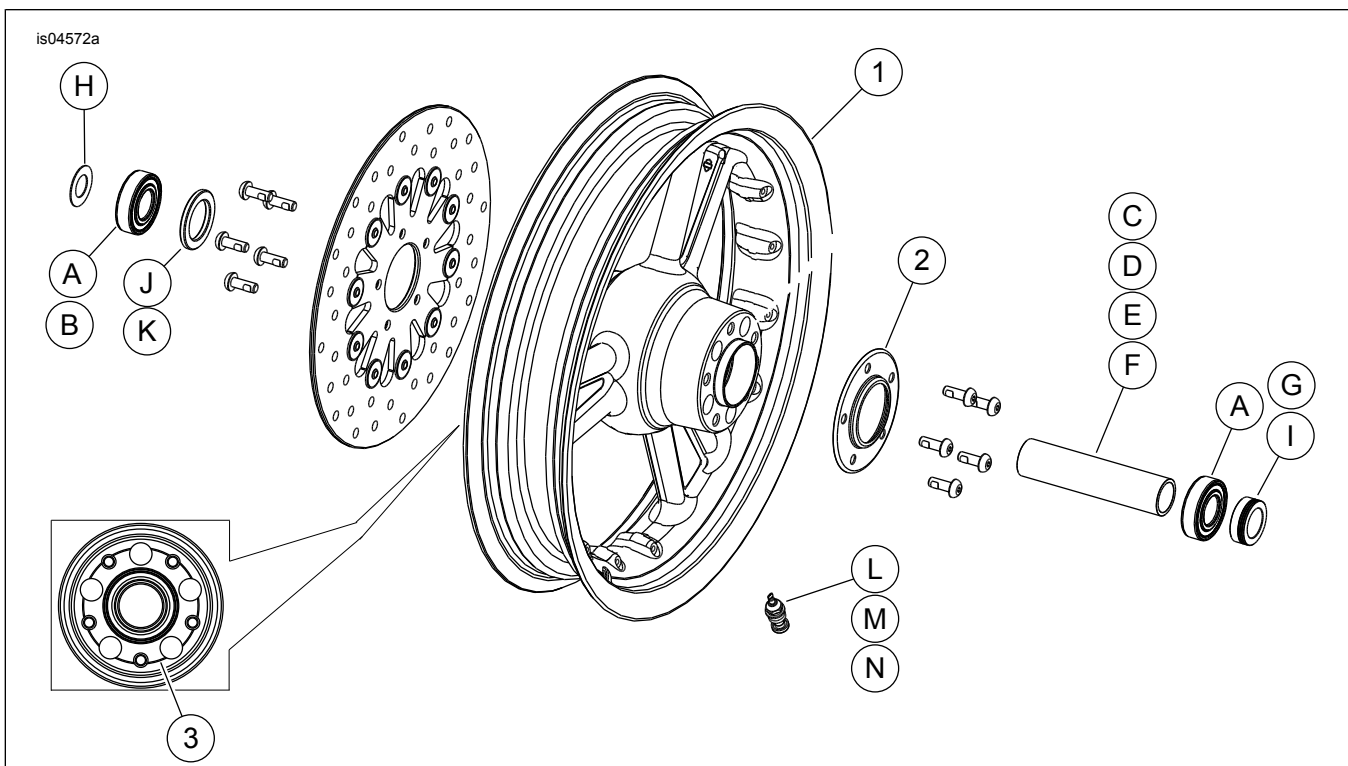

Figure 1. Service Parts: Front Detonator Wheels (16-inch wheel shown)

Table 1. Service Parts and Wheel Kit Contents

Kit	Item	Description (Quantity)	Part Number
44552-08	1	Wheel	Not Sold Separately
44550-07	1	Wheel	Not Sold Separately
	2	Hub cap	44920-05

**Table 1. Service Parts and Wheel Kit Contents**

Kit	Item	Description (Quantity)	Part Number
44660-07, 44661-07, 44556-07	1	Wheel	Not Sold Separately
	2	Hub cap	44921-05
Visual indicator mentioned in text:			
	3	Machined groove (all wheels)	

**Table 2. FRONT 3/4 Inch Bearing Wheel Installation Kit (43833-07A)**

FRONT 3/4 Inch Bearing Wheel Installation Kit (43833-07A)		ITEM (Quantity Used and Description)									
Fitment	Wheel Size	A	C	D	E	G	H	I	L	M	
2000-2006 FLST and FLSTF (except 2006 FLSTFSE2)	16 x 3.0 in	2	0	1	0	0	0	0	*	*	
2000-2006 FLSTC and FLSTN	16 x 3.0 in	2	0	1	0	0	0	1	*	*	
2006 FLSTFSEi	17 x 3.5 in	2	0	1	0	0	0	1	*	*	
2008-later FLSTSB	18 x 3.5 in	2	0	***	0	***	0	0	*	*	
2000-2007 XL; 2000-2003 Dyna (except FXDWG)	19 x 2.5 in	2	0	0	1	0	0	0	*	*	
2000-2007 XL; 2000-2003 Dyna (except FXDWG)	21 x 2.15 in	2	0	0	1	0	0	0	*	*	
2000-2006 FXST/B/C; 2000-2005 FXDWG**	21 x 2.15 in	2	1	0	0	0	0	0	*	*	
2000-2006 FXSTS**	21 x 2.15 in	2	1	0	0	0	1	0	*	*	
2000-2006 FXSTD (Except FXSTDSE)**	21 x 2.15 in	2	1	0	0	1	0	0	*	*	
Installation kits are designed to work with many different wheel styles and fitments. Contact a Harley-Davidson dealer to verify that the wheel and installation kits are both designed and approved for the motorcycle they are being installed on. NOTES: * See NOTE above valve installation step in INSTALLATION to determine which valve stem to use for your particular kit. Discard other valve stem(s). ** The right side of the wheel is the primary bearing side for this fitment. *** See INSTALLATION section for separate hardware kit to be used for FLSTSB models.	A	Bearing, regular (2)						9267			
	C	Axle sleeve						43536-00			
	D	Axle sleeve						43608-00			
	E	Axle sleeve						43613-00			
	G	Spacer, axle						40910-00A			
	H	Spacer, axle						43313-98			
	I	Spacer, wheel						43617-00A			
L	Valve stem, short						43157-83A				
M	Valve stem, long						43206-01				

**Table 3. FRONT 1 Inch Bearing Wheel Installation Kit (43848-08A)**

FRONT 1 Inch Bearing Wheel Installation Kit (43848-08A)		ITEM (Quantity Used and Description)							
Fitment	Wheel Size	A	C	D	E	F	L	M	
2000-2007 Touring	16 x 3.0 in	2	1	0	0	0	*	*	
2004-2007 Touring	18 x 3.5 in	2	1	0	0	0	*	*	
2004-2005 Dyna (except FXDWG)	19 x 2.5 in	2	0	0	0	1	*	*	
2006-2007 Dyna (except FXDWG)	19 x 2.5 in	2	0	0	1	0	*	*	
2002-2007 VRSC	19 x 3.0 in	2	0	0	1	0	*	*	
2006-2007 FXDWG**	21 x 2.15 in	2	0	1	0	0	*	*	
2004-2005 Dyna (except FXDWG)	21 x 2.15 in	2	0	0	0	1	*	*	
Installation kits are designed to work with many different wheel styles and fitments. Contact a Harley-Davidson dealer to verify that the wheel and installation kits are both designed and approved for the motorcycle they are being installed on. NOTES: * See NOTE above valve installation step in INSTALLATION to determine which valve stem to use for your particular kit. Discard other valve stem(s). ** The right side of the wheel is the primary bearing side for this fitment.	A	Bearing, regular (2)						9247	
	C	Axle sleeve						43517-00	
	D	Axle sleeve						43633-06	
	E	Axle sleeve						43641-01	
	F	Axle sleeve						43755-04	
	L	Valve stem, short						43157-83A	
	M	Valve stem, long						43206-01	

**Table 4. FRONT 25 mm Bearing Wheel Installation Kit (41452-08C)**

FRONT 25 mm Bearing Wheel Installation Kit (41452-08C)		ITEM (Quantity Used and Description)									
Fitment	Wheel Size	A	C	D	E	J	K	L	M	N	
2010 and later XL1200X; 2011 and later XL1200C	16 x 3.0 in	2	0	0	1	0	0	*	*	*	
2008 and later FXCW and FXCWC (non-ABS)	19 x 2.5 in	2	1	0	0	1	0	*	*	*	
2008 and later FXCW and FXCWC (non-ABS)	19 x 2.15 in	2	1	0	0	0	0	*	*	*	
2008 and later XL (except XL1200X and 2011 and later XL883L)	19 x 2.5 in	2	0	1	0	0	1	*	*	*	
2008 and later XL (except XL1200X and 2011 and later XL883L)	21 x 2.15 in	2	0	1	0	0	1	*	*	*	
Installation kits are designed to work with many different wheel styles and fitments. Contact a Harley-Davidson dealer to verify that the wheel and installation kits are both designed and approved for the motorcycle they are being installed on. NOTES: * See NOTE above valve installation step in INSTALLATION to determine which valve stem to use for your particular kit. Discard other valve stem(s). ** Bearing shim installed under the primary bearing.	A	Bearing, regular (2)						9276			
	C	Axle sleeve						41548-08			
	D	Axle sleeve						43906-08			
	E	Axle sleeve						11888			
	J	Bearing shim**						41448-08			
	K	Bearing shim**						43315-07			
	L	Valve stem, short						43157-83A			
	M	Valve stem, long						43206-01			
N	Valve stem, pull thru						40999-87				

**Table 5. FRONT 25 mm Bearing Wheel Installation Kit (41455-08C)**

FRONT 25 mm Bearing Wheel Installation Kit (41455-08C)		ITEM (Quantity Used and Description)							
Fitment	Wheel Size	A	C	D	J	K	L	M	N
2008 Touring; 2009 and later FLHRC (non-ABS) and Trike (non-ABS)	16 x 3.0 in	2	0	1	0	1	*	*	*
2009 and later Touring (non-ABS)	17 x 3.0 in	2	0	1	0	0	*	*	*
2008 and later Touring (non-ABS)	18 x 3.5 in	2	0	1	0	**	*	*	*
2008 and later Dyna (except FLD, FXDWG and FXDF)	19 x 2.5 in	2	1	0	**	0	*	*	0
2008 and later VRSCAW, VRSCD, VRSCF and VRSCDX (non-ABS)	19 x 3.0 in	2	1	0	**	0	*	*	0
2009 and later Touring (non-ABS)	19 x 3.5 in	2	0	1	0	0	*	*	*
Installation kits are designed to work with many different wheel styles and fitments. Contact a Harley-Davidson dealer to verify that the wheel and installation kits are both designed and approved for the motorcycle they are being installed on. NOTES: * See NOTE above valve installation step in INSTALLATION to determine which valve stem to use for your particular kit. Discard other valve stem(s). ** See NOTES for your wheel kit above the wheel assembly step in INSTALLATION to determine if bearing shim is used for your particular wheel kit and fitment. *** Bearing shim installed under the primary bearing.	A	Bearing, regular (2)		9276					
	C	Axle sleeve		41748-08					
	D	Axle sleeve		41900-08					
	J	Bearing shim***		41450-08					
	K	Bearing shim***		43903-08					
	L	Valve stem, short		43157-83A					
	M	Valve stem, long		43206-01					
N	Valve stem, pull thru		40999-87						

**Table 6. FRONT 25 mm Bearing Wheel Installation Kit (43851-11A)**

FRONT 25 mm Bearing Wheel Installation Kit (43851-11A)		ITEM (Quantity Used and Description)							
Fitment	Wheel Size	A	C	G	H	J	L	M	N
2007 and later FLSTC, FLSTN and FLS (non-ABS)	16 x 3.0 in	2	1	0	1	1	*	*	*
2008 and later FXDF	16 x 3.0 in	2	1	0	0	0	*	*	*
2007 and later FLSTF and FLSTFB (non-ABS)	17 x 3.5 in	2	1	0	0	0	*	*	*
2008 and later FLSTF and FLSTFB (non-ABS)	18 x 3.5 in	2	1	0	0	0	*	*	*
2008 and later FXDF; 2012 and later FLD	18 x 3.5 in	2	1	0	0	0	*	*	*
2007 and later FXS, FXST/B/C (non-ABS); 2008 and later FXDWG***	21 x 2.15 in	2	1	0	0	1	*	*	*
2007 FXSTD***	21 x 2.15 in	2	1	1	0	1	*	*	*
Installation kits are designed to work with many different wheel styles and fitments. Contact a Harley-Davidson dealer to verify that the wheel and installation kits are both designed and approved for the motorcycle they are being installed on. NOTES: * See NOTE above valve installation step in INSTALLATION to determine which valve stem to use for your particular kit. Discard other valve stem(s). ** Bearing shim installed under the primary bearing. *** The left side of the wheel is the primary bearing side for this fitment.	A	Bearing, regular (2)		9276					
	C	Axle sleeve		41349-07					
	G	Spacer, axle		41504-07					
	H	Spacer, axle		41695-07					
	J	Bearing shim**		43315-07					
	L	Valve stem, short		43157-83A					
	M	Valve stem, long		43206-01					
N	Valve stem, pull-thru		40999-87						

**Table 7. FRONT 25 mm Bearing ABS Wheel Installation Kit (41454-08B)**

FRONT 25 mm Bearing ABS Wheel Installation Kit (41454-08B)		ITEM (Quantity Used and Description)								
Fitment	Wheel Size	A	B	C	D	J	K	L	M	N
2008 Touring and 2009 and later FLHRC with ABS	16 x 3.0 in	1	1	0	1	0	1	*	*	0
2009 and later Touring with ABS	17 x 3.0 in	1	1	0	1	0	0	*	*	*
2008 and later Touring with ABS	18 x 3.5 in	1	1	0	1	**	**	*	*	*
2012 and later Dyna with ABS (Except FLD, FXDWG and FXDF)	19 x 2.5 in	1	1	1	0	**	**	*	*	0
2008 and later VRSCAW, VRSCD, VRSCF and VRSCDX with ABS	19 x 3.0 in	1	1	1	0	**	**	*	*	0
2009 and later Touring with ABS	19 x 3.5 in	1	1	0	1	0	0	*	*	*
Installation kits are designed to work with many different wheel styles and fitments. Contact a Harley-Davidson dealer to verify that the wheel and installation kits are both designed and approved for the motorcycle they are being installed on. NOTES: * See NOTE above valve installation step in INSTALLATION to determine which valve stem to use for your particular kit. Discard other valve stem(s). ** See NOTES for your wheel kit above the wheel assembly step in INSTALLATION to determine which bearing shim to use for your particular wheel kit and fitment. *** Red side of bearing must be installed toward the wheel. The ABS bearing is primary. **** Bearing shim installed under the primary bearing.	A	Bearing, regular		9276						
	B	Bearing, ABS***		9252						
	C	Axle sleeve		41748-08						
	D	Axle sleeve		41900-08						
	J	Bearing shim****		41450-08						
	K	Bearing shim****		43903-08						
	L	Valve stem, short		43157-83A						
M	Valve stem, long		43206-01							
N	Valve stem, pull thru		40999-87							

**Table 8. FRONT 25 mm Bearing ABS Wheel Installation Kit (43093-11A)**

FRONT 25 mm Bearing ABS Wheel Installation Kit (43093-11A)		ITEM (Quantity Used and Description)										
Fitment	Wheel Size	A	B	C	D	G	J	K	L	M	N	
2011 and later FLSTC, FLSTN and FLS with ABS	16 x 3.0 in	1	1	1	0	1	0	1	*	*	*	
2012 and later FXDF with ABS	16 x 3.0 in	1	1	1	0	0	0	0	*	*	*	
2011 and later FLSTF and FLSTFB with ABS	17 x 3.5 in	1	1	1	0	0	0	0	*	*	*	
2011 and later FLSTF and FLSTFB with ABS	18 x 3.5 in	1	1	1	0	0	0	0	*	*	*	
2012 and later FXDF and FLD with ABS	18 x 3.5 in	1	1	1	0	0	0	0	*	*	*	
2011 and later FXCWC with ABS	19 x 2.15 in	1	1	0	1	0	0	0	*	*	*	
2011 and later FXCWC with ABS	19 x 2.5 in	1	1	0	1	0	1	0	*	*	*	
2011 and later FXS, FXST and 2012 and later FXDWG with ABS	21 x 2.15 in	1	1	1	0	0	0	1	*	*	*	
Installation kits are designed to work with many different wheel styles and fitments. Contact a Harley-Davidson dealer to verify that the wheel and installation kits are both designed and approved for the motorcycle they are being installed on. NOTES: * See <i>NOTE</i> above valve installation step in INSTALLATION to determine which valve stem to use for your particular kit. Discard other valve stem(s). ** Red side of bearing must be installed toward the wheel. The ABS bearing is the primary bearing. *** Bearing shim installed under the primary bearing.	A	Bearing, regular							9276			
	B	Bearing, ABS**							9252			
	C	Axle sleeve							41349-07			
	D	Axle sleeve							41548-08			
	G	Spacer							41695-07			
	J	Bearing shim***							41448-08			
	K	Bearing shim***							43315-07			
	L	Valve stem, short							43157-83A			
	M	Valve stem, long							43206-01			
	N	Valve stem, pull-thru							40999-87			