



INSTRUCTIONS

J04154

2006-05-31



SOFTAIL SEAT KIT

GENERAL

Kit Number

51401-07

Models

This kit fits 2007 and later FXSTC models. Also fits 2007-later FLSTF and 2006-later FX Softail models (except FXSTD) with the separate purchase of additional components.

Additional Parts Required

2007 FLSTF and 2006-later FX Softail models require the separate purchase of FXSTC Sissy Bar Upright 51849-07 and four screws (4598).

⚠ WARNING

Rider and passenger safety depend upon the correct installation of this kit. Use the appropriate service manual procedures. If the procedure is not within your capabilities or you do not have the correct tools, have a Harley-Davidson dealer perform the installation. Improper installation of this kit could result in death or serious injury. (00333b)

NOTE

This instruction sheet references Service Manual information. A Service Manual for your model motorcycle is required for this installation and is available from a Harley-Davidson dealer.

Kit Contents

See Figure 3 and Table 1.

INSTALLATION

FX Softail Models

NOTE

When installing this kit, avoid scratching painted surfaces (fender, tank, etc.) with tools or metal seat tabs.

1. Remove seat according to the instructions in the Service Manual. Discard hardware.
2. Remove and discard existing grabstrap and mounting hardware.
3. See Figure 3. Install grabstrap (1) from kit using screw (2) and washer (3). See Figure 1. Line up holes on grabstrap as shown.

NOTE

Installation of this seat kit on models not originally equipped with the FXSTC stock sissy bar upright must install the

upright to the vehicle before proceeding with the instructions.

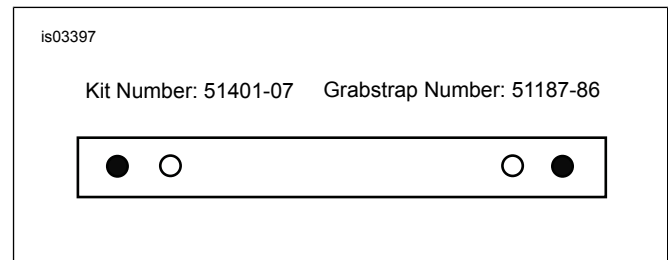

Figure 1. Grabstrap Installation

4. See Figure 3. Slide back of seat (4) through the grabstrap (1) and hook front tab of seat into frame.
5. Remove protective plugs from each threaded stud protruding from the back of the seat.
6. Line up threaded studs with hole in sissy bar upright. Studs can be adjusted to fit through holes.

⚠ WARNING

After installing seat, pull upward on seat to be sure it is locked in position. While riding, a loose seat can shift causing loss of control, which could result in death or serious injury. (00070b)

7. Secure seat to upright using two acorn nuts (5) and washers (6) from kit. Tighten nuts to 60-80 **in-lbs** (6.8-10.2 Nm).

2007 and Later FLSTF Models

1. Remove seat according to the instructions in the Service Manual. Discard hardware.
2. Remove and discard existing grabstrap and mounting hardware.
3. See Figure 2. Install two flange nuts (1) (Table 1, Item 7) from kit onto seat mounting studs.

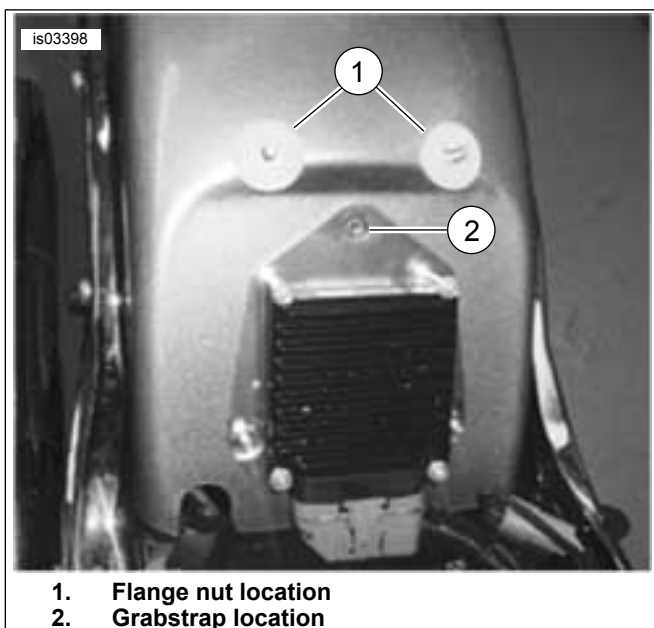

Figure 2. Grabstrap and Flange Nut (FLSTF Models)

4. See Figure 3. Install grabstrap (1) from kit to accessory grabstrap location (Figure 2, Item 2) using screw (2) and washer (3). See Figure 1. Line up holes on grabstrap as shown.
5. See Figure 3. Slide back of seat (4) through the grabstrap (1) and hook front tab of seat into frame.
6. Remove protective plugs from each threaded stud protruding from the back of the seat.
7. Line up threaded studs with hole in sissy bar upright. Studs can be adjusted to fit through holes.

⚠ WARNING

After installing seat, pull upward on seat to be sure it is locked in position. While riding, a loose seat can shift causing loss of control, which could result in death or serious injury. (00070b)

8. Secure seat to upright using two acorn nuts (5) and washers (6) from kit. Tighten nuts to 60-80 in-lbs (6.8-10.2 Nm).

SERVICE PARTS

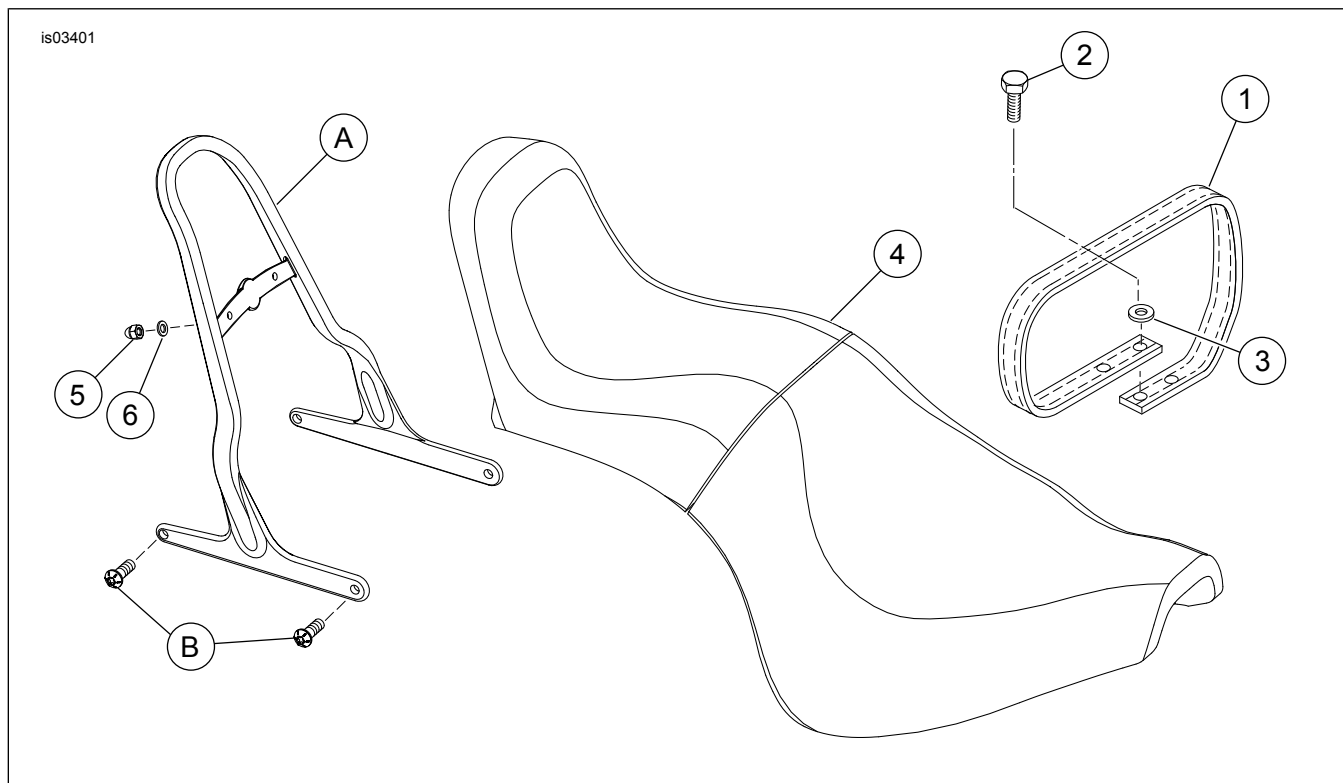

Figure 3. Service Parts: Softail Seat Kit

Table 1. Service Parts: Softail Seat Kit

Item	Description (Quantity)	Part Number
1	Grabstrap	51187-86
2	Screw	3767B
3	Washer	6036
4	Seat	Not Sold Separately
5	Nut, acorn (2)	8084
6	Washer (2)	Not Sold Separately

Table 1. Service Parts: Softail Seat Kit

Item	Description (Quantity)	Part Number
7	Nut, flange (2) (Not Shown)	8021
Items mentioned in text, but not included in kit:		
A	FXSTC sissy bar upright (purchased separately)	51849-07
B	Screw (4) (purchased separately)	4598