



# INSTRUCTIONS

J03726

2005-03-31



## FX SOFTAIL® SEAT KITS

### GENERAL

#### Kit Number

51397-06, 51468-06, 51469-06, 51470-06

#### Models

These kits are designed for installation on 2006 FX Softail models (except FXSTD) and 2006 FLSTFSE2 models.

#### Kit Contents

See Figure 2 and Table 1.

#### Additional Parts Required

2006 FLSTFSE2 models require the separate purchase of Grabstrap Hardware Kit 51831-06, Passenger Footpegs, and Passenger Footpeg Mounting Kit 50210-06.

Installation of Badlander seat kit 51397-06 on 2006 FLSTFSE2 models also require separate purchase of stock rear seat bracket 51798-00 and screw 3588 (2).

### INSTALLATION

#### All models except 2006 FLSTFSE2

##### NOTE

When performing the following installation procedures, avoid scratching painted surfaces (fender, tank, etc.) with tools or metal seat tabs.

1. Remove existing seat from motorcycle by unscrewing seat at rear bracket and unhooking front seat tab. Kit 51397-06 will re-use the stock rear seat bracket. Remove bracket and screws from existing seat and install on new seat.
2. See Figure 2. Remove and discard existing grabstrap and save fastening hardware from the motorcycle.
3. See Figure 2. Install the grabstrap (7) from kit with the hardware saved in Step 2. Install the grabstrap according to Figure 1.

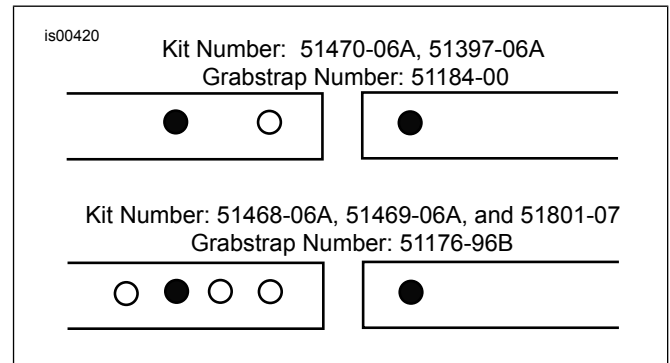

Figure 1. Grabstrap installment information

##### ▲ WARNING

After installing seat, pull upward on seat to be sure it is locked in position. While riding, a loose seat can shift causing loss of control, which could result in death or serious injury. (00070b)

4. See Figure 2. Slide the back of the seat through grabstrap and hook front tab of seat (1) into frame. Secure seat bracket to fender with screw (8).

#### 2006 FLSTFSE2

When installing a 2-up seat onto a vehicle not equipped with passenger footpegs, install Passenger Footpeg Mounting Kit 50210-06 and passenger footpegs (purchased separately).

##### ▲ WARNING

Do not install these seat kits on motorcycles that are not equipped with an appropriate grab strap and passenger footpegs. If footpegs and grab strap are not installed, passenger could fall from moving motorcycle or grab onto operator, causing loss of control and death or serious injury. (00410b)

##### NOTE

This instruction sheet references Service Manual information. A Service Manual for your model motorcycle is required for this installation and is available from a Harley-Davidson Dealer.

##### NOTE

When performing the following installation procedures, avoid scratching painted surfaces (fender, tank, etc.) with tools or metal seat tabs.

1. Refer to the service manual to remove stock seat and chrome tailpiece from the motorcycle.
2. For Kit 51397-06 only: Install rear Seat bracket 51798-00 (2) with mounting screws 3588.



3. See Figure 2. Install the grabstrap (7) from kit using parts from the Grabstrap Hardware kit. See Figure 1 for the grabstrap hole location.

4. See Figure 2. Slide back of seat through grabstrap. Hook front tab of seat (1) into frame and secure seat bracket to fender with screw (8) or fasten screw attached to bracket on seat 51397-06.

**▲ WARNING**

After installing seat, pull upward on seat to be sure it is locked in position. While riding, a loose seat can shift causing loss of control, which could result in death or serious injury. (00070b)

**SERVICE PARTS**

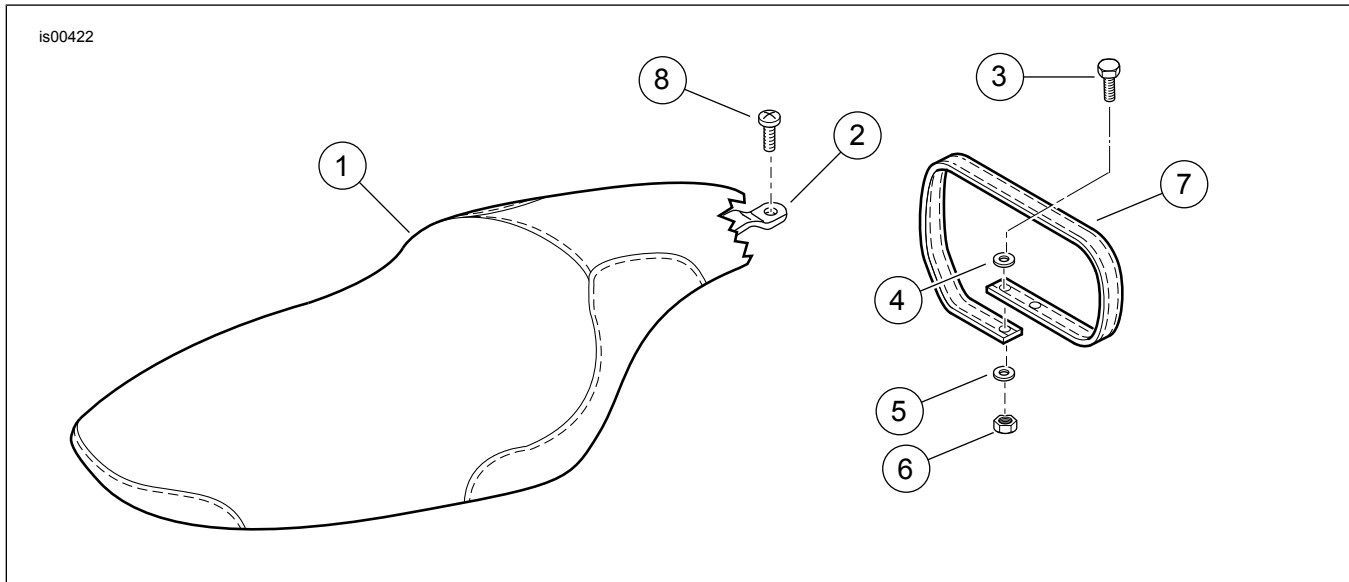

**Figure 2. Service Parts: FX Softail Seats**

**Table 1. Service Parts Table**

Item	Description (Quantity)	Part Number	Item	Description (Quantity)	Part Number
1	Seat (Generic style shown)	Not Sold Separately	7	Grabstrap in 51397-06	51184-00
2	Bracket (Kit 51397-06 uses stock seat bracket 51798-00)	51467-06		Grabstrap in 51468-06	51176-96B
3	Screw	3767B		Grabstrap in 51469-06	51176-96B
4	Washer	6036		Grabstrap in 51470-06	51184-00
5	Retention washer	7489A	8	Screw, rear seat bracket	2952A
6	Retention nut	7488			