



INSTRUCTIONS

J03350

2013-11-01



SPORTSTER HAND GRIPS

GENERAL

Kit Numbers

56735-04, 56799-04

Models

For model fitment information, see the P&A retail catalog or the Parts and Accessories section of www.harley-davidson.com (English only).

⚠ WARNING

Rider and passenger safety depend upon the correct installation of this kit. Use the appropriate service manual procedures. If the procedure is not within your capabilities or you do not have the correct tools, have a Harley-Davidson dealer perform the installation. Improper installation of this kit could result in death or serious injury. (00333b)

NOTE

This instruction sheet references Service Manual information. A Service Manual for your model motorcycle is required for this installation and is available from a Harley-Davidson Dealer.

Kit Contents

See Figure 2 and Table 1.

Remove and Install the Left Grip

1. See Figure 1. Using a T27 TORX® drive head, remove the two screws with flat washers securing the handlebar clamp (3) to the clutch lever bracket. Remove the clamp and position the clutch hand lever assembly away from the handlebar.
2. Using a T25 TORX® drive head, loosen but do not remove the upper and lower switch housing screws (1).
3. Remove the end cap from the existing left handlebar grip if so equipped. Remove the grip by carefully cutting it away from the handlebar using a sharp blade or knife.

NOTE

Make sure that the handlebar surface and the inside of the grip are smooth, dry and thoroughly cleaned of all dirt or adhesive residue.

⚠ WARNING

Do not lubricate left handlebar grip before installation. Lubricating grip can cause it to come off while riding, which could result in loss of control and death or serious injury. (00315a)

4. Position the new left grip (4) so the larger flange (5) is at the bottom. Push the grip fully onto the handlebar.
5. Fit the grooves (2) on the outboard side of the upper and lower switch housing over the flanges on the end of the grip, then loosely fasten the two screws.
6. Position the clutch hand lever assembly inboard of the switch housing assembly, engaging the tab on the lower switch housing in the groove at the bottom of the clutch lever bracket.
7. Align the holes in the handlebar clamp with those in the clutch lever bracket, and loosely fasten the two screws with flat washers. Adjust the switch housing and clutch hand control position for rider comfort.
8. Using a T27 TORX® drive head, tighten first the upper, then the lower handlebar clamp screws to 60-80 in-lbs (6.8-9.0 Nm).

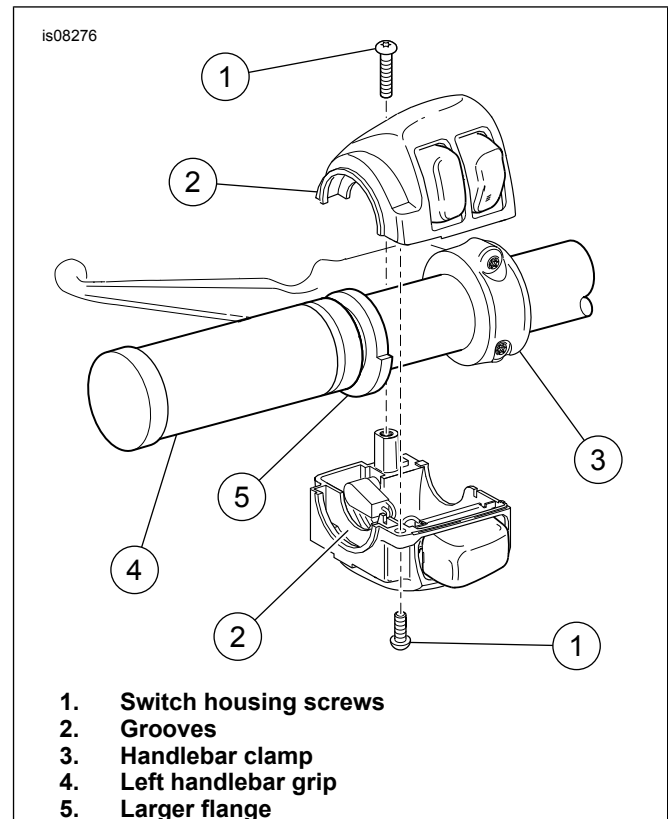

Figure 1. Left Handlebar Switch Housing

9. Using a T25 TORX® drive head, tighten first the lower, then the upper switch housing screws to 35-45 in-lbs (4.0-5.1 Nm).



Remove and Install the Right Grip

- 1. See the Service Manual. Remove the right handlebar switch housing assembly. This is necessary to access the throttle cables.
- 2. See the Service Manual. Disconnect the throttle cables and remove the existing right grip/throttle sleeve assembly. After removal, make sure that the handlebar end is clean and smooth.

- 3. See the Service Manual. Install the new right grip/throttle sleeve to the handlebar and connect the throttle cables.
- 4. Verify that the right grip/throttle sleeve rotates and returns freely and does not bind on the handlebar or switch housing.

Service Parts

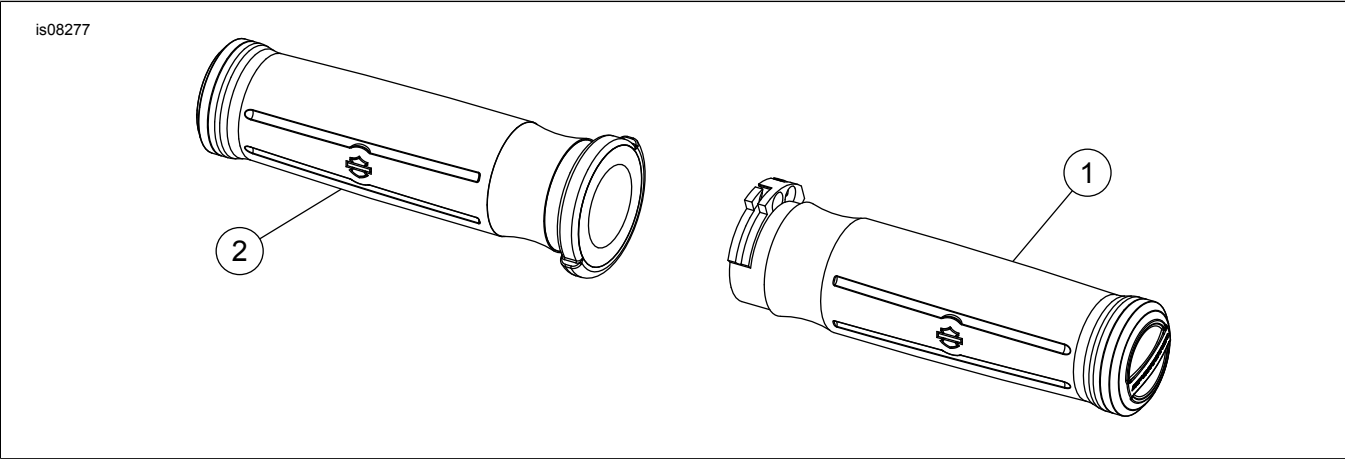

Figure 2. Service Parts

Table 1. Service Parts

Item	Description (Quantity)	Part Number
Kit Number 56735-04		
1	Right grip/throttle sleeve (with end cap)	56795-04
2	Left grip (with end cap)	56796-04
Kit Number 56799-04		
1	Right grip/throttle sleeve (with end cap)	56797-04
2	Left grip (with end cap)	56798-04
Note: Each grip comes with an end cap and is non-removable and bonded.		