



INSTRUCTIONS

J01917

2006-11-07



CHROME FRONT WHEEL SPACERS FOR TOURING MODELS

GENERAL

Kit Number

41610-02

Models

For model fitment information, please see the P&A Retail Catalog or the Parts and Accessories section of www.harley-davidson.com (English only).

Additional Parts Required

⚠ WARNING

Rider and passenger safety depend upon the correct installation of this kit. Use the appropriate service manual procedures. If the procedure is not within your capabilities or you do not have the correct tools, have a Harley-Davidson dealer perform the installation. Improper installation of this kit could result in death or serious injury. (00333b)

Permatex[®] Anti-seize Lubricant, Harley-Davidson Part Number 98960-97, is available from a Harley-Davidson Dealer.

Kit Contents

See Figure 3, and Table 1

REMOVAL

1. Block motorcycle underneath frame so front wheel is raised off the ground.
2. Use shop rag or tape to protect fender area adjacent to caliper, as contact can occur during caliper removal.
3. See Figure 1. Remove both the upper and lower mounting bolts from lugs of front fork leg to release brake caliper assembly.
4. Lift caliper upward to remove from brake disc. Allow the caliper to hang loose.
5. Repeat Steps 1 through 3 to release caliper on opposite side of wheel.

NOTE

Do not operate the front brake lever with the front wheel removed or the caliper piston(s) may be forced out of the piston bore(s). Re-seating the piston(s) requires disassembly of the caliper.

6. Insert screwdriver or steel rod through hole in axle on right side of vehicle. While holding axle stationary, remove the axle nut, lockwasher and flat washer on the left side.
7. Loosen the two axle holder nuts at bottom of right side fork leg.

8. With a soft mallet, tap axle toward right side of vehicle until loose. Catching external spacers on left and right side, pull axle from hub.

NOTE

When performing the following procedures on 2000 and later models, leave the bearing assemblies in place.

9. Remove and discard the stock wheel spacers.

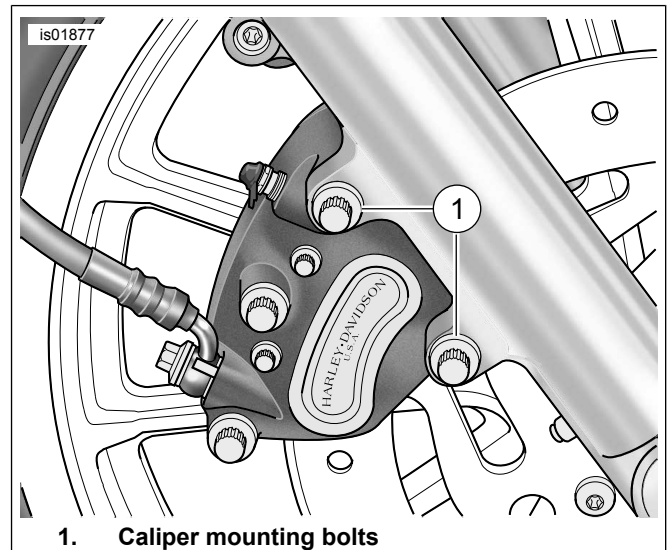

Figure 1. Caliper Mounting Bolts (Right Side)

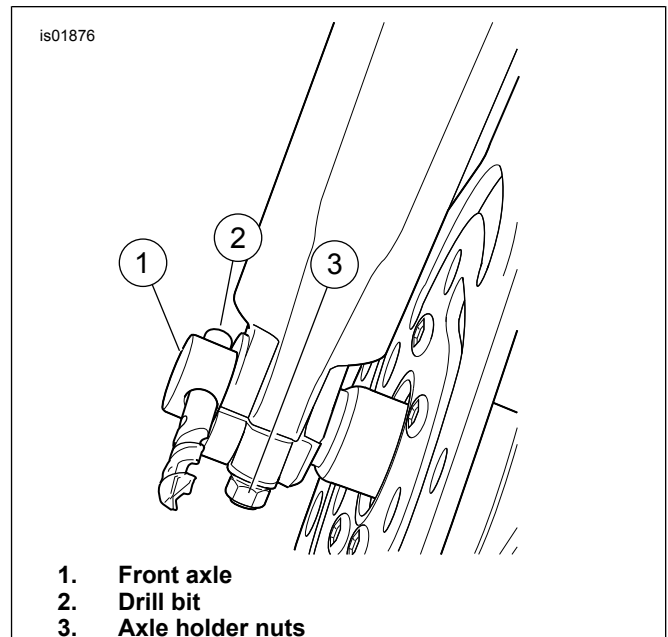

Figure 2. Front Wheel Mounting (Right Side)

INSTALLATION

1. See Figure 3. and Table 1. Place wheel into position between forks with the valve stem on the right side of the vehicle.
2. Apply a light coat of Permatex[®] Anti-seize Lubricant to the axle.
3. Supporting wheel, insert threaded end of axle through right fork leg. Push axle through fork, SHORT external spacer and wheel hub until it begins to emerge from left side.
4. Push axle through LONG external spacer and left fork leg until axle shoulder contacts external spacer on right fork side.
5. Install flat washer, lockwasher and axle nut.
6. Insert screwdriver or steel rod through hole in axle on right side of vehicle. While holding axle stationary, tighten axle nut to 68–75 N·m (50–55 ft-lbs).
7. See Figure 2. Insert 7/16 inch drill bit into hole in axle.
8. Pull fork leg so that it just contacts drill bit, and then tighten axle holder nuts to 14.9–20.3 N·m (132–180 in-lbs).
9. Remove drill bit from axle hole.

10. Install brake caliper as follows:

- a. Use shop rag or tape to protect fender area adjacent to caliper, as contact can occur during caliper installation.
- b. With the bleeder valve topside, position caliper so that brake disc is situated between friction pads. Pry inner and outer brake pads back for additional clearance, if necessary.
- c. Align upper mounting hole in caliper mounting bolt into lower lug of fork leg. Tighten lower mounting bolt to 38–51.5 N·m (28–38 ft-lbs).
- d. Install short caliper mounting bolt into lower lug of fork leg. Tighten lower mounting bolt to 38–51.5 N·m (28–38 ft-lbs).
- e. Repeat Step 10 to install caliper on opposite side of wheel.

▲ WARNING

Whenever a wheel is installed and before moving the motorcycle, pump brakes to build brake system pressure. Insufficient pressure can adversely affect brake performance, which could result in death or serious injury. (00284a)

11. Depress front brake hand lever several times to set brake pads to proper operating position within caliper.

SERVICE PARTS

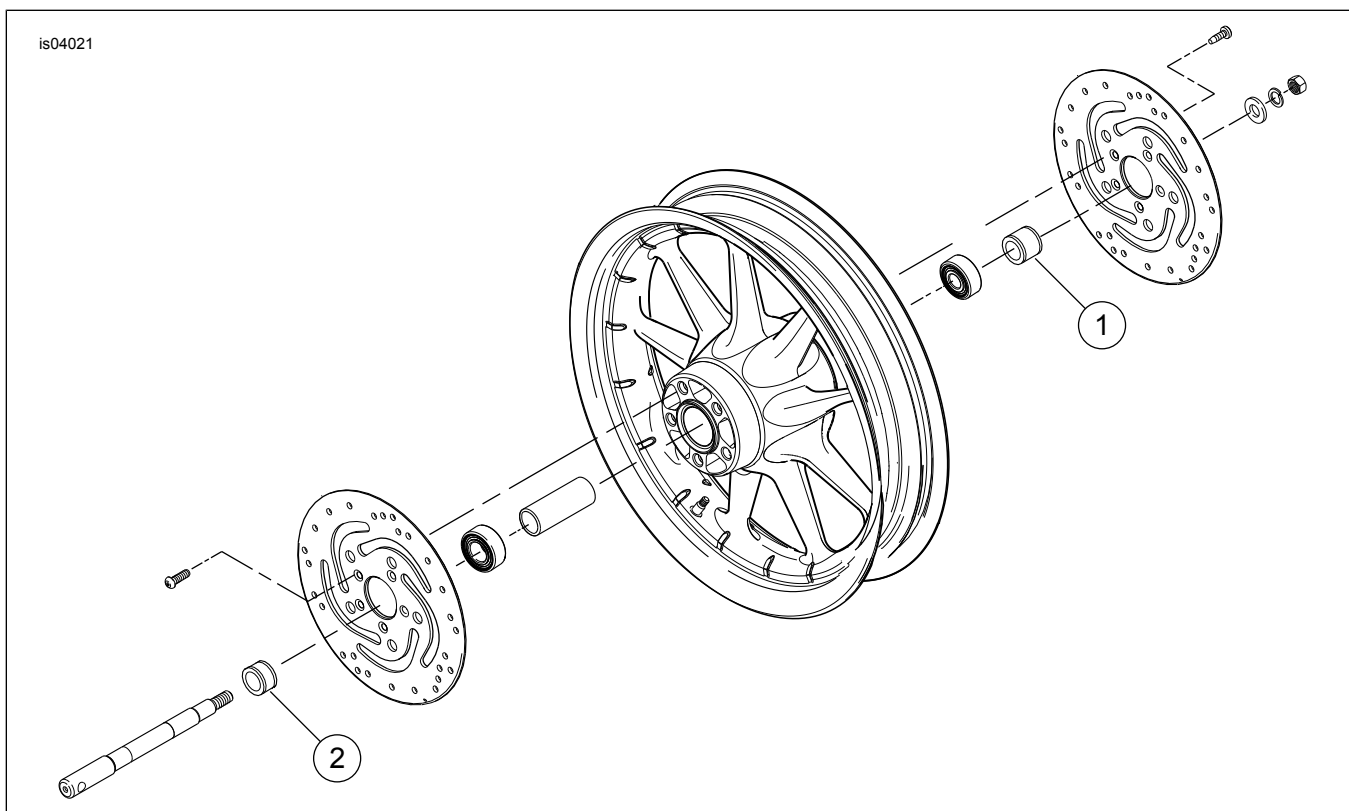

Figure 3. Chrome Front Wheel Spacers for Touring Models

Table 1. Service Parts: Chrome Front Wheel Spacer Kit - Model Years 2007 and Earlier

Item	Description	Part Number
1	Spacer, front wheel, left side (long)	41611-02
2	Spacer, front wheel, right side (short)	41612-02