



INSTRUCTIONS

J03909

2005-10-20



ADVANCED AUDIO COMMUNICATION SWITCH KIT

GENERAL

Kit Number

77173-06

Models

This kit fits 2006 and later FLHT (Electra Glide[®]), FLHTC (Electra Glide Classic) and FLHX (Street Glide[™]) model motorcycles.

Additional Parts Required

FLHT models will require prior installation of an Advanced Audio AM/ FM/ CD Radio Kit (Part Number 76412-06) and an AM/ FM Antenna Kit (Part Number 76325-06 or 76317-06).

FLHX models will require the separate purchase of:

- a fuel tank console (Part Number 61270-98A),
- a console extension (Part Number 52446-96),
- a rubber molding (71294-89),
- a 1/4-20 staked nut (Part Number 7964),
- a button-head screw (Part Number 3652),
- a plastic wire clip (Part Number 10120),
- an adhesive-backed metal wire clip (Part Number 10103).

ALL models will require the separate purchase of **EITHER**:

- an Advanced Audio Hands Free Phone Interface Kit (Part Number 76408-06), **OR**
- an Advanced Audio CB Radio Kit (Part Number 76416-06), **OR**
- an Advanced Audio Intercom Kit (Part Number 76440-06).

ALL models: See a Harley-Davidson dealer for availability of optional decorative inserts for the Console Pod Assembly contained in this kit.

All of these items are available from a Harley-Davidson Dealer.

⚠ WARNING

Rider and passenger safety depend upon the correct installation of this kit. Use the appropriate service manual procedures. If the procedure is not within your capabilities or you do not have the correct tools, have a Harley-Davidson dealer perform the installation. Improper installation of this kit could result in death or serious injury. (00333b)

NOTE

This instruction sheet references Service Manual information. A Service Manual for your model motorcycle is required for this installation and is available from a Harley-Davidson Dealer.

Kit Contents

See Figure 1 and Table 1.

INSTALLATION

⚠ WARNING

To prevent accidental vehicle start-up, which could cause death or serious injury, remove main fuse before proceeding. (00251b)

1. Refer to the Service Manual and follow the instructions given to remove the maxi-fuse.
2. Refer to the instructions included with the Advanced Audio Hands Free Phone Interface, CB Radio or Intercom Kit, and proceed with **that** installation until the installation of the items in **this** kit is called for.
3. Remove the outer fairing and windshield. Refer to OUTER FAIRING/ WINDSHIELD REMOVAL in the Service Manual.
4. On the fairing cap, remove the inner left side hole plug. See Figure 1 and the FAIRING CAP SWITCHES (FLHTC/U) section in the Service Manual. Install the fairing speaker switch (4) in the opening as follows: **If a cruise control switch IS present:** Follow the instructions in the Service Manual to install the speaker switch. **If a cruise control switch IS NOT present:**
 - a. Obtain the speaker switch adapter wire (5) from the kit, and the butt splice connector included with the speaker switch.
 - b. Refer to SEALED BUTT SPLICE CONNECTORS in the Service Manual. Splice the adapter wire to the black/ green speaker switch lead.
 - c. Insert the terminated end of the adapter wire into cavity 12 of the fairing cap switch connector [105B]
5. Remove the original equipment left-hand control switch assembly per the HANDLEBAR SWITCHES, REMOVAL, LEFT HANDLEBAR CONTROLS instructions in the Service Manual.
6. Install the **new** left-hand control switch assembly (3) from the kit.

⚠ WARNING

When servicing the fuel system, do not smoke or allow open flame or sparks in the vicinity. Gasoline is extremely flammable and highly explosive, which could result in death or serious injury. (00330a)



7. **ALL models:** Install the Console pod assembly (1), and route the harness forward into the fairing per the instructions packaged with the Advanced Audio Hands Free Phone Interface, CB Radio or Intercom Kit.

8. Unless already installed, install the overlay harness per the instructions packaged with the Hands Free Phone Interface, CB Radio or Intercom Kit.

9. Refer to the Service Manual and follow the instructions given to re-install the maxi-fuse.

10. Test the communication switch, headset or microphone, and the rest of the sound system for proper operation.

11. Re-install the outer fairing and windshield. Refer to OUTER FAIRING/ WINDSHIELD INSTALLATION in the Service Manual.

▲ WARNING

Be sure that steering is smooth and free without interference. Interference with steering could result in loss of vehicle control and death or serious injury. (00371a)

- Be sure the wires do not pull tight when handlebars are turned fully to left or right fork stops.

SERVICE PARTS

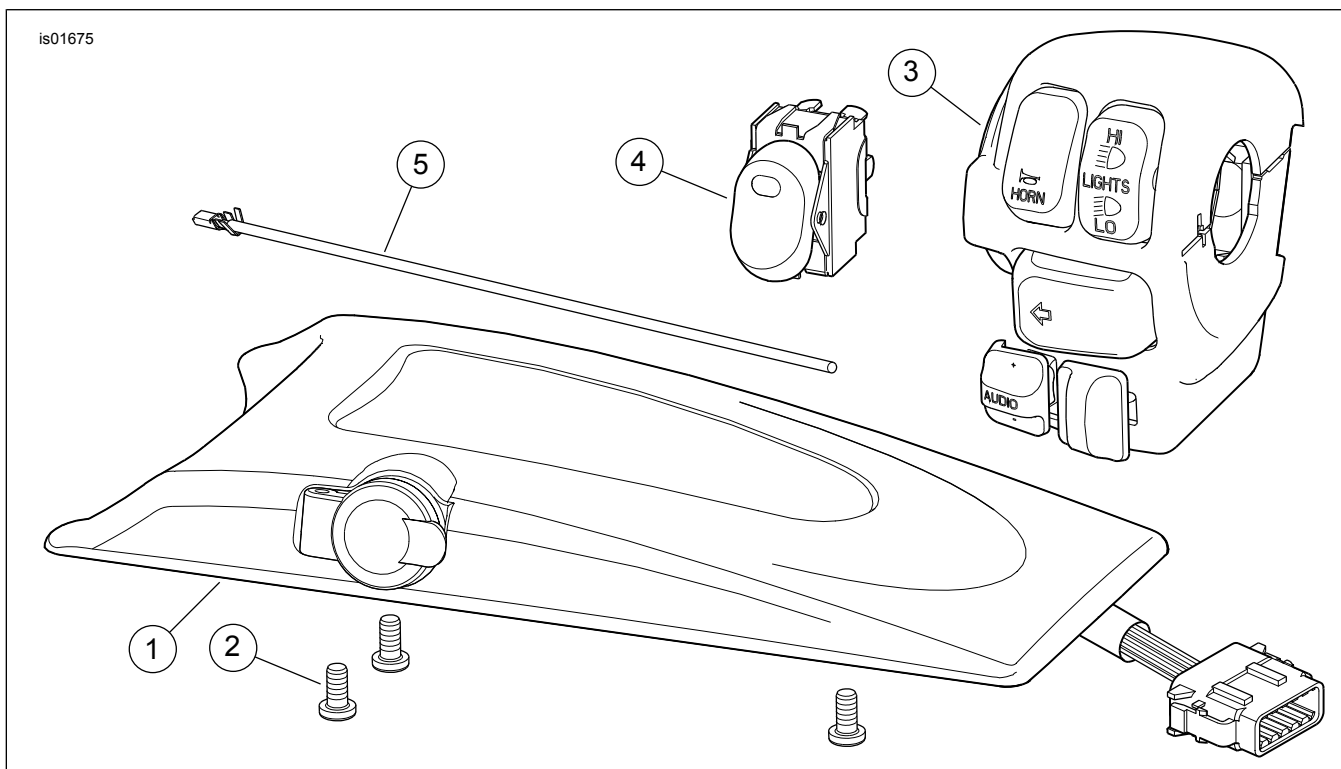

Figure 1. Service Parts, Kit 77173-06

Table 1. Service Parts Table

Item	Description (Quantity)	Part Number
1	Console pod assembly	77136-03
2	Screw, button head, #8-32 x 0.40 in. (3)	2462
3	Handlebar control assembly, left hand	70046-00
4	Speaker selector switch (includes one red butt-splice connector 70585-93)	77092-98
5	Adapter wire, speaker switch	77174-06