



INSTRUCTIONS

J01982

2006-07-21



CHROME FORK SLIDER DUST COVER KIT

GENERAL

Kit Number

45243-00

Models

For the most up-to-date model fitment information, please see the product label or www.harley-davidson.com.

⚠ WARNING

Rider and passenger safety depend upon the correct installation of this kit. Use the appropriate service manual procedures. If the procedure is not within your capabilities or you do not have the correct tools, have a Harley-Davidson dealer perform the installation. Improper installation of this kit could result in death or serious injury. (00333b)

NOTE

This instruction sheet references Service Manual information. A Service Manual for your model motorcycle is required for this installation and is available from a Harley-Davidson Dealer.

Additional Parts Required

Installation of this kit requires the purchase of Loctite® 243 (blue) (Harley-Davidson Part Number 99642-97).

Kit Contents

Table 1. Kit Contents

Description (Quantity)	Part Number
Dust cover, chrome (2)	Not sold separately
O-ring (2)	45394-00
Set screw (6)	3321
Dust seal (2)	46175-00

INSTALLATION

- Following instructions in applicable Service Manual, remove front wheel, brake caliper and front fender.

NOTICE

Exercise caution to avoid scratching or nicking fork tube. Damaging tube can result in fork oil leaks after assembly. (00421b)

- Remove fork tubes.
- See Figure 1. Gently pry out existing (rubber) dust cover (1) from slider and slide up and off of fork tube.

- See Figure 2. Obtain rubber dust seal (1) and O-ring (2) from kit. Install O-ring to groove in seal as shown.
- With dust seal and O-ring oriented as shown, slide down tube until seal and O-ring make complete contact with slider.
- Using a plastic mallet or soft-faced hammer, tap around seal until O-ring and seal are completely seated in slider.
- See Figure 3. Note which set screw hole (1) is in line with the drain hole (2). Slide chrome dust cover over the tube, positioning that set screw hole in line with the drain screw which is near the bottom of the lower fork slider.

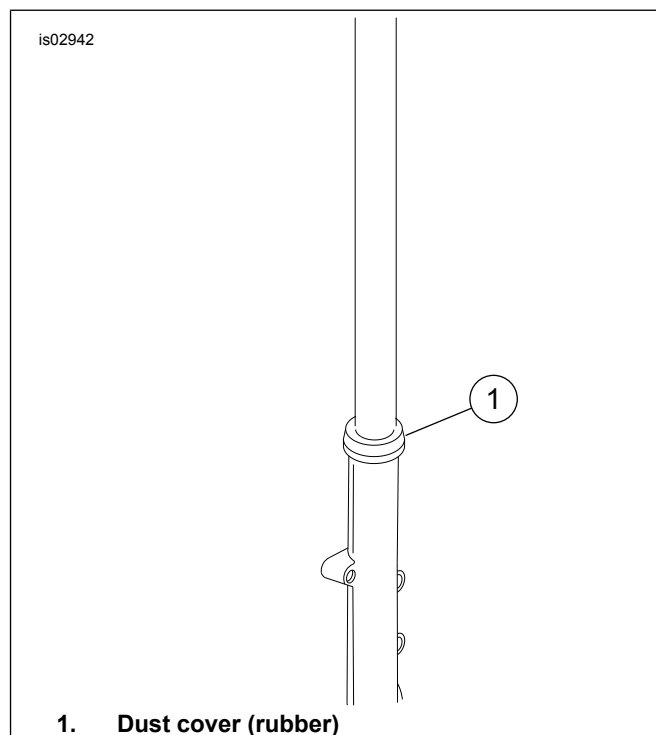

1. Dust cover (rubber)

Figure 1. Slider Dust Cover



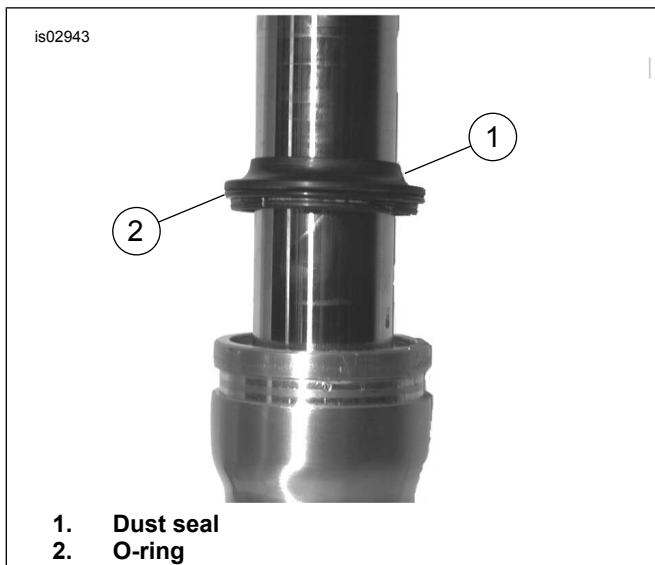

Figure 2. O-ring and Dust Seal

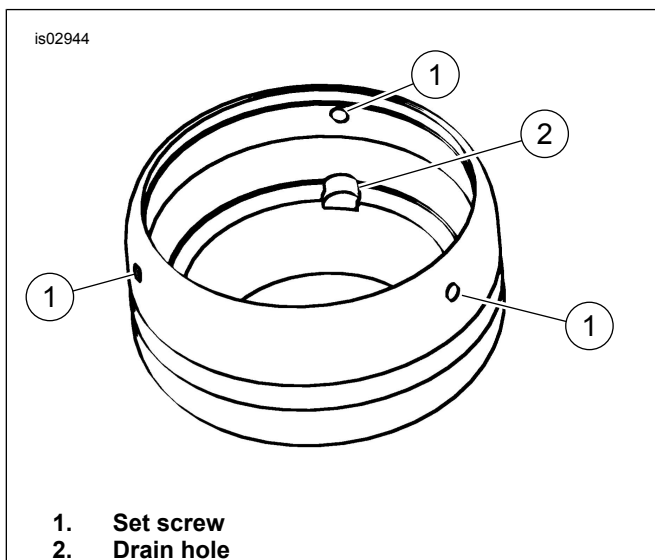

Figure 3. Drain Hole Orientation

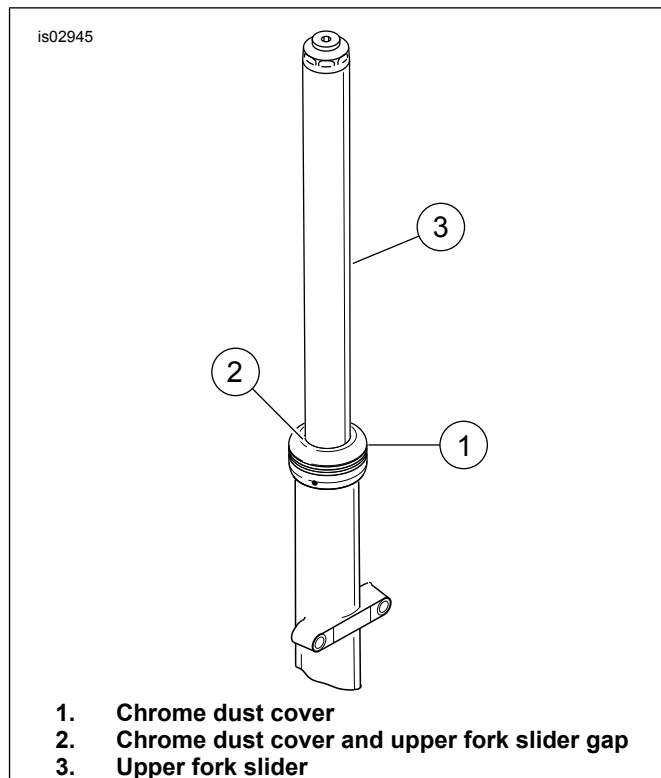

Figure 4. Chrome Dust Cover Centered

8. See Figure 4. Apply Loctite[®] 243 (blue) (Harley-Davidson Part Number 99642-97) to threads of the set screws and install set screws into chrome dust cover. Finger tighten set screw until it fits snugly. Then tighten each set screw to 8-10 **in-lbs**, while ensuring that the chrome dust cover is centered above the upper fork slider.
9. Repeat Steps 3 through 8 for the remaining fork tube.
10. Following instructions in Service Manual, install fork tubes, front fender, brake caliper and front wheel.