



INSTRUCTIONS

J03736

2014-06-30



H-D DETACHABLES DYNA SOLO RACK

GENERAL

Kit Number

53511-06A

Models

This instruction sheet covers the mounting of a Detachable Solo rack for the 2006 and later Dyna® models with a solo seat.

Installation Requirements

Separate purchase of extra parts or accessories may be required for proper installation of this H-D® Detachables™ Kit. See the P&A retail catalog or the Parts and Accessories section of www.harley-davidson.com (English only) for a list of required parts or accessories.

⚠ WARNING

Rider and passenger safety depend upon the correct installation of this kit. If the procedure is not within your capabilities or you do not have the correct tools, have a Harley-Davidson dealer perform the installation. Improper installation of this kit could result in death or serious injury. (00308b)

⚠ WARNING

Do not exceed luggage rack weight capacity. Too much weight can cause loss of control, which could result in death or serious injury. (00373a)

NOTE

Maximum luggage rack weight capacity is 10 pounds (4.5 Kg).

Use care when loading luggage rack since improper loading can adversely affect handling. Do not use luggage rack as a seat since it can also adversely affect handling.

Kit Contents

See Figure 3 and Table 1.

INSTALLATION AND REMOVAL

1. See Figure 1. While standing behind the motorcycle, place the front rack notches (1) into the front docking points (2).
2. Pull the rear rotary latches back into their rearmost position.
3. Position the rear rotary latches (3) over the rear docking points (4). Verify the latches and sideplates fit into the neck of the rear docking points. This may require some gentle squeezing or spreading of the sideplates.

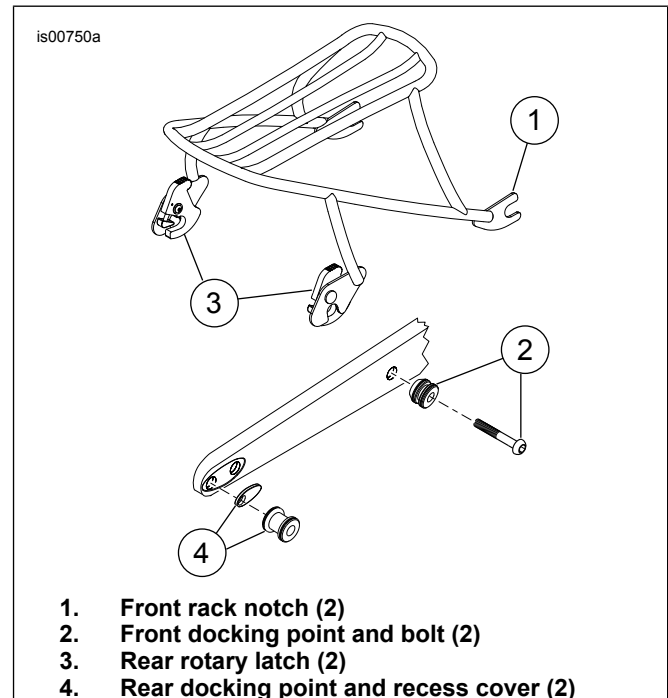

Figure 1. Install detachable solo rack

4. See Figure 2. Check luggage rack for proper alignment. Rear docking points can be damaged if rotary latches, fender support and cover are not properly aligned. If the latch does not easily close, do not force.

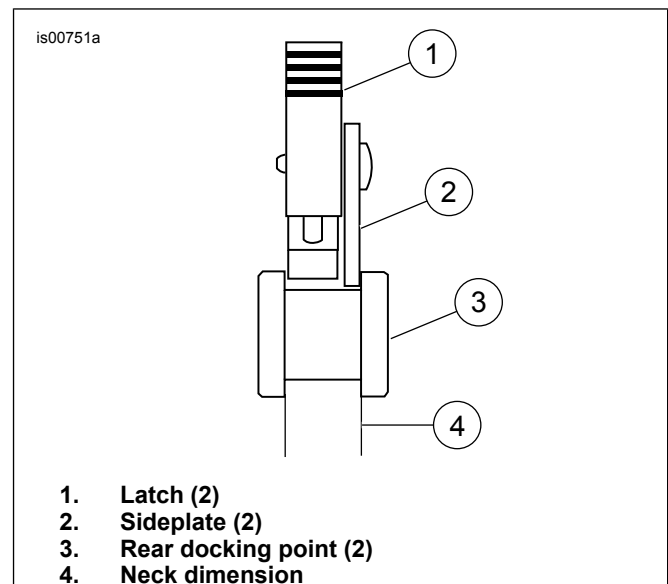

Figure 2. Solo Rack Alignment (rear view)

5. Push downward and close the rotary latches by pressing the latch lever as far forward as it goes. You hear a click when the latch is in place. If the latch does not easily close, do not force. Recheck luggage rack alignment.
6. Check the docking kit and rack are secure.

NOTE

The front and rear docking points must be fully engaged. If docking points are not fully engaged, or docking kit is loose, it could shift position or come loose during operation.

7. See Figure 3. To remove the rack, press the release button. Pull the rotary latch lever back. Carefully lift the rear of the rack up. Pull the rack out of the front docking points.

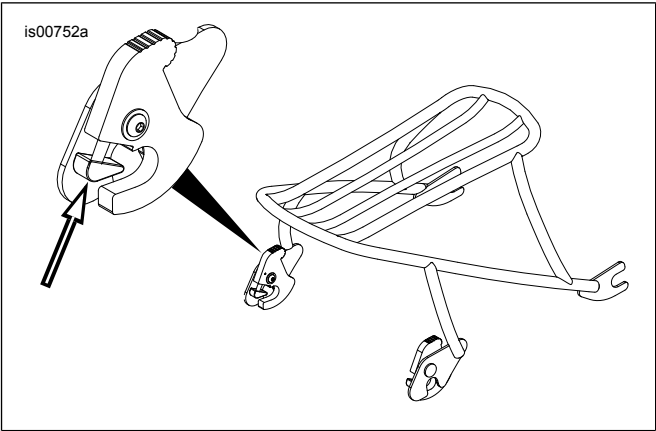

Figure 3. Press release button and pull lever back

SERVICE PARTS

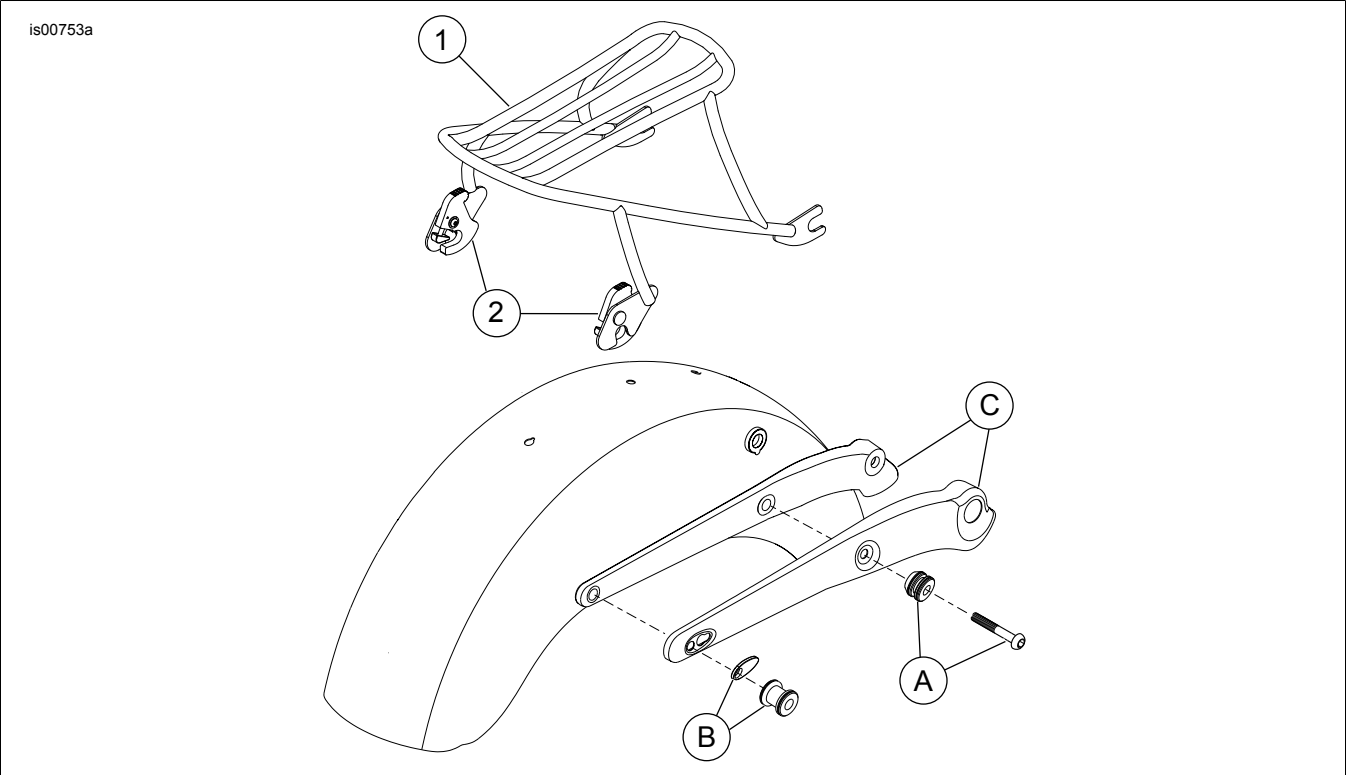

Figure 4. Service Parts: Dyna Detachable Solo Rack

Table 1. Service Parts: Dyna Detachable Solo Rack

Item	Description (Quantity)	Part Number
1	Detachable solo rack (chrome)	Not Sold Separately
2	Latch assembly (2)	50300108
Items mentioned in text, but not included in kit:		
A	Front docking point and bolt (2)	
B	Rear docking point and recess cover (2)	
C	Fender support and cover (2)	