



INSTRUCTIONS

J03930

2014-06-30



H-D DETACHABLES TOUR-PAK KIT FOR ELECTRA GLIDE CLASSIC

GENERAL

Kit Number

53303-07A

Models

For model fitment information, see the P&A retail catalog or the Parts and Accessories section of www.harley-davidson.com (English only).

Installation Requirements

Separate purchase of extra parts or accessories may be required for proper installation of this H-D® Detachables™ Kit. See the P&A retail catalog or the Parts and Accessories section of www.harley-davidson.com (English only) for a list of required parts or accessories.

⚠ WARNING

Rider and passenger safety depend upon the correct installation of this kit. Use the appropriate service manual procedures. If the procedure is not within your capabilities or you do not have the correct tools, have a Harley-Davidson dealer perform the installation. Improper installation of this kit could result in death or serious injury. (00333b)

NOTE

This instruction sheet references Service Manual information. A Service Manual for your model motorcycle is required for this installation. One is available from a Harley-Davidson Dealer.

⚠ WARNING

Do not exceed Tour-Pak weight capacity. Too much weight can cause loss of control, which could result in death or serious injury. (00401c)

NOTE

See label inside Tour-Pak®, operator's manual, Tour-Pak installation instructions for weight capacity limits.

Maximum Tour-Pak **luggage rack** weight capacity is 10 lbs (4.5 Kg).

Kit Contents

See Figure 6 and Table 1.

PREPARATION

1. Refer to Service Manual to remove saddlebags.
2. Refer to Service Manual to remove seat.
3. Refer to Service Manual to remove Tour-Pak®.

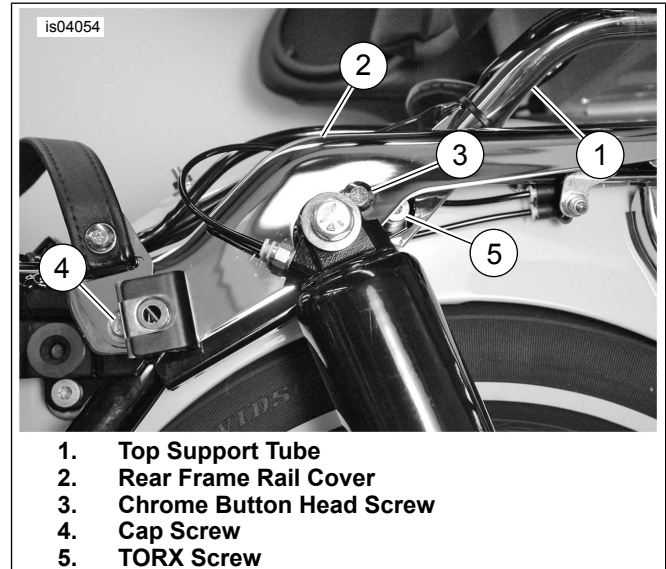

Figure 1. Remove Top Support Tube

4. See Figure 1. Remove top support tube (1).
 - a. Remove chrome button head screw (3)
 - b. Remove cap screw (4), washer, saddlebag bracket and seat strap.
 - c. Reposition rail cover (2) to access TORX® screw (5) holding top support tube (1). Remove screw (5).
 - d. Repeat these steps to disconnect the top support rail on the opposite side and remove top support tube.
 - e. Set aside frame rail covers, saddlebag brackets and hardware to install later.
5. Remove and discard existing license plate holder but save hardware to reuse.

INSTALLATION

Install Docking Kits and License Plate Holder

1. Install Rear Detachable Docking kit. Refer to the instruction sheet provided with kit.
2. Install Touring Detachable Tour-Pak Rack. Refer to the instruction sheet provided with kit.

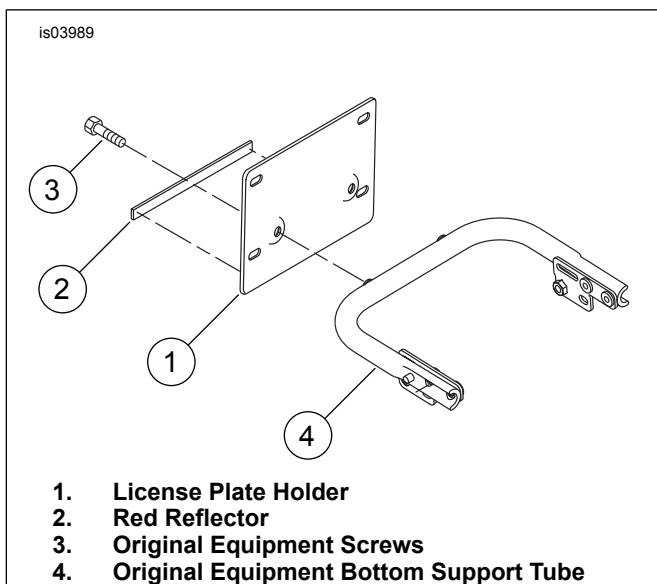

Figure 2. Install License Plate Holder

3. See Figure 2. Install the new license plate holder (1) to the bottom support tube (4) using screws (3) saved from prior step.
4. Remove adhesive backing from red reflector (2). Carefully center and align it with the bottom edge of the license plate holder (1). Press firmly into place.

Mounting Antenna Relocation Bracket

1. See Figure 6. Assemble joint assembly (9) to antenna mounting bracket (6) using lockwasher (5) and 2 hex nuts (4). Tighten hardware securely.

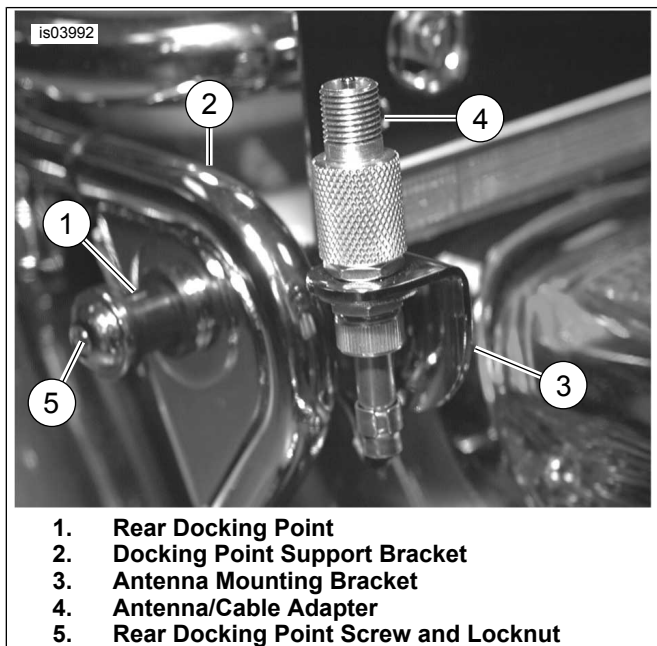

Figure 3. Relocated Antenna Bracket and Cable

2. See Figure 3. Install assembled antenna bracket (3) by removing screw and locknut (5) securing left rear docking point (1) to docking support (2). Install bracket as shown and install rear docking point screw and locknut. Tighten screw and locknut to 20.3–25.7 N·m (15–19 ft-lbs).

3. Thread antenna/cable adapter (4) onto joint assembly.

Routing Antenna Cables

1. See Figure 4. Gently remove left side cover (1) by pulling from frame tubes (no tools required).
2. Connect original antenna cable (not shown) to bottom of joint assembly.
3. Route antenna cable/wiring between left frame rail and fender.
4. See Figure 5. Attach cable to docking point support bracket in location (1) using short cable strap.
5. See Figure 4. Coil excess antenna cable/wiring (2). Use long cable strap (3) to fasten cable to frame under left side cover (1) with vehicle wiring harness.
6. See Figure 6. Cap unused wiring connector with connector housing (10).
7. Install left side cover.

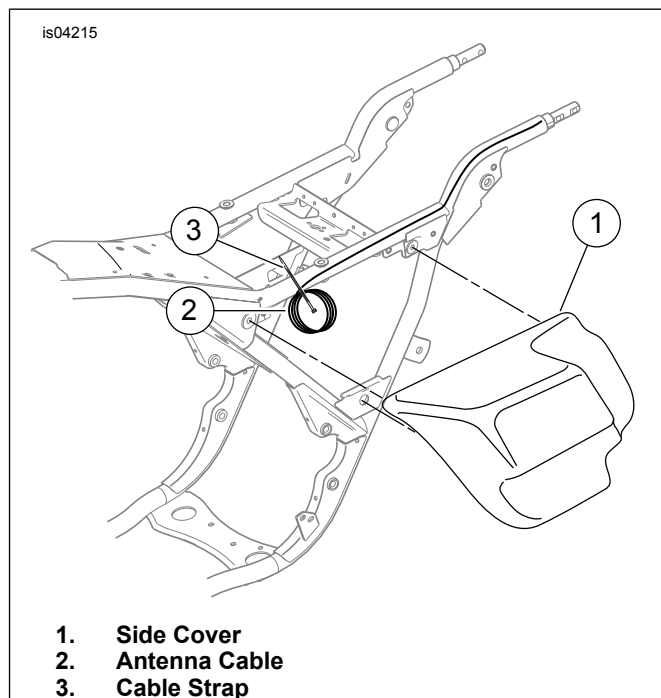
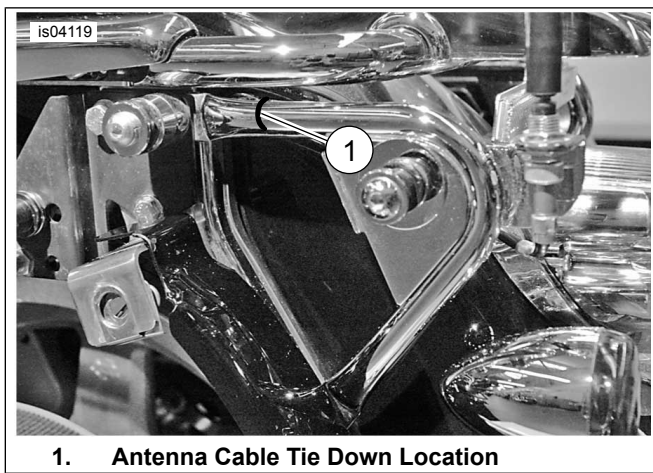

Figure 4. Side Cover and Antenna Cable Tie Down



1. Antenna Cable Tie Down Location

Figure 5. Antenna Cable Tie Down Location on Bracket

8. See Figure 1. Install chrome frame rail covers (2), saddlebag brackets and seat strap. Tighten chrome cover screw (3) to 2.8–4.5 N·m (25–40 **in-lbs**). Tighten the saddlebag bracket cap screw (4) finger-tight only. This bracket may need to be aligned when the saddlebags are installed.
9. Refer to Service Manual to install saddlebags
10. Refer to Service Manual to install front seat.
11. Attach Tour-Pak. Refer to instruction sheet provided with kit.

12. See Figure 3. Plug one end (connector) of antenna "patch" cable onto top of antenna adapter (4) and tighten knurled nut to secure connector. Route other end up and through 3/4 in diameter hole at the bottom front left side of Tour-Pak and plug into Tour-Pak antenna base. Tighten knurled nut. Make sure enough cable has been routed into Tour-Pak so that the cable rests flat on bottom of Tour-Pak. Secure in wire clips.

13. See Figure 6. Install grommet (3) in hole in Tour-Pak.

14. Check antenna for proper operation.

To Remove Tour-Pak and Relocate Antenna

1. Loosen set screw from base of the antenna mast on the Tour-Pak. Unscrew the mast from the Tour-Pak.
2. See Figure 3. Unscrew the antenna cable from the top of the antenna adapter.
3. Remove antenna adapter (4) and retain for use when Tour-Pak is reinstalled.
4. Remove Tour-Pak.
5. When removing the Tour-Pak, refer to Detachable Tour-Pak Rack instruction sheets.
6. Install antenna mast to the antenna mount joint assembly (item 9 in Fig 6). Secure with set screw.

SERVICE PARTS

Figure 6Table 1.

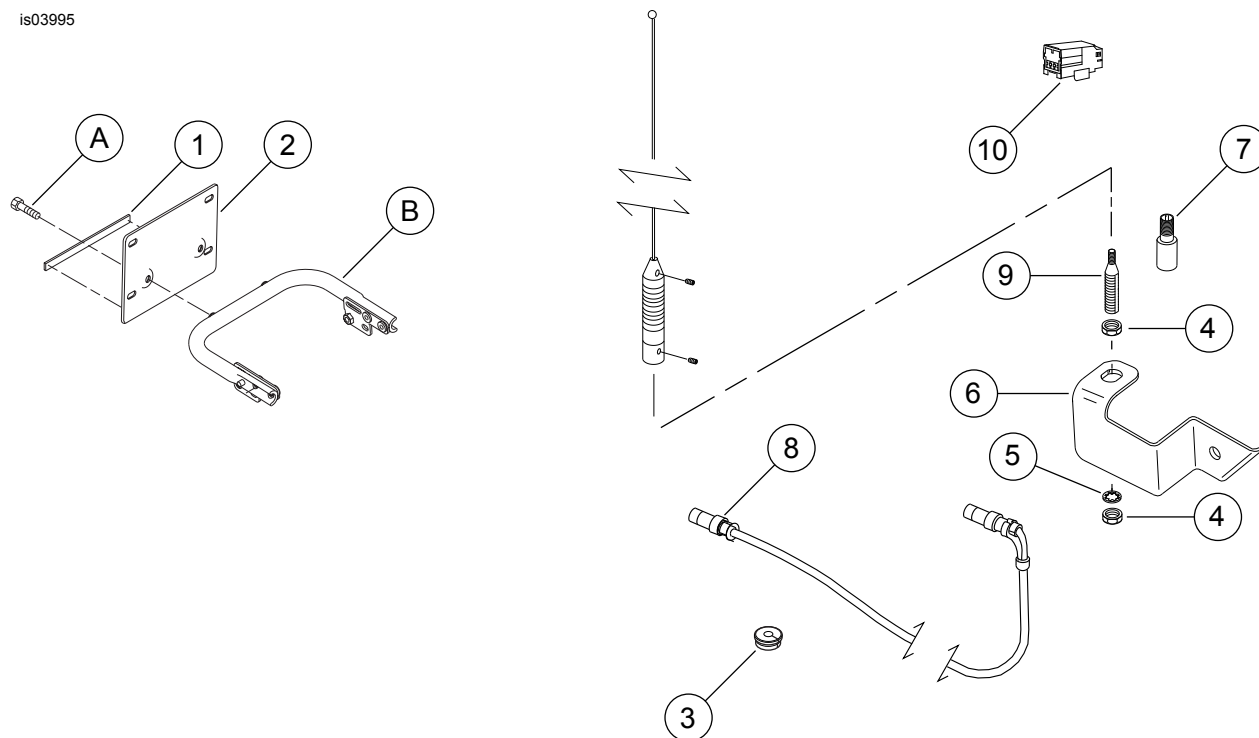

Figure 6. H-D Detachables Tour-Pak Kit for Electra Glide Classic

Table 1. Service Parts Table

Item	Description (Quantity)	Part Number
1	Reflector, red	59988-72A
2	Holder, license plate	53376-97
3	Grommet	11486
4	Nut, hex (2)	76353-00
5	Washer, lock, internal tooth	7129
6	Bracket, antenna mounting	76214-00
7	Adapter, antenna	76219-00
8	Cable, antenna	76229-00
9	Joint assembly, antenna mount	76354-00
10	Connector housing	73103-96BK
11	Cable strap, short (Not shown)	10126
12	Cable strap, long (Not shown)	10006
Items mentioned in text, but not included in kit:		
A	Existing hardware	
B	Bottom support tube	