



INSTRUCTIONS

J04378

2007-07-06



CUSTOM SHIFTER PEG KIT

GENERAL

Kit Number

34608-95, 34626-95, 34627-99, 34664-04

Models

For model fitment information, please see the P&A Retail Catalog or the Parts and Accessories section of www.harley-davidson.com (English only).

NOTE

A Service Manual for your model motorcycle is available from a Harley-Davidson Dealer.

Kit Contents

See Figure 1 and Table 1.

INSTALLATION

1. Remove and discard previously installed shifter peg from motorcycle. If needed, use a heat gun to apply heat to the shift lever and shifter peg threads to aid in peg removal.
2. See Figure 1. Insert the screw through the peg, tread, spacer (if required) into the shift lever. Tighten screw to 15–20 N·m (11–15 ft-lbs).



SERVICE PARTS

is05071

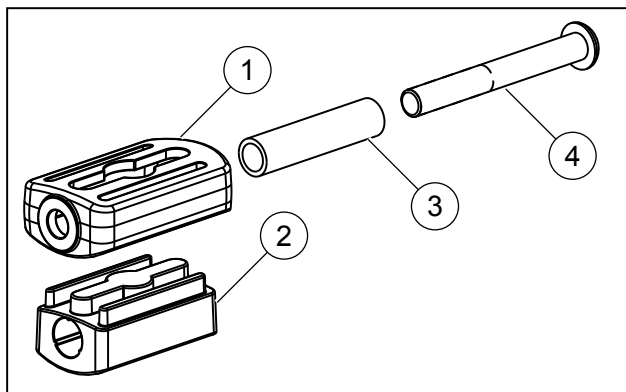

A

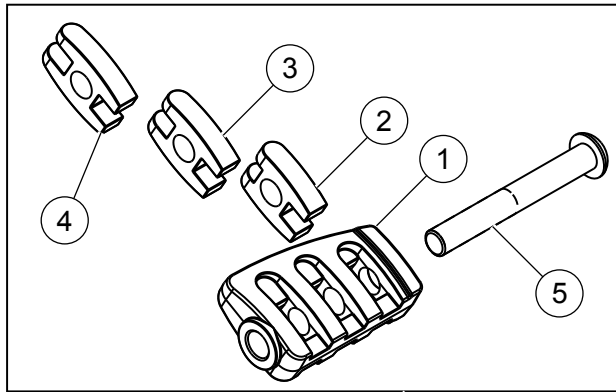

B

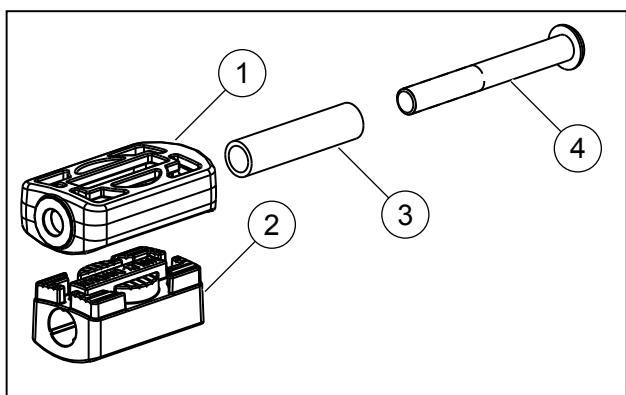

C

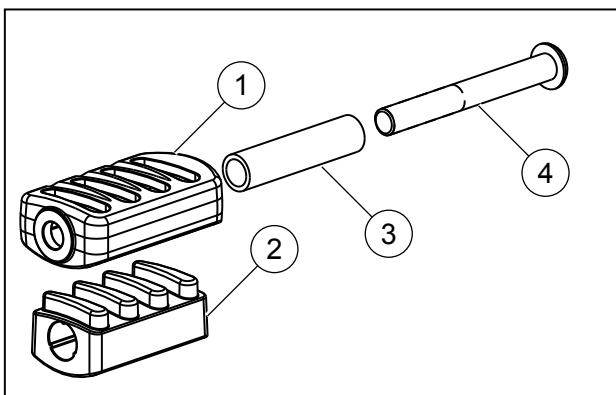

D

Figure 1. Service Parts: Shifter Peg Kits

Table 1. Service Parts Table

| Item | Description (Quantity) | Part Number |
|-------------------------|------------------------|---------------------|
| A - Kit 34608-95 | | |
| 1 | Shifter peg body | Not Sold Separately |
| 2 | Shifter peg insert | Not Sold Separately |
| 3 | Spacer tube | 50784-97 |
| 4 | Screw, button head cap | 94545-03 |
| B - Kit 34626-95 | | |
| 1 | Shifter peg body | Not Sold Separately |
| 2 | Shifter peg insert | Not Sold Separately |
| 3 | Shifter peg insert | Not Sold Separately |
| 4 | Shifter peg insert | Not Sold Separately |
| 5 | Screw, button head cap | 9495 |
| C - Kit 34627-99 | | |
| 1 | Shifter peg body | Not Sold Separately |
| 2 | Shifter peg insert | Not Sold Separately |
| 3 | Spacer tube | 50784-97 |
| 4 | Screw, button head cap | 94545-03 |
| D - Kit 34664-04 | | |
| 1 | Shifter peg body | 49220-04 |
| 2 | Shifter peg insert | 49221-04 |
| 3 | Spacer tube | 50784-97 |
| 4 | Screw, button head cap | 94545-03 |