



# INSTRUCTIONS

J04058

2012-10-18



## FRONT DISC WHEELS

### GENERAL

#### ⚠ WARNING

Install only wheels and installation kits approved for your model motorcycle. Contact a Harley-Davidson dealer to verify fitment. Mismatching wheels and installation kits or installing wheels not approved for your model can cause loss of control, which could result in death or serious injury. (00610c)

### Kit Numbers

41274-08, 41022-07, 41031-07, 41322-07, 41271-07

### Models

For model fitment information, see the P&A Retail Catalog or the Parts and Accessories section of [www.harley-davidson.com](http://www.harley-davidson.com) (English only).

#### NOTE

Accessory hub caps are not compatible with this wheel.

### Kit Contents

See the Service Parts section for kit contents.

### Additional Parts Required

These kits include the custom wheel and hub cap only, except for Kit 41274-08, which only includes a wheel. Refer to the Service Parts section for a complete description, and part numbers for these items.

Proper installation of this kit requires the separate purchase of the following parts which are available at a Harley-Davidson dealer:

- Wheel Installation Kit (See Table 2 through Table 7 to determine required installation kit.)
- 10 Brake Disc/Hub Cap Screws (3655A) or 2 Chrome screw kits (46646-05)
- Wheel Bearing Remover and Installer (94134-09)

The following Harley-Davidson Genuine Motor Accessories are recommended for proper maintenance and cleaning:

- Harley® Bright™ Chrome Cleaner (94683-99)
- Harley® Glaze™ Polish and Sealant (99701-84)
- Harley® Wheel and Spoke Brush (43078-99)
- Harley-Davidson® Wheel and Tire Cleaner (94658-98)
- Harley® Preserve™ Bare Aluminum Protectant (99845-07)

#### ⚠ WARNING

Rider and passenger safety depend upon the correct installation of this kit. Use the appropriate service manual procedures. If the procedure is not within your capabilities or you do not have the correct tools, have a Harley-Davidson dealer perform the installation. Improper installation of this kit could result in death or serious injury. (00333b)

#### NOTE

This instruction sheet references service manual information. A service manual for your model motorcycle is required for this installation and is available from a Harley-Davidson Dealer.

### INSTALLATION

1. Remove existing front wheel assembly. Save axle, axle nut, brake disc and wheel spacers for kit installation. Refer to FRONT WHEEL in service manual. **For FLSTC and FLSTN Models:** Discard moon-style hub cap.

#### NOTE

- For Kits 41022-07, 41031-07, 41322-07 and 41271-07 install short valve stem (43157-83A) included in the installation kit.
- For Kits 41274-08 install long valve stem (43206-01) included in the installation kit.

2. See Figure 1. Install valve stem assembly (L, M or N) on wheel. Refer to TIRES in service manual.

#### NOTE

Install the primary bearing first using appropriate service manual and WHEEL BEARING REMOVER/INSTALLER. The side opposite the valve stem is the primary bearing side.

The front wheel should be installed so that the valve stem is on the right side of the motorcycle.

#### NOTICE

**Do not re-use brake disc/rotor screws. Re-using these screws can result in torque loss and damage to brake components. (00319c)**

3. Assemble wheel installation kit components and brake disc(s) to wheel, using the appropriate the service parts table. Refer to FRONT WHEEL in Service Manual.
4. **FLSTC and FLSTN models:** Install wheel kit and right hand wheel spacer provided in kit installation. **All other models:** Install wheel spacers previously removed.



5. Install front wheel (1), stock axle, and stock axle nut. Refer to FRONT WHEEL in service manual.

## MAINTENANCE AND CLEANING

Chrome parts must be maintained regularly to keep their original shine and luster.

1. Clean heavily-soiled wheel surfaces using Harley-Davidson Wheel and Tire Cleaner, applied with Harley Wheel and Spoke Brush.
2. Thoroughly clean chrome with a good quality chrome cleaner, such as Harley Bright Chrome Cleaner.
3. After cleaning and polishing, seal the finish with a good quality sealer, such as Harley Glaze Polish and Sealant.

## SERVICE PARTS

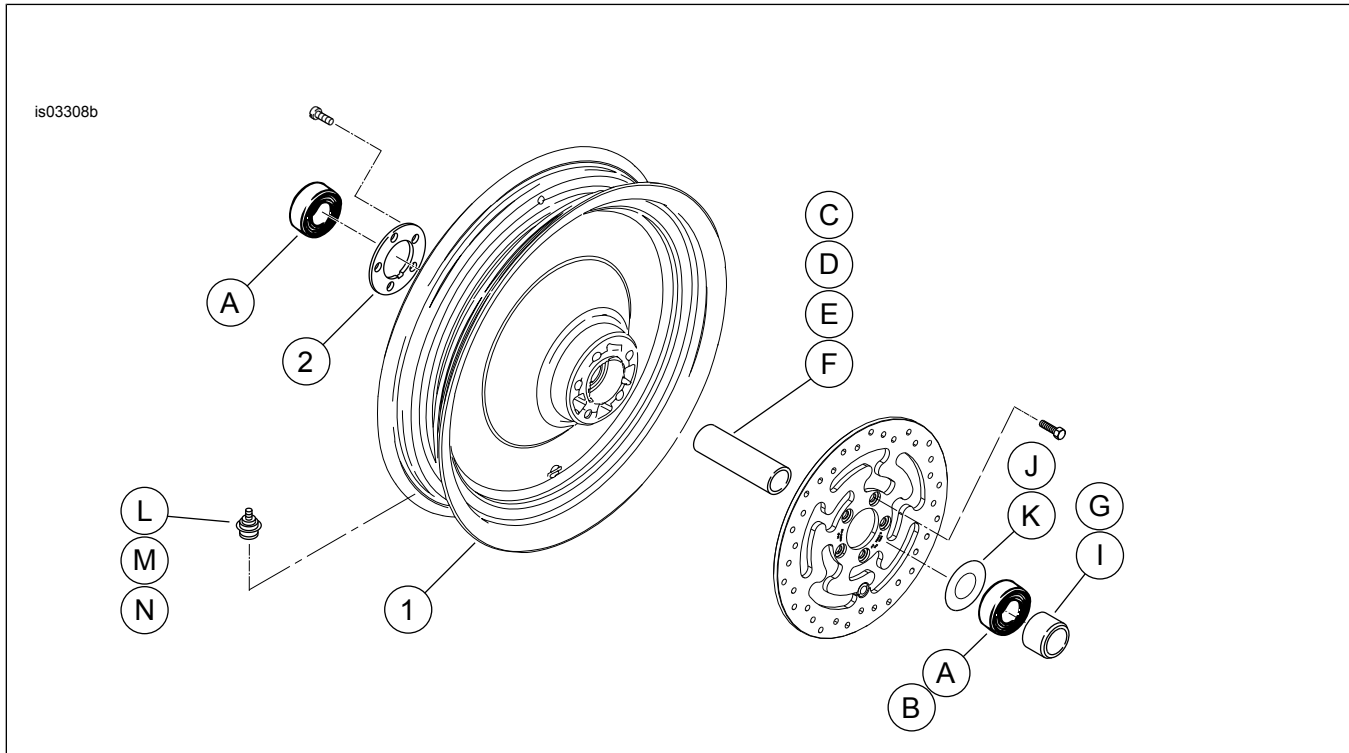

Figure 1. Service Parts: Front Disc Wheels

Table 1. Service Parts and Wheel Kit Contents

Kit	Item	Description (Quantity)	Part Number
41274-08	1	Wheel	Not Sold Separately
41322-07, 41022-07,	1	Wheel	Not Sold Separately
41031-07, 41271-07	2	Hub cap	41025-00

Table 2. FRONT 3/4 Inch Bearing Wheel Installation Kit (43833-07A)

FRONT 3/4 Inch Bearing Wheel Installation Kit (43833-07A)		ITEM (Quantity Used and Description)									
Fitment	Wheel Size	A	C	D	E	G	H	I	L	M	
2000-2006 FLST and FLSTF (except 2006 FLSTFSE2)	16 x 3.0 in	2	0	1	0	0	0	0	*	*	
2000-2006 FLSTC and FLSTN	16 x 3.0 in	2	0	1	0	0	0	1	*	*	
2006 FLSTFSEi	17 x 3.5 in	2	0	1	0	0	0	1	*	*	
2008-later FLSTSB	18 x 3.5 in	2	0	***	0	***	0	0	*	*	
2000-2007 XL; 2000-2003 Dyna (except FXDWG)	19 x 2.5 in	2	0	0	1	0	0	0	*	*	
2000-2007 XL; 2000-2003 Dyna (except FXDWG)	21 x 2.15 in	2	0	0	1	0	0	0	*	*	
2000-2006 FXST/B/C; 2000-2005 FXDWG**	21 x 2.15 in	2	1	0	0	0	0	0	*	*	
2000-2006 FXSTS**	21 x 2.15 in	2	1	0	0	0	1	0	*	*	
2000-2006 FXSTD (Except FXSTDSE)**	21 x 2.15 in	2	1	0	0	1	0	0	*	*	

**Table 2. FRONT 3/4 Inch Bearing Wheel Installation Kit (43833-07A)**

FRONT 3/4 Inch Bearing Wheel Installation Kit (43833-07A)		ITEM (Quantity Used and Description)									
Fitment	Wheel Size	A	C	D	E	G	H	I	L	M	
Installation kits are designed to work with many different wheel styles and fitments. Contact a Harley-Davidson dealer to verify that the wheel and installation kits are both designed and approved for the motorcycle they are being installed on. NOTES: * See NOTE above valve installation step in INSTALLATION to determine which valve stem to use for your particular kit. Discard other valve stem(s). ** The right side of the wheel is the primary bearing side for this fitment. *** See INSTALLATION section for separate hardware kit to be used for FLSTSB models.		A	Bearing, regular (2)					9267			
		C	Axle sleeve					43536-00			
		D	Axle sleeve					43608-00			
		E	Axle sleeve					43613-00			
		G	Spacer, axle					40910-00A			
		H	Spacer, axle					43313-98			
		I	Spacer, wheel					43617-00A			
		L	Valve stem, short					43157-83A			
		M	Valve stem, long					43206-01			

**Table 3. FRONT 1 Inch Bearing Wheel Installation Kit (43848-08A)**

FRONT 1 Inch Bearing Wheel Installation Kit (43848-08A)		ITEM (Quantity Used and Description)								
Fitment	Wheel Size	A	C	D	E	F	L	M		
2000-2007 Touring	16 x 3.0 in	2	1	0	0	0	*	*		
2004-2007 Touring	18 x 3.5 in	2	1	0	0	0	*	*		
2004-2005 Dyna (except FXDWG)	19 x 2.5 in	2	0	0	0	1	*	*		
2006-2007 Dyna (except FXDWG)	19 x 2.5 in	2	0	0	1	0	*	*		
2002-2007 VRSC	19 x 3.0 in	2	0	0	1	0	*	*		
2006-2007 FXDWG**	21 x 2.15 in	2	0	1	0	0	*	*		
2004-2005 Dyna (except FXDWG)	21 x 2.15 in	2	0	0	0	1	*	*		
Installation kits are designed to work with many different wheel styles and fitments. Contact a Harley-Davidson dealer to verify that the wheel and installation kits are both designed and approved for the motorcycle they are being installed on. NOTES: * See NOTE above valve installation step in INSTALLATION to determine which valve stem to use for your particular kit. Discard other valve stem(s). ** The right side of the wheel is the primary bearing side for this fitment.		A	Bearing, regular (2)					9247		
		C	Axle sleeve					43517-00		
		D	Axle sleeve					43633-06		
		E	Axle sleeve					43641-01		
		F	Axle sleeve					43755-04		
		L	Valve stem, short					43157-83A		
		M	Valve stem, long					43206-01		

**Table 4. FRONT 25 mm Bearing Wheel Installation Kit (41455-08C)**

FRONT 25 mm Bearing Wheel Installation Kit (41455-08C)		ITEM (Quantity Used and Description)								
Fitment	Wheel Size	A	C	D	J	K	L	M	N	
2008 Touring; 2009 and later FLHRC (non-ABS) and Trike (non-ABS)	16 x 3.0 in	2	0	1	0	1	*	*	*	
2009 and later Touring (non-ABS)	17 x 3.0 in	2	0	1	0	0	*	*	*	
2008 and later Touring (non-ABS)	18 x 3.5 in	2	0	1	0	**	*	*	*	
2008 and later Dyna (except FLD, FXDWG and FXDF)	19 x 2.5 in	2	1	0	**	0	*	*	0	
2008 and later VRSCAW, VRSCD, VRSCF and VRSCDX (non-ABS)	19 x 3.0 in	2	1	0	**	0	*	*	0	
2009 and later Touring (non-ABS)	19 x 3.5 in	2	0	1	0	0	*	*	*	
Installation kits are designed to work with many different wheel styles and fitments. Contact a Harley-Davidson dealer to verify that the wheel and installation kits are both designed and approved for the motorcycle they are being installed on. NOTES: * See NOTE above valve installation step in INSTALLATION to determine which valve stem to use for your particular kit. Discard other valve stem(s). ** See NOTES for your wheel kit above the wheel assembly step in INSTALLATION to determine if bearing shim is used for your particular wheel kit and fitment. *** Bearing shim installed under the primary bearing.		A	Bearing, regular (2)					9276		
		C	Axle sleeve					41748-08		
		D	Axle sleeve					41900-08		
		J	Bearing shim***					41450-08		
		K	Bearing shim***					43903-08		
		L	Valve stem, short					43157-83A		
		M	Valve stem, long					43206-01		
		N	Valve stem, pull thru					40999-87		

**Table 5. FRONT 25 mm Bearing Wheel Installation Kit (43851-11A)**

FRONT 25 mm Bearing Wheel Installation Kit (43851-11A)		ITEM (Quantity Used and Description)								
Fitment	Wheel Size	A	C	G	H	J	L	M	N	
2007 and later FLSTC, FLSTN and FLS (non-ABS)	16 x 3.0 in	2	1	0	1	1	*	*	*	
2008 and later FXDF	16 x 3.0 in	2	1	0	0	0	*	*	*	
2007 and later FLSTF and FLSTFB (non-ABS)	17 x 3.5 in	2	1	0	0	0	*	*	*	
2008 and later FLSTF and FLSTFB (non-ABS)	18 x 3.5 in	2	1	0	0	0	*	*	*	
2008 and later FXDF; 2012 and later FLD	18 x 3.5 in	2	1	0	0	0	*	*	*	
2007 and later FXS, FXST/B/C (non-ABS); 2008 and later FXDWG***	21 x 2.15 in	2	1	0	0	1	*	*	*	
2007 FXSTD***	21 x 2.15 in	2	1	1	0	1	*	*	*	

**Table 5. FRONT 25 mm Bearing Wheel Installation Kit (43851-11A)**

FRONT 25 mm Bearing Wheel Installation Kit (43851-11A)		ITEM (Quantity Used and Description)							
Fitment	Wheel Size	A	C	G	H	J	L	M	N
Installation kits are designed to work with many different wheel styles and fitments. Contact a Harley-Davidson dealer to verify that the wheel and installation kits are both designed and approved for the motorcycle they are being installed on. NOTES: * See NOTE above valve installation step in INSTALLATION to determine which valve stem to use for your particular kit. Discard other valve stem(s). ** Bearing shim installed under the primary bearing. *** The left side of the wheel is the primary bearing side for this fitment.		A	Bearing, regular (2)		9276				
		C	Axle sleeve		41349-07				
		G	Spacer, axle		41504-07				
		H	Spacer, axle		41695-07				
		J	Bearing shim**		43315-07				
		L	Valve stem, short		43157-83A				
		M	Valve stem, long		43206-01				
	N	Valve stem, pull-thru		40999-87					

**Table 6. FRONT 25 mm Bearing ABS Wheel Installation Kit (41454-08B)**

FRONT 25 mm Bearing ABS Wheel Installation Kit (41454-08B)		ITEM (Quantity Used and Description)									
Fitment	Wheel Size	A	B	C	D	J	K	L	M	N	
2008 Touring and 2009 and later FLHRC with ABS	16 x 3.0 in	1	1	0	1	0	1	*	*	0	
2009 and later Touring with ABS	17 x 3.0 in	1	1	0	1	0	0	*	*	*	
2008 and later Touring with ABS	18 x 3.5 in	1	1	0	1	**	**	*	*	*	
2012 and later Dyna with ABS (Except FLD, FXDWG and FXDF)	19 x 2.5 in	1	1	1	0	**	**	*	*	0	
2008 and later VRSCAW, VRSCD, VRSCF and VRSCDX with ABS	19 x 3.0 in	1	1	1	0	**	**	*	*	0	
2009 and later Touring with ABS	19 x 3.5 in	1	1	0	1	0	0	*	*	*	
Installation kits are designed to work with many different wheel styles and fitments. Contact a Harley-Davidson dealer to verify that the wheel and installation kits are both designed and approved for the motorcycle they are being installed on. NOTES: * See NOTE above valve installation step in INSTALLATION to determine which valve stem to use for your particular kit. Discard other valve stem(s). ** See NOTES for your wheel kit above the wheel assembly step in INSTALLATION to determine which bearing shim to use for your particular wheel kit and fitment. *** Red side of bearing must be installed toward the wheel. The ABS bearing is primary. **** Bearing shim installed under the primary bearing.		A	Bearing, regular		9276						
		B	Bearing, ABS***		9252						
		C	Axle sleeve		41748-08						
		D	Axle sleeve		41900-08						
		J	Bearing shim****		41450-08						
		K	Bearing shim****		43903-08						
		L	Valve stem, short		43157-83A						
	M	Valve stem, long		43206-01							
	N	Valve stem, pull thru		40999-87							

**Table 7. FRONT 25 mm Bearing ABS Wheel Installation Kit (42400010)**

FRONT 25 mm Bearing ABS Wheel Installation Kit (42400010)		ITEM (Quantity Used and Description)									
Fitment	Wheel Size	A	B	C	G	J	K	L	M	N	
2011 and later FLSTC, FLSTN and FLS with ABS	16 x 3.0 in	1	1	1	1	0	1	*	*	*	
2012 and later FXDF with ABS	16 x 3.0 in	1	1	1	0	0	0	*	*	*	
2011 and later FLSTF and FLSTFB with ABS	17 x 3.5 in	1	1	1	0	0	0	*	*	*	
2011 and later FLSTF and FLSTFB with ABS	18 x 3.5 in	1	1	1	0	0	0	*	*	*	
2012 and later FXDF and FLD with ABS	18 x 3.5 in	1	1	1	0	0	0	*	*	*	
2011 and later FXS, FXST and 2012 and later FXDWG with ABS	21 x 2.15 in	1	1	1	0	0	1	*	*	*	
Installation kits are designed to work with many different wheel styles and fitments. Contact a Harley-Davidson dealer to verify that the wheel and installation kits are both designed and approved for the motorcycle they are being installed on. NOTES: * See NOTE above valve installation step in INSTALLATION to determine which valve stem to use for your particular kit. Discard other valve stem(s). ** Red side of bearing must be installed toward the wheel. The ABS bearing is the primary bearing. *** Bearing shim installed under the primary bearing.		A	Bearing, regular		9276A						
		B	Bearing, ABS**		9252						
		C	Axle sleeve		41349-07						
		G	Spacer		41695-07						
		J	Bearing shim***		41448-08						
		K	Bearing shim***		43315-07						
		L	Valve stem, short		43157-83A						
	M	Valve stem, long		43206-01							
	N	Valve stem, pull-thru		40999-87							