



INSTRUCTIONS

J04388

2008-05-28



FXCW PASSENGER PILLION UPRIGHT KIT

GENERAL

Kit Number

52804-08

Models

For model fitment information, see the P&A Retail Catalog or the Parts and Accessories section of www.harley-davidson.com (English only).

Kit Contents

See Figure 2 and Table 1.

Required Parts

Separate purchase of a solo support structure (kit number 53935-08), solo luggage rack kit (part number 53957-08) and detachable passenger pillion (kit number 52959-08) is required. Passenger backrest pad (kit number 51782-07) may also be purchased separately.

Separate purchase of LOCTITE® 243 Threadlocker and Sealant - Blue is also required. Loctite is available at a Harley-Davidson dealer.

⚠ WARNING

Rider and passenger safety depend upon the correct installation of this kit. If the procedure is not within your capabilities or you do not have the correct tools, have a Harley-Davidson dealer perform the installation. Improper installation of this kit could result in death or serious injury. (00308b)

INSTALLATION

1. See Figure 1. Install the solo support structure (4) and luggage rack kit (5) following the instructions in the appropriate kit.
2. Insert the ends of the upright (2) into the pillion (3) and align the holes in the upright with the holes in the pillion.
3. See Figure 2. Apply LOCTITE 243 to screws (2) and install. Tighten screws to 9.5–12.2 N·m (7–9 ft-lbs).
4. Install the pillion and upright assembly onto the luggage rack following the instructions in the detachable passenger pillion kit.

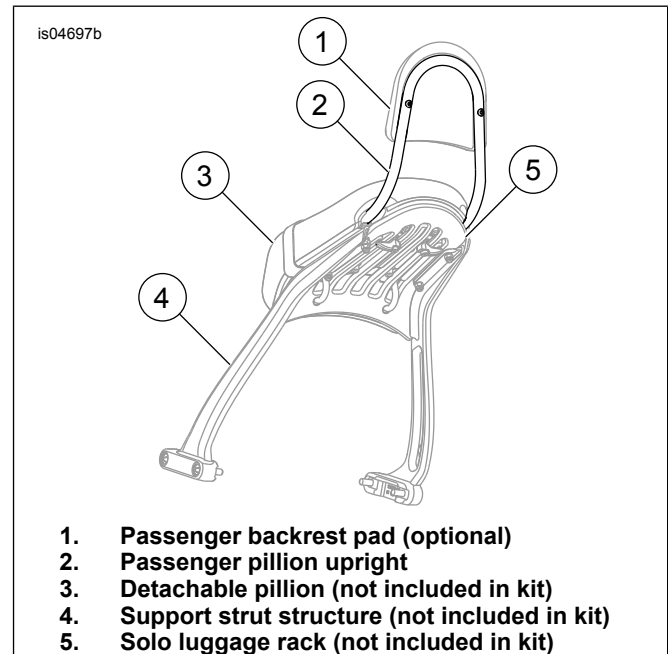

Figure 1. FXCW Passenger Pillion Upright

Service Parts

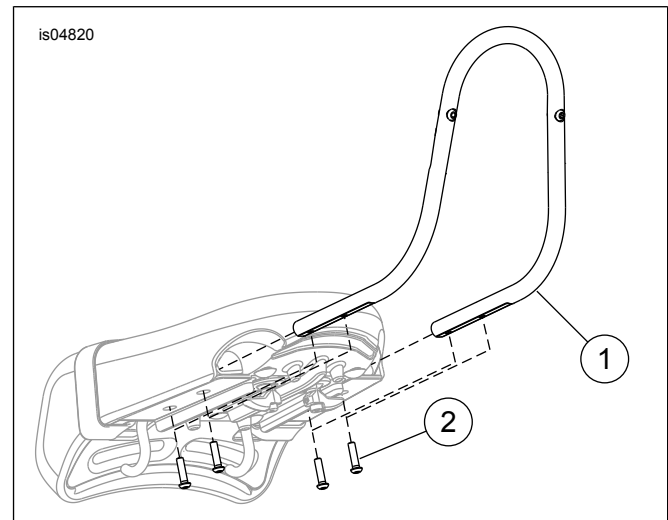

Figure 2. Service Parts: FXCW Passenger Pillion Upright Kit

Table 1. Service Parts: FXCW Passenger Pillion Upright Kit

Item	Description (Quantity)	Part Number
1	Passenger pillion upright	Not Sold Separately
2	Screw, 1/4-20 x 1.0 (4)	4015