



# INSTRUCTIONS

J04689

2015-06-12



## TWO-UP SEAT KITS FOR TOURING MODELS

### GENERAL

#### Kit Numbers

51526-09, 51527-09, 51620-09, 52000257

#### Models

For model fitment information, see the P&A Retail Catalog or the Parts and Accessories section of [www.harley-davidson.com](http://www.harley-davidson.com) (English only).

#### NOTE

*These kits do not fit on models equipped with rider backrests or passenger grab rails.*

### Installation Requirements

#### ⚠ WARNING

Rider and passenger safety depend upon the correct installation of this kit. Use the appropriate service manual procedures. If the procedure is not within your capabilities or you do not have the correct tools, have a Harley-Davidson dealer perform the installation. Improper installation of this kit could result in death or serious injury. (00333b)

#### NOTE

*This instruction sheet references service manual information. A service manual for your model motorcycle is required for this installation. One is available from a Harley-Davidson Dealer.*

### Kit Contents

See Figure 4 and Table 1.

### REMOVAL

1. Remove left and right side saddlebag following the instructions in the service manual.

#### NOTE

*Note the mounting orientation of the saddlebag mounting brackets before removing.*

2. See Figure 2. Remove the left side forward saddlebag mounting bracket attaching bolt and washer to remove the bracket and disconnect the grab strap. Save all saddlebag mounting hardware for installation.
3. Remove the right side forward saddlebag mounting bracket attaching bolt and washer. Remove and discard the grab strap.
4. Remove the screw and lockwasher from the rear of the seat. Pull the seat back to remove.

5. If equipped, remove fender trim strips:
  - a. Cover the tip of a regular screwdriver with a piece of tape to protect chrome and painted surfaces.
  - b. See Figure 1. Insert the tip of the screwdriver between the chrome bezel and the rubber trim strip.
  - c. Pry up the bezel enough to get a hold of it, then pull it up and away from the rubber trim strip.
  - d. Starting at either end, peel the rubber trim strip away from the fender.
  - e. Clean with a mixture of 50 percent isopropyl alcohol and 50 percent distilled water.

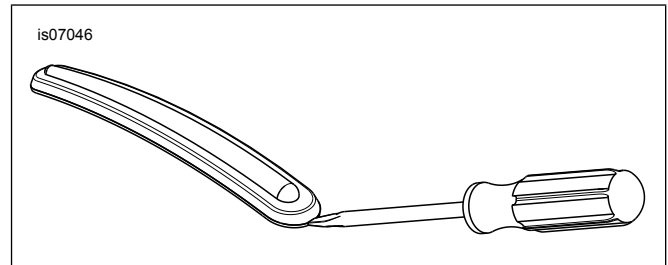

Figure 1. Remove Fender Trim Strip

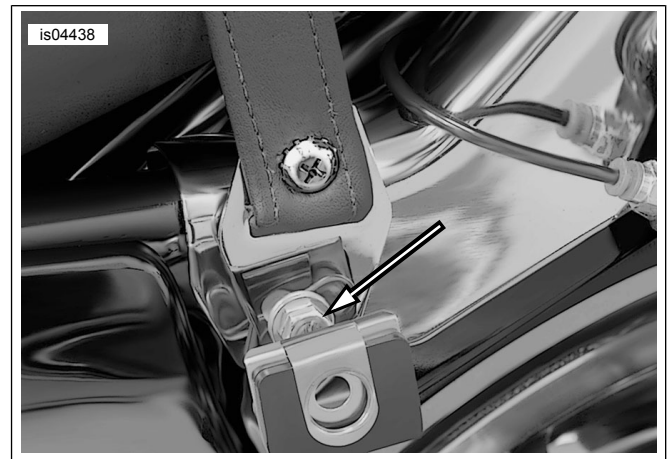

Figure 2. Passenger Grab Strap Removal (2008 Shown)

### INSTALLATION

1. Install the saddlebag mounting brackets with the bolts and washers (previously removed) in the same orientation. Leave fasteners loose.
2. See Figure 3 for grab strap installation configuration. See Figure 4. Install new grab strap with washer (9) and nut (7). Tighten nut to 11–18 N·m (96–156 in-lbs).
3. Install new seat (2) so that the slot in seat bottom engages with the tongue on the fuel tank bracket.



**NOTE**

The seat can be adjusted to eliminate the gap between the front of the seat and the rear of the fuel tank console.

- To adjust the seat, turn the seat over and loosen the two that secure the rear tab bracket (6). Slide the bracket forward or back as required. Tighten the button head screws to 10.8 N-m (96 in-lbs).

**▲ WARNING**

After installing seat, pull upward on seat to be sure it is locked in position. While riding, a loose seat can shift causing loss of control, which could result in death or serious injury. (00070b)

- Secure the seat onto the rear fender using the knurled knob (3) and washer (5).
- Remove backing from emblem (4) and apply to center of knurled knob (3). Press firmly to activate adhesive.

- Install saddlebags following the instructions in the service manual. Verify that the mounting hardware is tightened to specification.

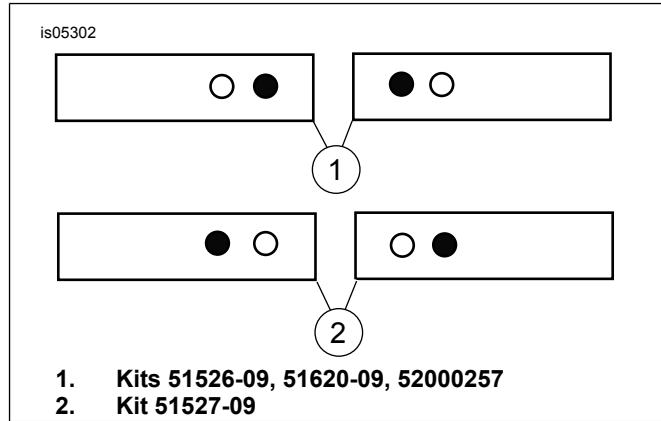

**Figure 3. Grab Strap Installation**

**SERVICE PARTS**

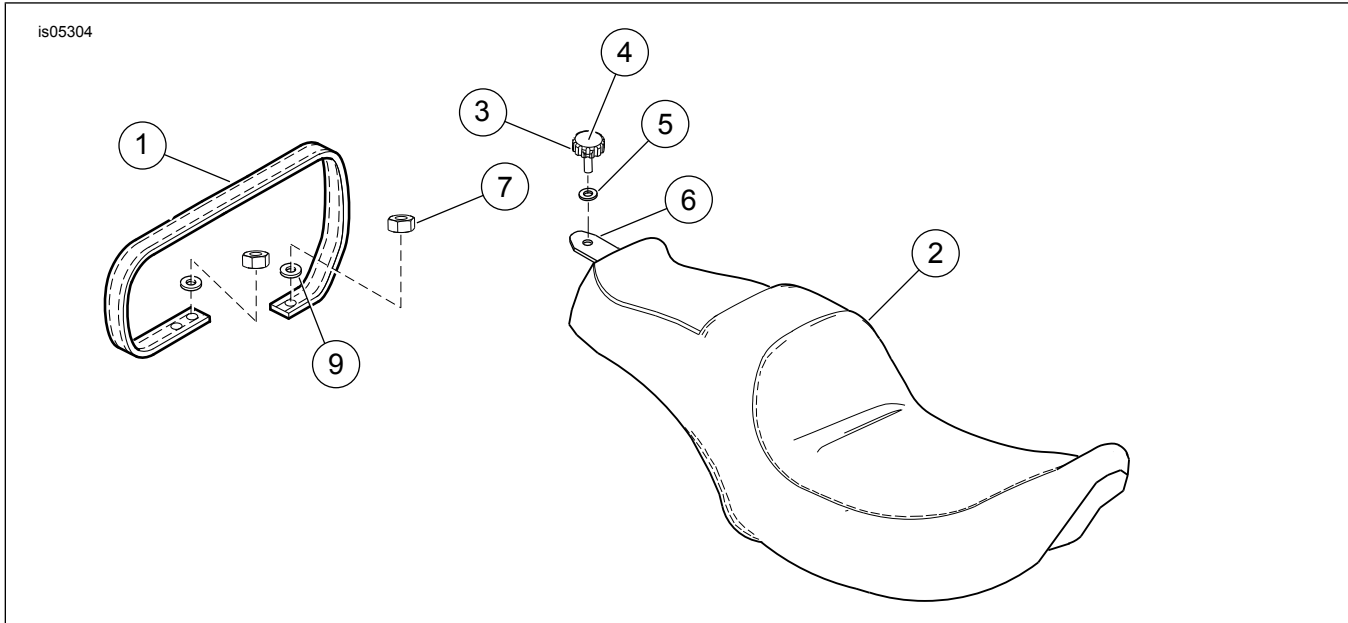

**Figure 4. Service Parts: Two-Up Seat Kits for Touring Models**

**Table 1. Service Parts: Two-Up Seat Kits for Touring Models**

Item	Description (Qty)	Part Number
1	Grab strap	51528-09
2	Seat	Not Sold Separately
3	Knob, knurled	3649
4	Emblem	14628-96
5	Washer	6205
6	Rear tab bracket kit (includes two button head mounting screws - not shown)	51966-09
7	Locknut (2)	7499
8	Leather dressing (not shown)	Not Sold Separately
9	Washer (2)	6036