



# INSTRUCTIONS

J04304

2017-10-30



## FOLDING HEEL SHIFTER KIT

### GENERAL

#### Kit Number

33876-07

#### Models

For model fitment information, please see the P&A Retail Catalog or the Parts and Accessories section of [www.harley-davidson.com](http://www.harley-davidson.com) (English only).

#### Installation Requirements

Loctite<sup>®</sup> 243 (Blue) Threadlocker and Sealant (H-D Part Number 99642-97) is required for the proper installation of this kit.

Proper installation of this kit also requires the re-attachment of the shifter peg. If replacement of the original equipment (O.E.) shifter peg is needed, refer to the Parts Catalog for your year and model vehicle.

See the P&A Retail Catalog or the Parts and Accessories section of [www.harley-davidson.com](http://www.harley-davidson.com) (English only) for a selection of Genuine Motor Accessory shifter pegs that are available. These can be easily installed at the same time as this kit.

#### Kit Contents

See Figure 1 and Table 1.

### REMOVAL

#### NOTE

*Before removing the original heel shift lever, note the orientation. You may want to replace the lever at the same angle.*

1. Remove shifter peg from original heel shift lever if reusing.

2. Remove original heel shift lever or shifter shaft cover. Retain socket head screw.

### INSTALLATION

1. See Figure 1. Position **new** heel shift lever so screw hole counterbore is facing down and at desired angle.

#### NOTE

*Original equipment heel shift lever may have socket head screw installed from the top or bottom depending on the model motorcycle. Install new heel shift lever so mounting screw installs **from the bottom**.*

2. Slide lever onto splined shifter shaft, aligning screw hole with notch on shaft.
3. Apply Loctite 243 (blue) to socket head screw removed earlier.

Consumable: LOCTITE 243 MEDIUM STRENGTH THREADLOCKER AND SEALANT (BLUE) (99642-97)

4. Insert screw into counterbored hole. Tighten.

Torque: 32–35 N·m (24–26 ft-lbs) *socket head screw*

#### NOTE

*For proper installation, ensure that the heel shifter is completely installed on shifter shaft and applied torque meets but does not exceed given range.*

5. If using original shifter peg, apply Loctite 243 (blue) onto screw threads.

Consumable: LOCTITE 243 MEDIUM STRENGTH THREADLOCKER AND SEALANT (BLUE) (99642-97)

6. Install shifter peg onto new shift lever. Tighten.

Torque: 11–16.4 N·m (97–145 **in-lbs**) *Shifter peg screw*

7. Check for proper operation and clearance.

## SERVICE PARTS

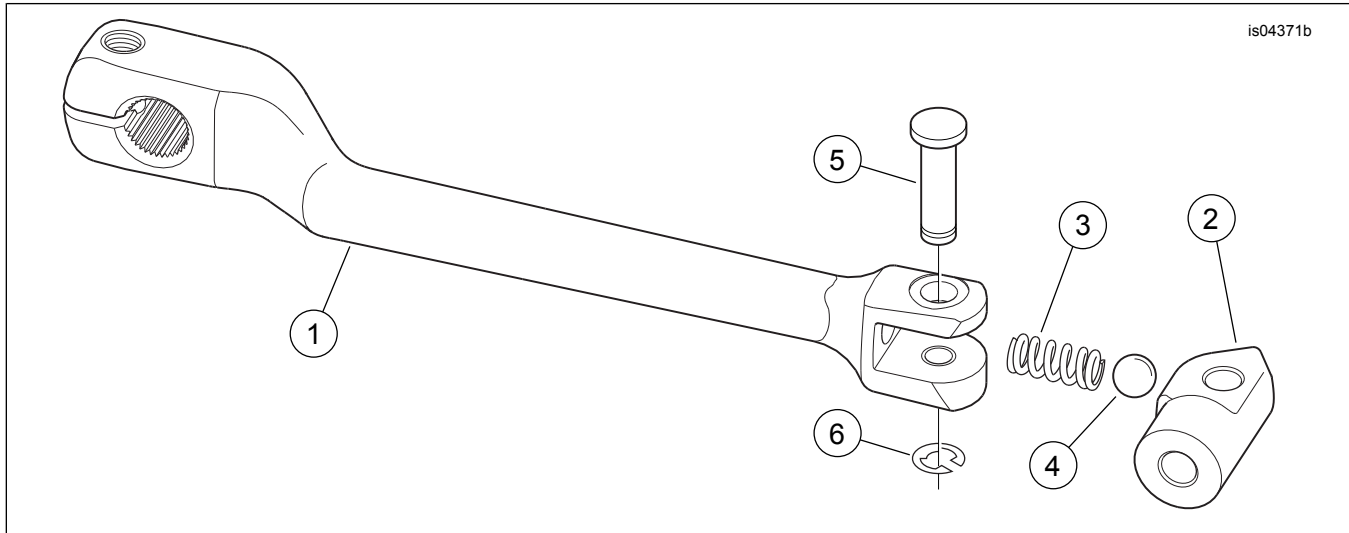

Figure 1. Service Parts, Folding Heel Shifter Kit

Table 1. Service Parts Table

Item	Description (Quantity)	Part Number
1	Lever, heel shifter	Not sold separately
2	Pivot, heel shifter lever	33897-07
3	Spring	33085-74
4	Ball	8861
5	Clevis pin	33806-08
6	Retaining ring	11665