



INSTRUCTIONS

J04649

2011-02-18



PASSENGER GRAB RAIL

GENERAL

Kit Number

97026-09 (chrome), 52400042 (gloss black)

Models

For model fitment information, see the P&A Retail Catalog or the Parts and Accessories section of www.harley-davidson.com (English only).

⚠ WARNING

Rider and passenger safety depend upon the correct installation of this kit. Use the appropriate service manual procedures. If the procedure is not within your capabilities or you do not have the correct tools, have a Harley-Davidson dealer perform the installation. Improper installation of this kit could result in death or serious injury. (00333b)

Kit Contents

See Figure 1 and Table 1.

INSTALLATION

NOTE

These grab rail kits can be installed over back rest kits 52587-09 and 52589-09.

1. Remove seat using owner's manual instructions.
2. Remove protective caps and nuts from stud plate. Save nuts for reuse. Leave plastic washers in place.
3. Apply protective tape (3) to the fender to align with the studs.
4. Install grab rail to stud plate and install nuts and tighten to 6.8–10.8 N·m (5–8 ft-lbs).

⚠ WARNING

After installing seat, pull upward on seat to be sure it is locked in position. While riding, a loose seat can shift causing loss of control, which could result in death or serious injury. (00070b)

5. Install seat.

SERVICE PARTS

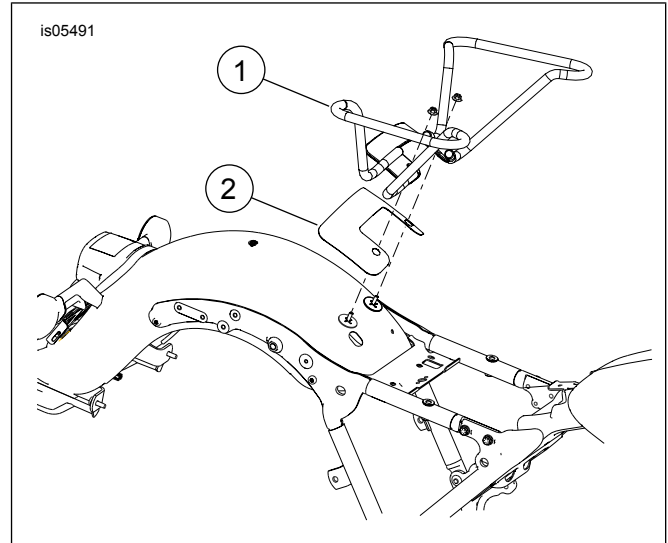

Figure 1. Service Parts: Passenger Grab Rail

Table 1. Service Parts

Item	Description (Quantity)	Part Number
1	Grab rail (chrome)	Not Sold Separately
2	Grab rail (gloss black)	Not Sold Separately
3	Protective tape	59574-09