



INSTRUCTIONS

J04034

2011-06-30



SOFTAIL SEAT KITS

GENERAL

Kit Numbers

51397-06A, 51468-06A, 51469-06A, 51470-06A, 51801-07, 52000025

Models

For model fitment information, see the P&A Retail Catalog or the Parts and Accessories section of www.harley-davidson.com (English only).

Kit Contents

See Figure 4 and Table 1.

Additional Parts Required

2006 FLSTFSE2 models require the separate purchase of Passenger Footpegs and Passenger Footpeg Mounting Kit (Part No. 50749-05).

A service manual for your model motorcycle is required for this installation and is available from a Harley-Davidson Dealer.

⚠ WARNING

Rider and passenger safety depend upon the correct installation of this kit. If the procedure is not within your capabilities or you do not have the correct tools, have a Harley-Davidson dealer perform the installation. Improper installation of this kit could result in death or serious injury. (00308b)

⚠ WARNING

Do not install these seat kits on motorcycles that are not equipped with an appropriate grab strap and passenger footpegs. If footpegs and grab strap are not installed, passenger could fall from moving motorcycle or grab onto operator, causing loss of control and death or serious injury. (00410b)

INSTALLATION

FXST, FXSTS, and FXSTB models

NOTE

When performing the following installation procedures, avoid scratching painted surfaces (fender, tank, etc.) with tools or metal seat tabs.

1. Remove existing seat from motorcycle by removing screw at rear bracket and unhooking front seat tab.
2. See Figure 4. Remove and discard existing grab strap and save mounting hardware from the motorcycle.

3. See Figure 4. Install the grab strap (7) from kit with the hardware saved in Step 2. Install the grab strap according to Figure 1.
4. Slide the back of the seat through grab strap and hook front tab of seat (1) into frame. Secure seat bracket to fender with screw (8).

⚠ WARNING

After installing seat, pull upward on seat to be sure it is locked in position. While riding, a loose seat can shift causing loss of control, which could result in death or serious injury. (00070b)

5. Pull seat up to verify it is securely installed.

is00420e

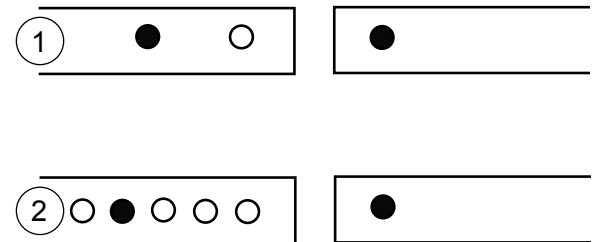

1. Kit Numbers: 51470-06A, 51397-06A, 52000025
- Grab Strap Numbers: 51184-00, 52400008
2. Kit Numbers: 51468-06A, 51469-06A, 51801-07
- Grab Strap Number 51176-96C

Figure 1. Grab Strap Installation Information

2007 and Later FXSTC Models

1. See the service manual and remove the stock seat and hardware.
2. Remove and discard the existing grab strap and mounting hardware.
3. Remove and discard the plug in the rear mounting position on the fender.
4. See Figure 2. Using the retaining nut (1), washer (2), and cable strap (3) from the kit. Install the nut and washer in the rear hole location on the fender. A cable strap can be used as an installation aid.

5. Position the retention nut (1) over the cable strap so that the wide end of the nut rests on the eye of the cable strap. Thread the cable up under the fender and through the rear most fender hole. Pull up on the cable strap to hold the nut snug against the underside of the fender.
6. With the rib on the retention nut seated into the notch in the fender hole, slide the retention washer (2) into place from the rear (this will lock the retention nut in place), and then remove the cable strap.
7. See Figure 4. Install the grab strap (7) from the kit using a screw (3) and washer (4).
8. Slide the back of the seat through the grab strap, and hook front tab of the seat (1) into the frame. Secure the seat bracket to the fender with screw (8).

⚠ WARNING

After installing seat, pull upward on seat to be sure it is locked in position. While riding, a loose seat can shift causing loss of control, which could result in death or serious injury. (00070b)

9. Pull seat up to verify it is securely installed.

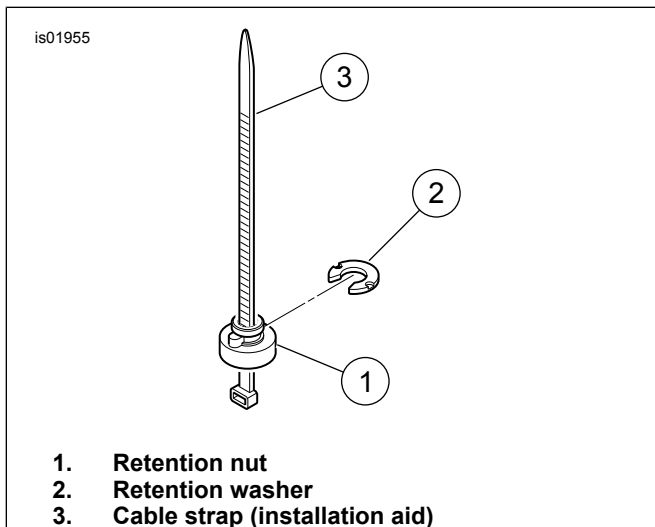

Figure 2. Retention Nut Installation

2007 and Later Fatboy Models

1. See the service manual and follow the instructions to remove the seat.
2. Remove and discard the existing grab strap and mounting hardware.
3. See Figure 3. Install two flange nuts (1) from the kit onto the seat mounting studs.
4. See Figure 4. Install the grab strap (7) from the kit to the grab strap location (as shown in Figure 3) with the screw (3), and washer (4) according to Figure 1.

5. Slide the back of the seat through the grab strap, and hook front tab of the seat (1) into the slot at the rear of the fuel tank and into the frame. Secure the seat bracket to the fender with screw (8).

⚠ WARNING

After installing seat, pull upward on seat to be sure it is locked in position. While riding, a loose seat can shift causing loss of control, which could result in death or serious injury. (00070b)

6. Pull seat up to verify it is securely installed.

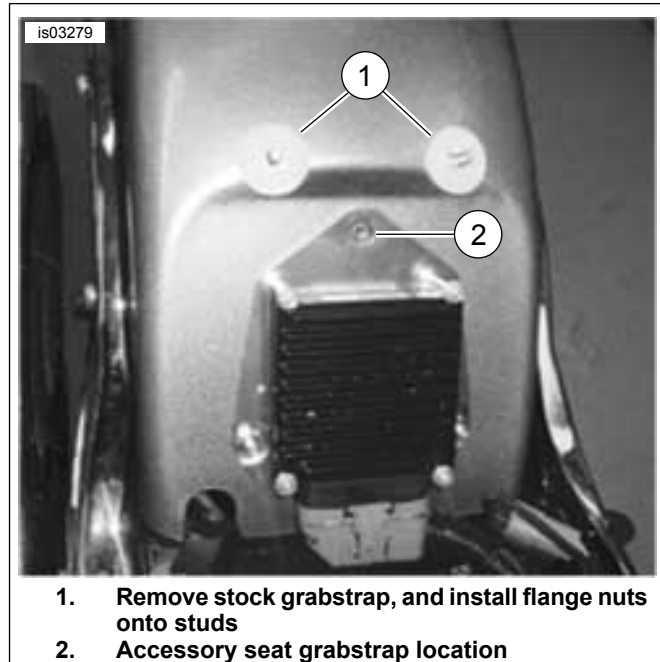

Figure 3. Grabstrap and flange nut installation for Fatboy models

2006 FLSTFSE2 models

When installing a 2-up seat onto a vehicle not equipped with passenger footpegs, install Passenger Footpeg Mounting Kit 50749-05 and passenger footpegs (purchased separately).

⚠ WARNING

Do not install these seat kits on motorcycles that are not equipped with an appropriate grab strap and passenger footpegs. If footpegs and grab strap are not installed, passenger could fall from moving motorcycle or grab onto operator, causing loss of control and death or serious injury. (00410b)

NOTE

When performing the following installation procedures, avoid scratching painted surfaces (fender, tank, etc.) with tools or metal seat tabs.

1. Refer to the service manual to remove stock seat and chrome tailpiece from the motorcycle.
2. See Figure 4. Install the grab strap (7) from kit using parts from the kit. See Figure 1 for the grab strap hole location.

3. Slide the back of seat through the grab strap. Hook front tab of seat (1) into the slot at the rear of the fuel tank, and into the frame; secure the seat bracket to the fender with screw (8) or fasten screw attached to bracket on seat (51397-06).

⚠ WARNING

After installing seat, pull upward on seat to be sure it is locked in position. While riding, a loose seat can shift causing loss of control, which could result in death or serious injury. (00070b)

4. Pull seat up to verify it is securely installed.

SERVICE PARTS

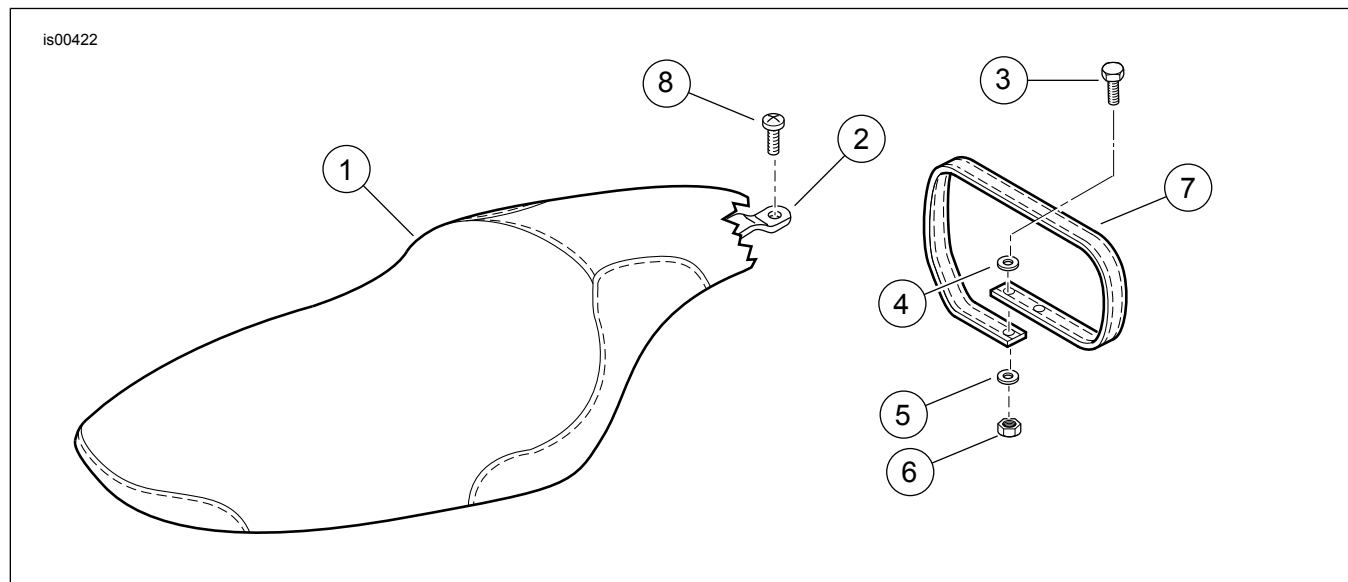

Figure 4. Service Parts: Softail Seats

Table 1. Service Parts Table

Item	Description (Quantity)	Part Number
1	Seat (Generic style shown)	Not sold separately
2	Bracket	51467-06
	Bracket (Kit 51397-06A)	51652-97
3	Screw	3767B
4	Washer	6036
5	Retention washer	See Service Kits
6	Retention nut	See Service Kits
7	Grab strap in 51397-06A	51184-00
	Grab strap in 51468-06A	51176-96C
	Grab strap in 51801-07	51176-96C
	Grab strap in 51469-06A	51176-96C
	Grab strap in 51470-06A	51184-00
	Grab strap in 52000025	52400008
8	Screw, rear seat bracket	2952A
9	Cable tie (not shown)	10039
10	Nut, flange (2) (not shown)	8021
11	Screw, small, flange head (2) (not shown)	3588
The following Service Kits are available:	Decorative Stud Kit (3 chrome studs, and 1 backing plate) (use with kit 51801-07)	58916-07
	Seat nut kit (includes 1 retention nut, and 1 retention washer)	59768-97