



# INSTRUCTIONS

J04531

2008-12-23



## ROAD TECH ZUMO XM SATELLITE RADIO ANTENNA KIT

### GENERAL

#### Kit Number

92382-08A

#### Models

This XM Satellite Radio Antenna Kit is an optional accessory for the Road Tech™ Zumo® GPS (Part No. 92357-08) on specific model motorcycles. For model fitment information, see the P&A retail catalog or the Parts and Accessories section of [www.harley-davidson.com](http://www.harley-davidson.com) (English only).

#### NOTE

*XM satellite radio is available within the continental United States. It is not available in Alaska or Hawaii.*

#### Additional Parts Required

#### NOTE

*Along with the Road Tech Zumo GPS and GPS mounting kit, an XM satellite radio subscription is required, for an additional fee.*

**For FLHT models without radio:** See the P&A retail catalog or the Parts and Accessories section of [www.harley-davidson.com](http://www.harley-davidson.com) (English only) for a selection of Genuine Motor Accessory earbuds or helmet headsets that will allow use of the XM satellite radio and the turn-by-turn voice instruction feature of the Road Tech Zumo.

#### ⚠ WARNING

**Rider and passenger safety depend upon the correct installation of this kit. Use the appropriate service manual procedures. If the procedure is not within your capabilities or you do not have the correct tools, have a Harley-Davidson dealer perform the installation. Improper installation of this kit could result in death or serious injury. (00333b)**

#### NOTE

*This instruction sheet refers to service manual information. A service manual for this year/model motorcycle is required for this installation and is available from a Harley-Davidson dealer.*

#### Kit Contents

See Figure 3 and Table 1.

### INSTALLATION

#### Preparation

**Models with main FUSE:**

#### ⚠ WARNING

**To prevent accidental vehicle start-up, which could cause death or serious injury, remove main fuse before proceeding. (00251b)**

1. Refer to the service manual and follow the instructions given to remove the main fuse.

**Models with main CIRCUIT BREAKER:**

#### ⚠ WARNING

**To prevent accidental vehicle start-up, which could cause death or serious injury, disconnect negative (-) battery cable before proceeding. (00048a)**

1. Refer to the service manual and follow the instructions given to remove the seat and disconnect the negative (black) battery cable from the negative (-) battery terminal. Retain all seat mounting hardware.
2. If not already in place, install the Road Tech Zumo GPS mount per the instructions in **that** kit.
3. Remove the outer fairing and windshield. Refer to the service manual.

#### Installation, FLH models

See Figure 1. The XM antenna (1) will be positioned on top of the AM/FM radio receiver (2), or storage box (on models without an AM/FM radio).

Mount the antenna as far toward the front of the vehicle as possible without extending beyond the front edge of the radio or storage box.

1. Obtain the XM antenna from the kit. Clean the top of the radio or storage box, and the underside of the antenna with a mixture of 50 to 70% isopropyl alcohol and 30 to 50% distilled water. Allow to dry thoroughly.
2. Obtain the four Dual Lock™ reclosable fasteners (3) from the kit. Peel the liner from the adhesive backing of **two** of the fasteners. Carefully position the fasteners to the underside of the antenna, keeping about a 1/4-inch (6 mm) gap between the pieces, and press firmly into place. Trim the fasteners close to the perimeter of the antenna.
3. Assemble the remaining Dual Lock fasteners squarely to the fasteners on the antenna. Peel the liner from the adhesive backing of the fasteners.

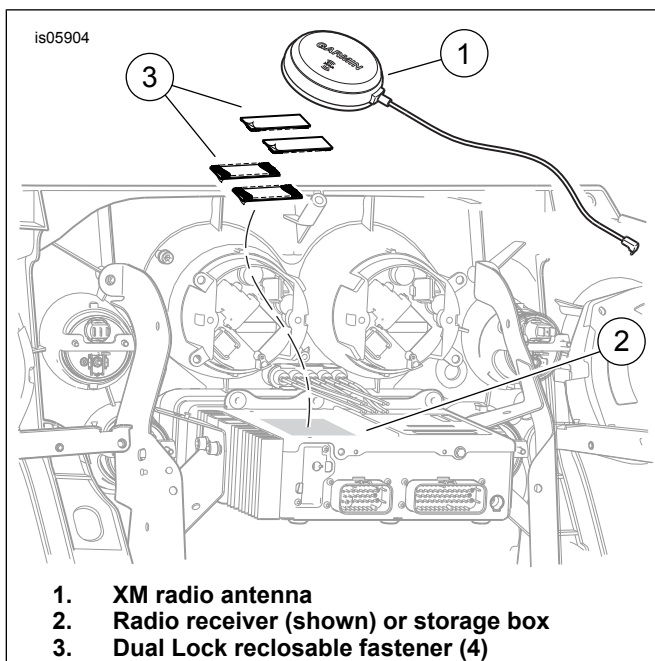

**Figure 1. XM Radio Antenna Installation (FLH Models)**

4. Position the antenna in the desired location on the top of the radio or storage box, and press firmly into place. Hold for about sixty seconds to set the adhesive. After releasing pressure, allow about twenty minutes before exerting force on the antenna.
5. Remove the GPS cradle mount and mounting base from the inner fairing.
6. Route the antenna cable up through the GPS grommet in the fairing.
7. Install the GPS mounting base and tighten to 5.65–6.78 N·m (50–60 **in-lbs**).
8. Reinstall the GPS cradle to the mounting base, routing the antenna cable in the channel between the base and cradle. Tighten to 1.58–2.26 N·m (14–20 **in-lbs**).
9. Plug the antenna cable into the cradle. Proceed to **Return to Service**.

## Installation, FLTR models

1. See Figure 3. Obtain the XM satellite radio antenna (1), the antenna mounting bracket (4) and two flat head screws (2) from the kit. Position the antenna over the mounting bracket in the orientation shown.
2. Line up the mounting holes on the underside of the antenna with the holes in the bracket. Fasten the antenna to the bracket with the flat head screws, and tighten to 0.68–1.13 N·m (6–10 **in-lbs**).
3. See Figure 2. Obtain the 1/4-20 x 5/8 inch button head cap screw (2) from the kit.
4. Remove the two right-side radio mounting screws (1).

5. Insert the **new** button head cap screw (2) into the upper (rearward) radio mounting hole, through the radio carrier bracket to the radio, and tighten to 4–5.1 N·m (35–45 **in-lbs**).

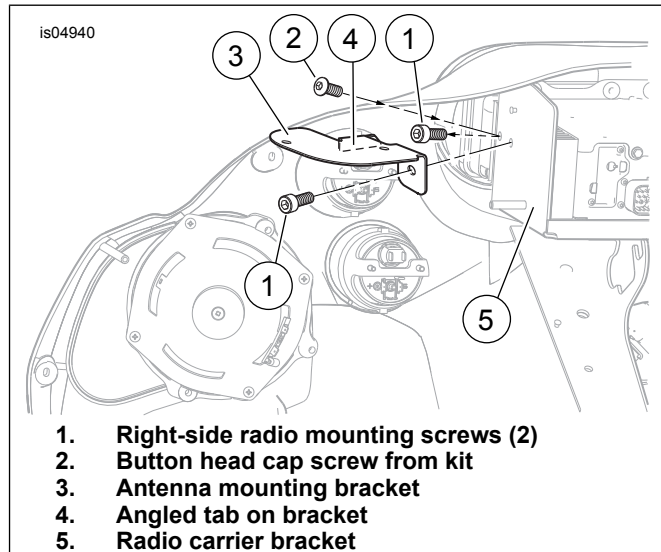

**Figure 2. XM Radio Bracket Installation (FLT Models)**

6. Position the antenna bracket (3) to the side of the radio carrier bracket (5) with the angled tab (4) aligned with the front of the radio bracket.
7. Line up the hole in the antenna bracket with the remaining radio mounting hole. Fasten the antenna bracket through the radio carrier bracket to the radio with one of the screws removed earlier. Tighten to 4–5.1 N·m (35–45 **in-lbs**).
8. Route the antenna cable down to the steering neck, and up to the left side of the handlebar. Ensure enough slack for steering.
9. Plug the antenna cable into the GPS cradle. Use cable straps (5) from the kit to secure the cable to the handlebar.

## Return to Service

1. Verify that the Ignition/Light Key Switch is turned to the OFF position. **Models with main FUSE:** Refer to the service manual and follow the instructions given to install the main fuse. **Models with main CIRCUIT BREAKER:** Apply a light coat of Harley-Davidson electrical contact lubricant (part number 99861-02), petroleum jelly or corrosion retardant material to the negative battery terminal. Refer to the service manual and follow the instructions given to attach the negative battery cable. Refer to the service manual, and follow instructions to install the seat.

### ⚠ WARNING

**After installing seat, pull upward on seat to be sure it is locked in position. While riding, a loose seat can shift causing loss of control, which could result in death or serious injury. (00070b)**

2. Test the XM antenna by navigating to the XM functions in the GPS unit. See the Road Tech Zumo user manual.

3. Install the outer fairing and windshield. Refer to the service manual.

## SERVICE PARTS

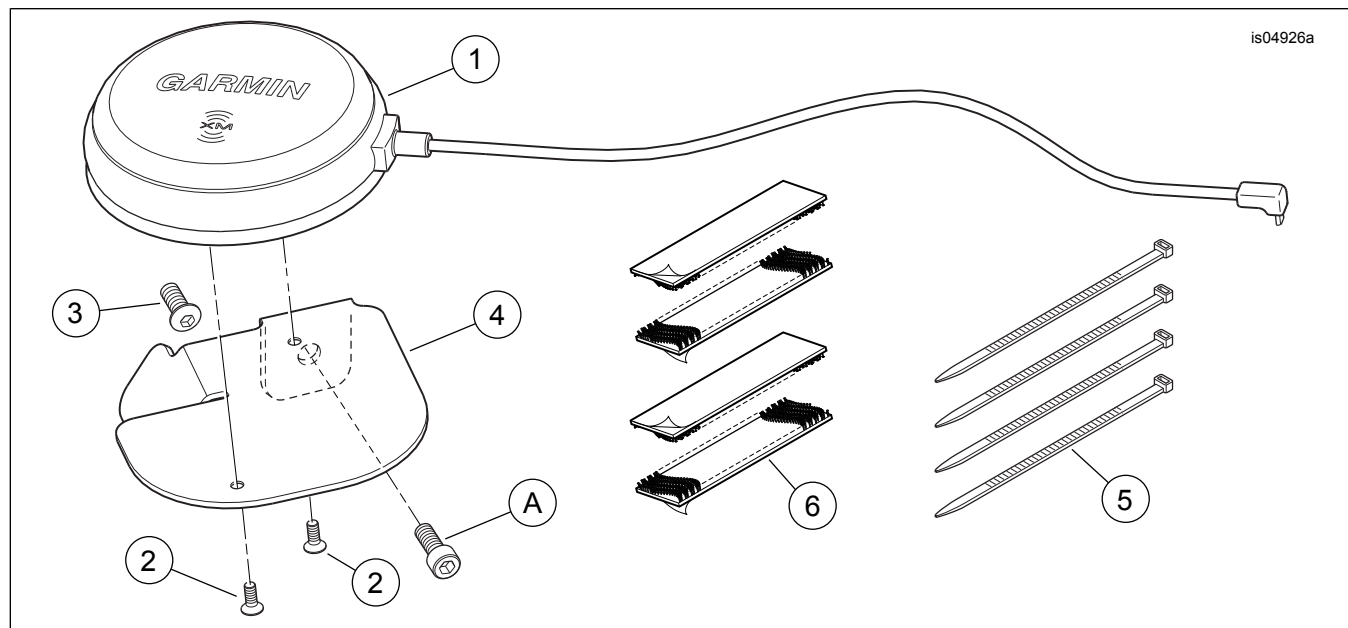

Figure 3. Service Parts, XM Satellite Radio Antenna

Table 1. Service Parts Table

Item	Description (Quantity)	Part Number
1	Antenna, Zumo XM satellite radio	Not sold separately
2	Flat head screw, M3 x 8 mm long (2)	4496M
3	Hex socket button head screw, 1/4-20 x 5/8 inch long	924
4	Bracket, antenna mounting (for FLTR models)	Not sold separately
5	Cable strap (4)	10006
6	Fastener, reclosable, Dual Lock™ (4)	76434-06
<b>Item mentioned in text, but not included in kit:</b>		
A	Radio mounting screw	