



INSTRUCTIONS

J04038

2008-07-07



FAT HANDLEBAR RISER KIT

GENERAL

Kit Number

56916-07, 55996-09

Models

For model fitment information, see the P&A Retail Catalog or the Parts and Accessories section of www.harley-davidson.com (English only).

Additional Parts Required

Proper installation of this kit requires the prior or concurrent installation of an appropriate Harley-Davidson 1-1/4 inch handlebar kit. Contact a Harley-Davidson dealer to determine which kits will fit your model motorcycle.

Proper installation of this kit may require longer cables, brake lines or wires. Contact a Harley-Davidson dealer to determine if your application requires additional parts.

⚠ WARNING

Rider and passenger safety depend upon the correct installation of this kit. Use the appropriate service manual procedures. If the procedure is not within your capabilities or you do not have the correct tools, have a Harley-Davidson dealer perform the installation. Improper installation of this kit could result in death or serious injury. (00333b)

NOTE

This instruction sheet references service manual information. A service manual for your model motorcycle is required for this installation and is available from a Harley-Davidson Dealer.

Kit Contents

See Figure 1 and Table 1.

REMOVAL

NOTE

Cover the fuel tank with clean shop towels to prevent scratching. Damage to the finish could result.

If replacing the handlebar, refer to the appropriate service manual to remove controls, hand levers, handlebar and risers.

If only the risers are being replaced, proceed as follows:

1. Remove four screws and riser clamp (or two riser caps) from the risers. Carefully, allow the handlebar with attached gauges to rest on the motorcycle.

2. Remove two riser mounting screws (I) from under the upper fork bracket. Remove risers and hardware. Note the order of the hardware as it is removed and retain it for later installation. Discard stock risers and riser clamp (or caps).

INSTALLATION

NOTE

The upper cup washer (A) must be oriented with the flat side up and the lower cup washer (D) with the flat side down.

See Figure 1 for the following procedure.

1. Align the components as shown, and install the risers (2) to the upper fork bracket. The ground wire (G) and the internal tooth lock washer (H) are located on the right side only. Do not tighten the riser mounting screws (I) at this time.
2. If an appropriate Harley-Davidson 1-1/4 inch handlebar has not been installed, install one according to the Instruction Sheet included with the kit, or install the existing 1-1/4 inch handlebar assembly onto the risers.
3. Loosely install riser caps (1) or riser clamp (4) onto the handlebars and risers using four socket head screws (3 or 6) as shown.
4. Verify that the risers stay properly aligned with the handlebar and tighten the riser mounting screws (I) to 68–81 N·m (50–60 ft·lbs).

⚠ WARNING

Be sure handlebar risers are firmly locked into desired position before operating motorcycle. Movement of the handlebar can distract the rider and lead to loss of control, which could result in death or serious injury. (00394d)

5. Adjust handlebar to the desired position, and verify that the handlebar is centered on the riser. **For Fat Bar Riser:** Tighten screws to 16–20 N·m (12–15 ft·lbs). **For Black Handlebar Riser:** Tighten screws to 16–20 N·m (12–15 ft·lbs).
6. Turn the handlebars full right and left. Check that:
 - The handlebars and triple tree clamps do not contact the fuel tank.
 - The steering stops function properly.
 - The wiring and brake line are not pinched or kinked in the steering assembly.
 - Throttle returns from full open to close at both fork stops.



▲ WARNING

Install proper length brake lines. Incorrect brake line length can adversely affect motorcycle operation, which could cause loss of control resulting in death or serious injury. (00325a)

- If you are installing different handlebars, measure the change in distance that will be required from the end of the stock brake line to the brake master cylinder.
- Compare this revised length to the brake line provided in your kit.
- If the line is more than 2.0 in (50.8 mm) longer or more than 1.0 in (25.4 mm) shorter than the above measured distance, see a Harley-Davidson dealer for the correct brake line length.

SERVICE PARTS

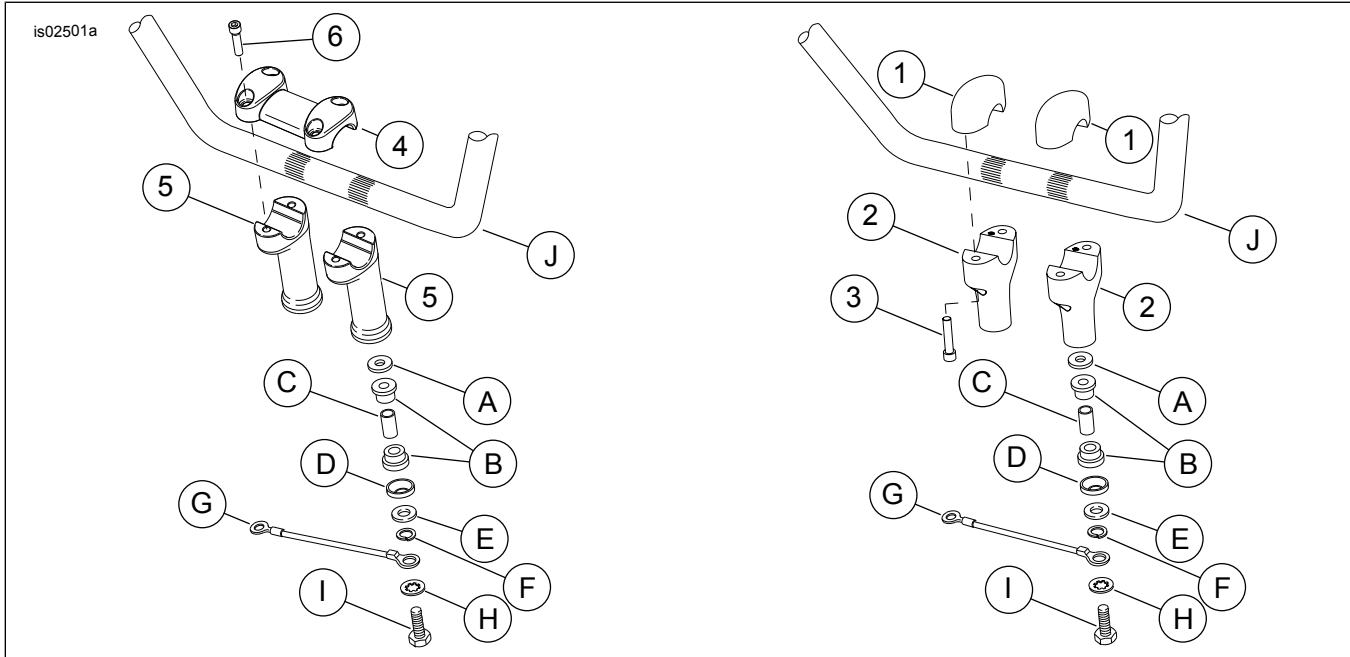

Figure 1. Service Parts for Fat Bar Riser Kit

Table 1. Service Parts Table

Item	Description (Quantity)	Part Number
	Fat bar riser kit	56916-07
1	• Cap, riser (2)	Not Sold Separately
2	• Riser (2)	Not Sold Separately
3	• Screw, socket hex (4)	4816A
	Black riser and clamp kit	55996-09
4	• Cap, riser	Not Sold Separately
5	• Riser (2)	Not Sold Separately
6	• Screw, socket hex (4)	3153
Items mentioned in text, but not included in kit:		
A	Cup washer (upper) (flat side up)	
B	Bushing (2)	
C	Spacer	
D	Cup washer (lower) (flat side down)	
E	Washer	
F	Lock washer	
G	Ground wire	
H	Internal tooth lock washer	
I	Screw, riser mounting	
J	Handlebar	