



INSTRUCTIONS

J04665

2008-08-19



VOLTAGE REGULATOR DC CONNECTOR ASSEMBLY KIT

GENERAL

Kit Number

Y1312.02A8

Models

For model fitment information, see the Buell Accessories and Parts Countertop Reference Guide (CRG) or the Accessories section of www.buell.com (English only).

Additional Parts Required

Separate purchase of LOCTITE® 222 - MS Threadlock and Sealant (Purple) and LOCTITE® 243 - Threadlock and Sealant (Blue) are required for proper installation of this kit. LOCTITE can be purchased from any Buell Dealer.

Special Tools Required

Two crimping tools (HD-38125-6 and HD-38125-7) are required for installation of this kit and are available from a Buell dealer.

⚠ WARNING

The rider's safety depends upon the correct installation of this kit. If the procedure is not within your capabilities or you do not have the correct tools, have a Buell dealer perform the installation. Improper installation of this kit could result in death or serious injury. (00309a)

Kit Contents

See Figure 7 and Table 1.

REMOVAL

Prepare the Vehicle

1. Remove seat following the instructions in the owner's manual.

⚠ WARNING

To prevent accidental vehicle start-up, which could cause death or serious injury, disconnect negative (-) battery cable before proceeding. (00048a)

2. Disconnect negative (-) battery cable.
3. See Figure 1. Remove the two rear screws and washers on the chin fairing to release the sprocket cover. Save hardware for installation.

4. See Figure 2. Remove the long screw and washer (1) and short screws and washers (3) and remove sprocket cover (2) from behind the chin fairing. Save the hardware for installation.

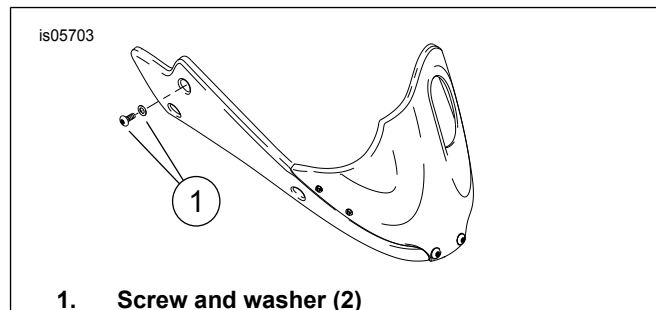

Figure 1. Remove Chin Fairing Fasteners

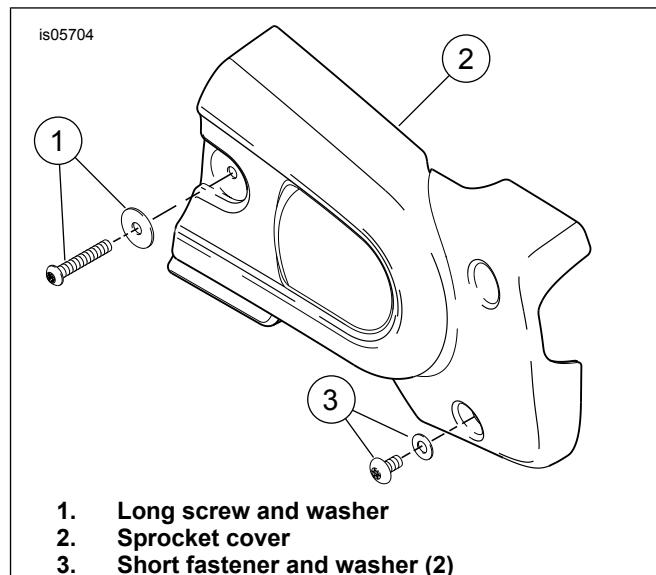

Figure 2. Remove Sprocket Cover

Wiring

NOTE

When disconnecting the regulator wiring, pull the connector halves apart by firmly grasping both connector halves. Do not pull on leads or damage to the wires and/or terminals may result.

For connector locations, refer to the appropriate figure, Figure 3, Figure 4, Figure 5 or Figure 6.

1. Disconnect the voltage regulator connector [77] (1) located behind the sprocket cover.

NOTE

Note locations of cable straps and connectors for installation.

2. Remove cable straps to release the voltage regulator cable.

NOTE

Make note of wire locations in connector. If necessary, label wires before removing the connector.

3. Remove the terminals from both halves of stock voltage regulator connector [77] following the instructions in the service manual. Cut all four wires as close to the terminals as possible. Discard the terminals and connectors.

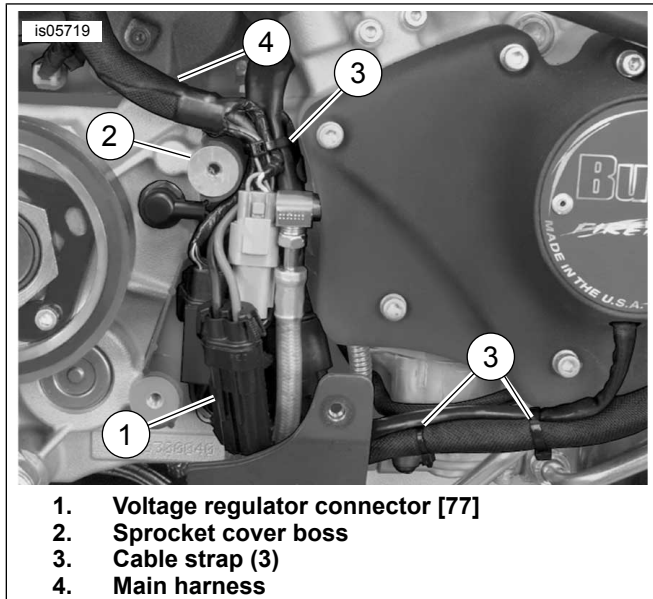

Figure 3. 2003 Firebolt Models - Sprocket Cover Wiring and Connectors

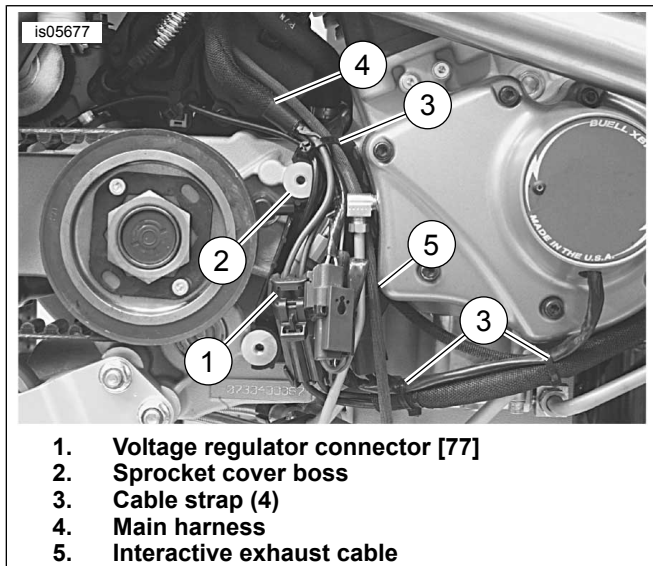

Figure 4. 2004-2005 Firebolt Models - Sprocket Cover Wiring and Connectors

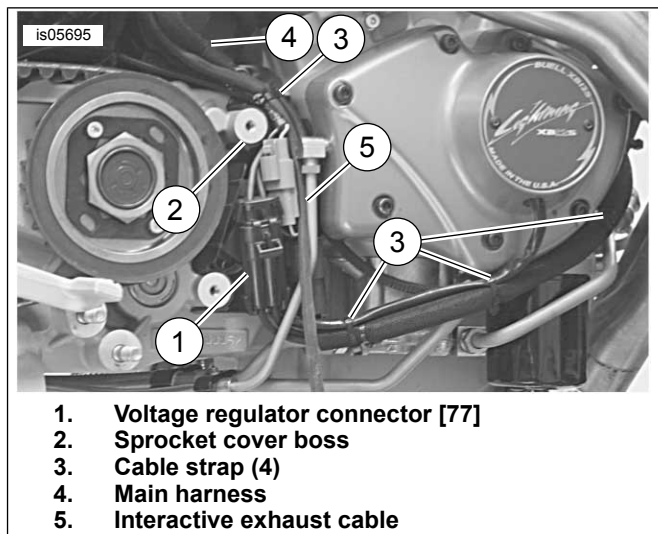

Figure 5. 2004-2005 Lightning Models - Sprocket Cover Wiring and Connectors

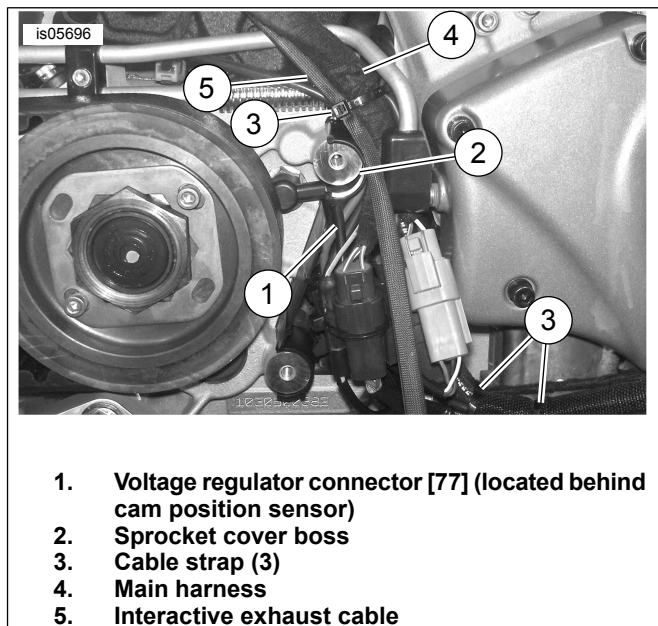

Figure 6. 2006-2007 Firebolt, Lightning and Ulysses Models - Sprocket Cover Wiring and Connectors

INSTALLATION

New Wiring

NOTE

Use crimpers (HD-38125-6 and HD-38125-7). Use the nest D for core crimp and the nest 5 for the insulation crimp. See the service manual for crimping instructions.

1. See Figure 7. Install socket terminals (3), locking wedge (2) and socket housing (1) on the engine harness with crimping tools (HD-38125-6 and HD-38125-7).
2. Install pin terminals (6), locking wedge (5) and pin housing (4) on the regulator harness with crimping tools.
3. Connect the voltage regulator connector [77] (1).

NOTE

Keep all wiring and connectors clear of the sprocket.

4. Tuck connectors into place and verify that all wires are tucked securely behind the wire guards to prevent pinching, crimping or rubbing.
5. Install cable straps (7) in the same locations as the stock cable straps.

Final Assembly

1. See Figure 2. Position sprocket cover (2) over front sprocket and behind the chin fairing. Verify that the cover fits tightly against the sprocket cover bosses with no interference from connectors or wires.
2. Apply LOCTITE 222 (purple) to the threads of the long fastener (1). Install long fastener and washer. Install short fasteners and washers (3). Tighten fasteners to 1–4 N·m (12–36 in-lbs).
3. See Figure 1. Apply LOCTITE 243 (blue) on fasteners and tighten to 4–5 N·m (36–48 in-lbs).
4. Connect negative (-) battery cable to battery terminal.
5. Test charging system following the instructions in the service manual.

⚠ WARNING

After installing seat, pull upward on seat to be sure it is locked in position. While riding, a loose seat can shift causing loss of control, which could result in death or serious injury. (00070b)

6. Install seat following the instructions in the owner's manual.

SERVICE PARTS

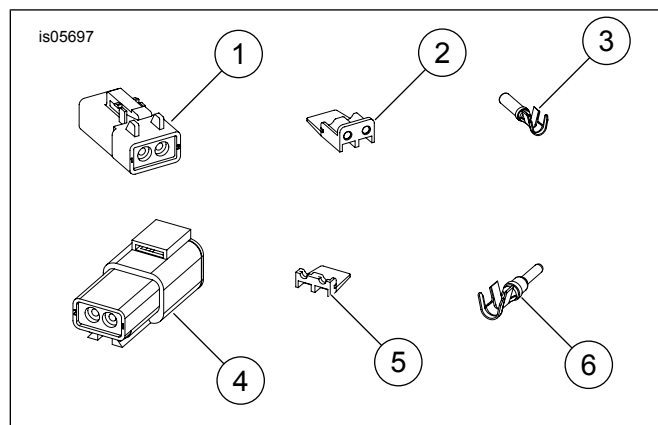

Figure 7. Service Parts: Voltage Regulator Connector Kit

Table 1. Service Parts: Voltage Regulator Connector Kit

Item	Description (Quantity)	Part Number
1	Socket housing, 2-way, black	72612-06BK
2	Locking wedge, socket	72652-06
3	Socket terminal, #10 AWG (2)	72694-06
4	Pin housing, 2-way, black	72602-06BK
5	Locking wedge, pin	72642-06
6	Pin terminal, #10 AWG (2)	72693-06
7	Cable strap, 6 inch (4) (not shown)	Y0303.2B