



INSTRUCTIONS

J04454

2008-11-14



DETACHABLE SADDLEBAG LOWER SUPPORT BRACKET KIT

GENERAL

Kit Numbers

88329-07, 88330-07, 88258-07, 88259-07, 88260-07

Models

For model fitment information, see the P&A Retail Catalog or the Parts and Accessories section of www.harley-davidson.com (English only).

Table 1. Kit Contents

Lower Support Arm Kit	Saddlebag Kit	Right or Left
88258-07	88237-07	Right
88259-07	88237-07	Left
88260-07	88238-07	Right
88329-07	88306-07	Right
88330-07	88238-07 88306-07	Left

Kit Contents

See Figure 1 and Table 2.

⚠ WARNING

The lower saddlebag support bracket is not a footrest or step. Using the support bracket as either a footrest or step can cause the supports to separate from the docking points and fall to the road, which could cause loss of control and death or serious injury. (00405e)

REMOVAL

⚠ WARNING

To prevent accidental vehicle start-up, which could cause death or serious injury, disconnect negative (-) battery cable before proceeding. (00048a)

⚠ WARNING

To prevent accidental vehicle start-up, which could cause death or serious injury, remove main fuse before proceeding. (00251b)

1. Refer to the owner's manual and follow the instructions given to remove the seat and disconnect the negative (-) battery cable or remove main fuse.
2. Open the saddlebag, then pull the latch knob and rotate it one-quarter turn. The latch on the back of the bag should swing into the open position.
3. Pull the saddlebag toward the rear of the vehicle to disengage the three docking points.

4. Lift the saddlebag up and swing the lower support arm off of its docking point.
5. Remove the three screws and washers holding the lower support bracket to the saddlebag and remove the lower support bracket.

INSTALLATION

1. See Figure 1. Install the lower support bracket (1, 2, 3, 4 or 5), lockwashers (6), washers (7) and screws (8). Do not fully tighten.
2. Tip the saddlebag forward and align the large diameter of the keyhole end of the lower support arm with the third point docking point. Rotate the saddlebag down so that the docking points on the strut cover slide into the slots of the bracket on the back of the saddlebag.
3. Slide the saddlebag forward on the vehicle verifying that it is fully seated onto all three docking points.
4. Move the bag as far forward as possible and rotate the latch knob one-quarter turn. If the bag is seated properly, the knob should pop back in. Check behind the bag and verify that the latch is in the closed position.

NOTE

If the saddlebag is not seated, loosen the screws securing the lower support bracket to the saddlebag frame and slide the support rod forward or backward in its mounting slots. Tighten locknuts to 7–10 N·m (60–90 in-lbs) after seating the saddlebag.

5. Adjust the lower support bracket so it has maximum engagement in the docking point. Tighten screws to 7–10 N·m (60–90 in-lbs).
6. Repeat procedure for the opposite saddlebag.

Return to Service

1. Connect the negative (-) battery cable or install the main fuse, following the instructions in the owner's manual.

⚠ WARNING

After installing seat, pull upward on seat to be sure it is locked in position. While riding, a loose seat can shift causing loss of control, which could result in death or serious injury. (00070b)

2. Install the seat following the instructions in the owner's manual.



SERVICE PARTS

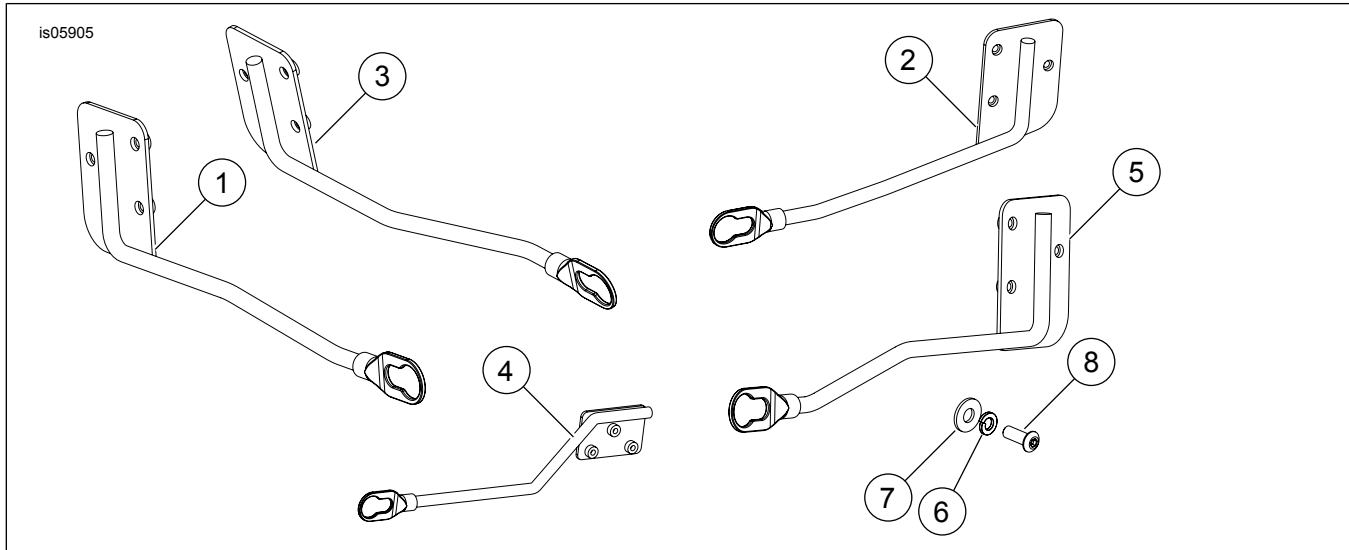

Figure 1. Service Parts: Detachable Saddlebag Lower Support Bracket Kit

Table 2. Service Parts Table

Item	Description (Quantity)	Part Number
1	Lower support bracket, right	Not Sold Separately
2	Lower support bracket, left	Not Sold Separately
3	Lower support bracket, right	Not Sold Separately
4	Lower support bracket, right	Not Sold Separately
5	Lower support bracket, left	Not Sold Separately
6	Lockwasher (3)	7041
7	Washer (3)	6333
8	Screw, 5/16-18x 7/8 inch (3)	4359