



# INSTRUCTIONS

J04456

2011-06-30



## ROAD ZEPPELIN SEAT

### GENERAL

#### Kit Number

51072-09

#### Models

For model fitment information, see the P&A Retail Catalog or the Parts and Accessories section of [www.harley-davidson.com](http://www.harley-davidson.com) (English only).

#### Additional Parts Required

##### NOTICE

It is possible to overload the vehicle's charging system by adding too many electrical accessories. If the combined electrical accessories operating at any one time consume more electrical current than the vehicle's charging system can produce, the electrical consumption can discharge the battery and cause damage to the vehicle's electrical system. (00211d)

##### ⚠ WARNING

When installing any electrical accessory, be certain not to exceed the maximum amperage rating of the fuse or circuit breaker protecting the affected circuit being modified. Exceeding the maximum amperage can lead to electrical failures, which could result in death or serious injury. (00310a)

This Road Zeppelin Seat kit requires up to **6.0 amps** additional current from the electrical system.

Separate purchase of an accessory Y Connector (70264-94) if additional accessories are to be connected to the accessory circuit connector. See a Harley-Davidson dealer for more information.

##### ⚠ WARNING

Rider and passenger safety depend upon the correct installation of this kit. Use the appropriate service manual procedures. If the procedure is not within your capabilities or you do not have the correct tools, have a Harley-Davidson dealer perform the installation. Improper installation of this kit could result in death or serious injury. (00333b)

##### NOTE

This instruction sheet references service manual information. A service manual for your model motorcycle is required for this installation and is available from a Harley-Davidson Dealer.

### Kit Contents

##### NOTICE

There are no serviceable parts inside the unit; leave all servicing to qualified service personnel. Disassembly of the unit could result in equipment damage and/or equipment malfunction. (00172a)

- Disassembly of the seat will void the manufacturer's warranty.

See Figure 8 and Table 1.

### REMOVAL

##### ⚠ WARNING

To prevent accidental vehicle start-up, which could cause death or serious injury, remove main fuse before proceeding. (00251b)

1. Remove main fuse following the instructions in the service manual.

##### NOTE

Cover the painted surfaces with protective material to prevent scratches or other damage.

2. Remove the left and right side saddlebags following the instructions in the owner's manual.
3. See Figure 2. Remove the screw (1) and lockwashers (2) securing the grab strap (3) to the bracket (4 or 6). Save the hardware for installation.
4. Remove the grab strap.
5. Remove seat following the instructions in the service manual.
6. If equipped, remove fender trim strips:
  - a. Cover the tip of a regular screwdriver with a piece of tape to protect chrome and painted surfaces.
  - b. See Figure 1. Insert the tip of the screw driver between the chrome bezel and the rubber trim strip.
  - c. Pry up the bezel enough to get a hold of it, then pull it up and away from the rubber trim strip.
  - d. Starting at either end, peel the rubber trim strip away from the fender.
  - e. Clean any remaining adhesive off of the fender using an approximately 1:1 solution of distilled water and isopropyl alcohol.

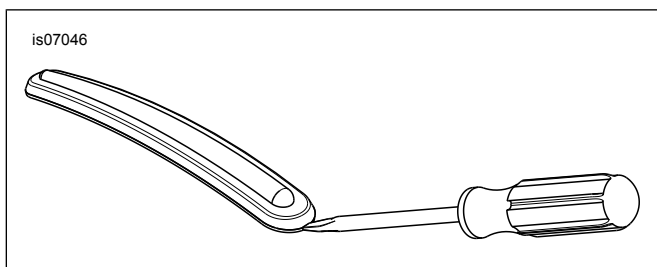

**Figure 1. Remove Fender Trim Strip**

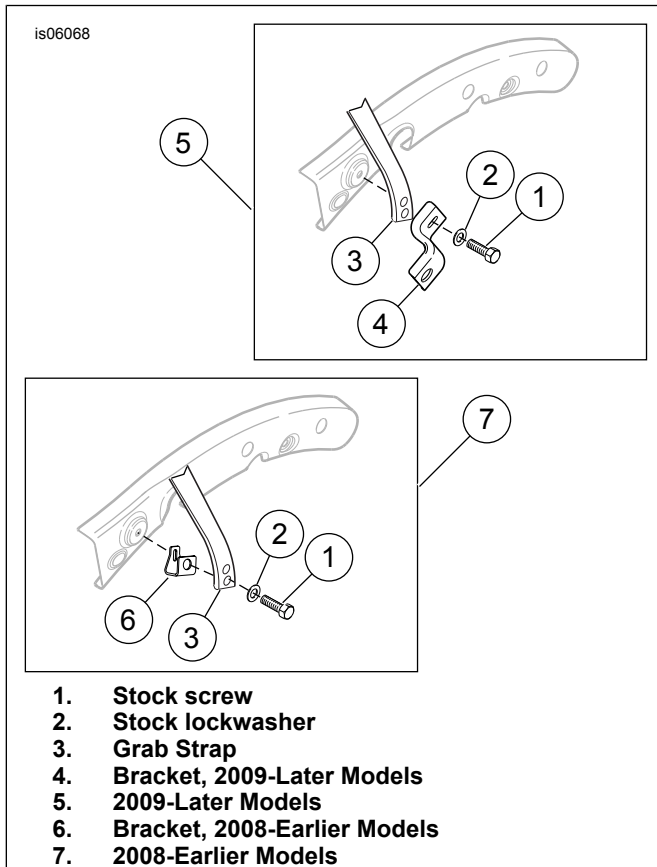

**Figure 2. Grab Strap and Saddlebag Front Mounting Bracket**

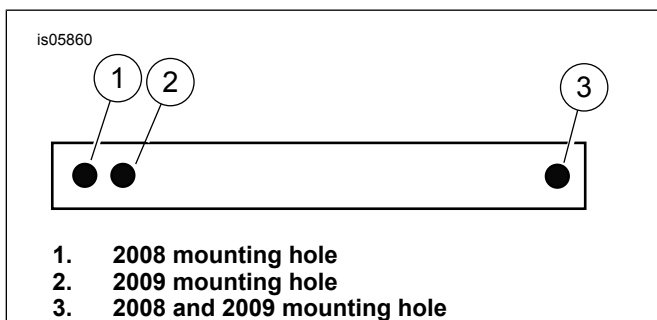

**Figure 3. Grabstrap for Kit 53051-09**

## INSTALLATION

1. See Figure 4. Remove rubber plug from accessory connector (1) located under seat. Plug the seat electrical connector into the accessory connector. The connectors should lock together with an audible click.

2. Position the seat on the frame. Make sure the electrical harness and connector are not pinched between the seat and frame.
3. Install the seat following the instructions in the service manual.

### ⚠ WARNING

**After installing seat, pull upward on seat to be sure it is locked in position. While riding, a loose seat can shift causing loss of control, which could result in death or serious injury. (00070b)**

4. Install seat mounting screw and tighten securely. If Tour-Pak was loosened, tighten screws.
5. See Figure 3. Install the grab strap behind the saddlebag mounting bracket (4) using the holes shown.
6. Tighten stock screws to 20–27 N·m (15–20 ft-lbs).
7. Install main fuse.

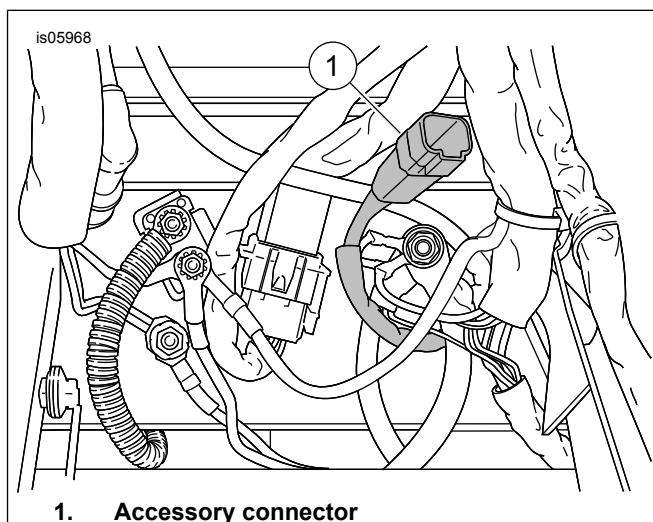

**Figure 4. Accessory Connector Location (Under Seat)**

## OPERATION

The seat will operate with the ignition switch ON or in the ACCESSORY position. For vehicles with a fairing, verify the accessory switch in the fairing is ON. At start up, the compressor may operate briefly.

Press the raised surface of each button to inflate the chambers. The flat side of the button deflates the chambers.

## Rider Thigh Zone

See Figure 5. The first button on the seat control panel inflates and deflates the thigh chambers.

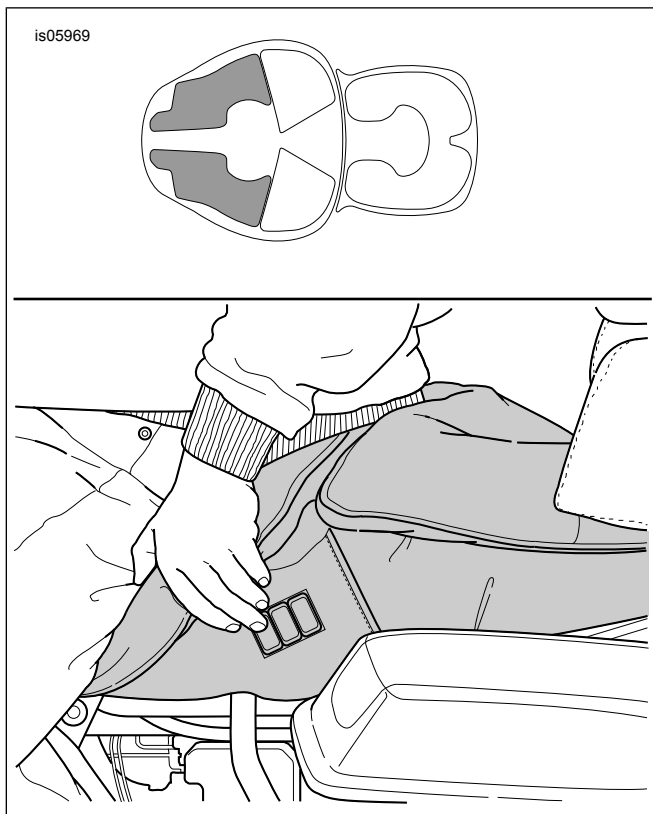

Figure 5. Rider Thigh Control

## Rider Lower Back Zone

See Figure 6. The second button on the seat control panel inflates and deflates the lower back chambers.

## Passenger Thigh Zone

See Figure 7. The third button on the seat control panel inflates and deflates the passenger chambers.

## Riding Recommendations

### ⚠ WARNING

**Do not adjust seat while riding. Adjusting seat while riding can distract the rider and lead to loss of control, which could result in death or serious injury. (00598c)**

Before you ride:

- Deflate all chambers completely.
- Adjust the thigh chamber to press firmly, but comfortably, against you.
- Adjust the lower back chamber to press comfortably against you.

**City Riding:** When riding requires frequent stops, it may be more comfortable to keep the thigh chamber only slightly filled or empty.

**Touring:** Adjust the thigh chamber to apply firm but comfortable pressure. If desired, adjust the lower back chambers while your feet are in a touring position. On long rides, it may be desired to adjust the seat at every rest stop to change position. This will improve the blood circulation resulting in less fatigue and improved long distance comfort.

**Passenger Comfort:** While seated but not moving:

- Practice finding the switches without looking for the buttons.
- Deflate all the chambers completely.
- Adjust the thigh chamber to press firmly but comfortably against you.

## Troubleshooting

- If the compressor continues to run without pressing the inflation buttons, disconnect power to the seat immediately.
- If the seat does not inflate either the rider or the passenger areas when the inflation buttons are pressed, check all electrical connections.

If any of these conditions persist, disconnect the seat electrical power and return to the dealer for further investigation..

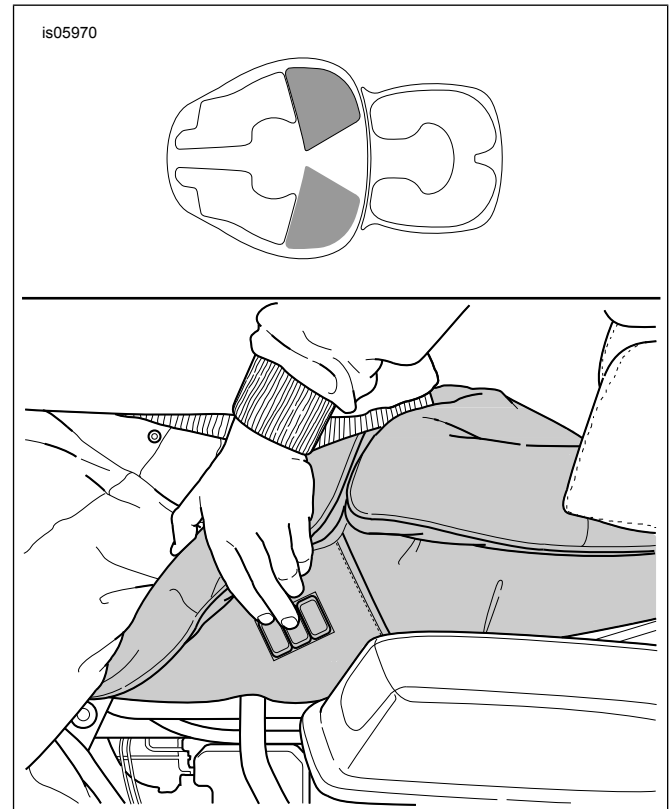

Figure 6. Rider Tailbone Zone

is05972

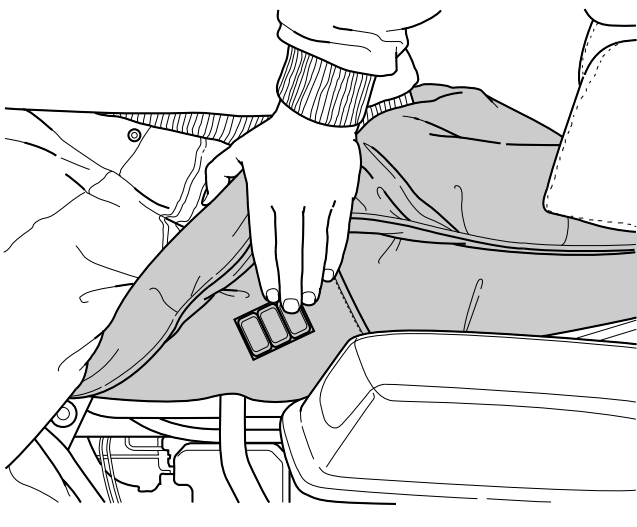
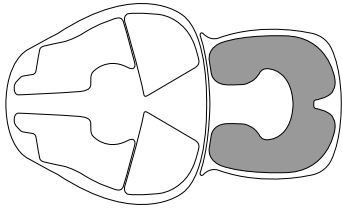

Figure 7. Passenger Thigh Zone

## SERVICE PARTS

is05975

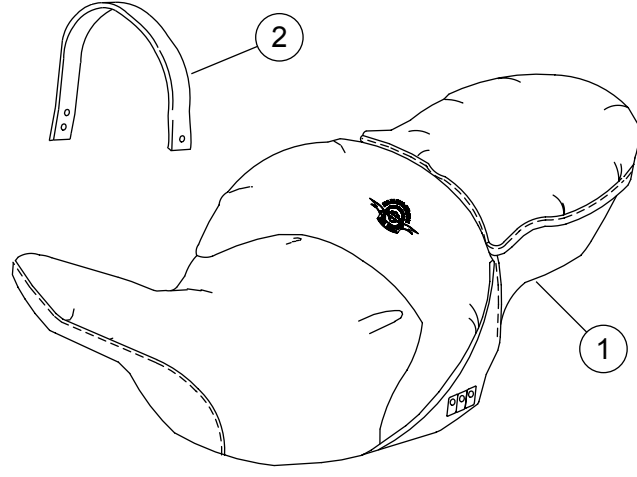

Figure 8. Service Parts: Road Zeppelin Seat

Table 1. Service Parts

Item	Description (Quantity)	Part Number
1	Seat	Not Sold Separately
2	Grabstrap	51051-09