



# INSTRUCTIONS

J04573

2013-06-06



## FRONT MAGNUM 5 WHEEL

### GENERAL

#### ▲ WARNING

Install only wheels and installation kits approved for your model motorcycle. Contact a Harley-Davidson dealer to verify fitment. Mismatching wheels and installation kits or installing wheels not approved for your model can cause loss of control, which could result in death or serious injury. (00610c)

### Kit Number

43621-09, 40806-09, 40516-10, 40125-10, 43300049, 43300051

### Models

For model fitment information, see the P&A Catalog or the Parts and Accessories section of [www.harley-davidson.com](http://www.harley-davidson.com).

#### NOTE

Accessory hub caps are not compatible with this wheel.

### Kit Contents

This kit includes the custom wheel only.

### Additional Parts Required

Proper installation of this kit requires the separate purchase of the following parts which are available at a Harley-Davidson dealer:

- Wheel Installation Kit (See Table 3 through Table 8 to determine required installation kit.)
- Brake Disc Screws (See Figure 1 and Table 1.)
- Wheel Bearing Remover and Installer (94134-09A)
- If installing on a Dyna model with an original equipment 19-inch laced front wheel, separate purchase of stock brake disc (44553-06A) or polished brake disc (41500012) is required.

#### ▲ WARNING

Rider and passenger safety depend upon the correct installation of this kit. Use the appropriate service manual procedures. If the procedure is not within your capabilities or you do not have the correct tools, have a Harley-Davidson dealer perform the installation. Improper installation of this kit could result in death or serious injury. (00333b)

#### NOTE

This instruction sheet references service manual information. A service manual for your model motorcycle is required for this installation and is available from a Harley-Davidson dealer.

### Recommended Additional Parts

It is recommended that a floating brake rotor be purchased separately if objectionable brake noise is experienced from the brake rotor. Refer to the P&A Retail Catalog or the Parts and Accessories section of [www.harley-davidson.com](http://www.harley-davidson.com) for part numbers.

The following Harley-Davidson Genuine Motor Accessories are recommended for proper maintenance and cleaning:

- Harley® Bright™ Chrome Cleaner (94683-99)
- Harley® Glaze™ Polish and Sealant (99701-84)
- Harley® Wheel and Spoke Brush (43078-99)
- Harley-Davidson® Wheel and Tire Cleaner (94658-98)
- Harley® Preserve™ Bare Aluminum Protectant (99845-07)

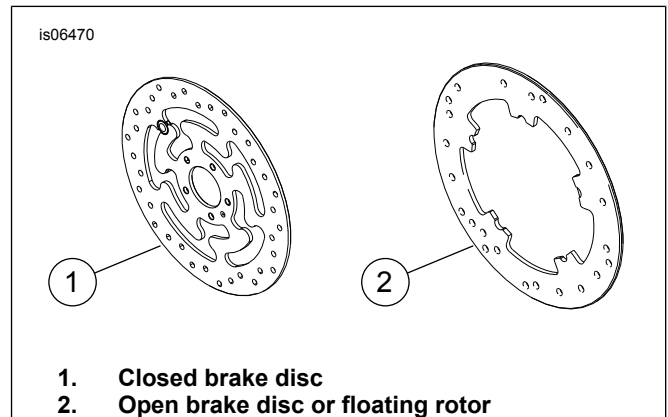

Figure 1. Front Brake Disc Styles

Table 1. Front Disc Hardware Fitment

Brake Disc	Hardware
Closed disc	5 Stock disc screws (3655A)
	Chrome screw kit (46646-05) includes 5 screws
Open disc	5 Stock disc screws (3762M) and 5 disc washers (6966M)

NOTE: Models equipped with dual front brakes and models being equipped with a wheel with dual brake mounting surfaces require twice as many screws/washers (10 total screws or 2 chrome screw kits if available).

### INSTALLATION

#### NOTE

Prior to removing or installing the wheel, the front brake caliper must be removed.

Use plastic protectors on the tire mounting tools and rim clamps when mounting a tire to a painted wheel.



For wide low profile tires, a tire mounting machine with a second arm to press down on the sidewall while the wheel is rotating is recommended.

When mounting tires, liberally use tire lube on the wheel and tire.

For tire removal, use plastic inserts between the rim and tire after breaking the bead to create a large enough gap for the rim clamps.

1. Remove existing front wheel assembly. Save axle, axle nut and wheel spacers for kit installation. Refer to FRONT WHEEL in service manual. If replacing a Dyna stock cast wheel, save the open-style brake rotor for future use.

**NOTE**

**For Kits 40806-09, 40125-10 and 43300051:** Install short valve stem (43157-83A) included in the installation kit.

- For 2006 and later FXDWG Models: When correctly installed, the tire will be 2–5 mm (0.08–0.2 in) off of center, compared to the fender.

**For Kits 43621-09, 40516-10 and 43300049:** Install long valve stem (43206-01) included in the installation kit.

**NOTICE**

**Do not re-use brake disc/rotor screws. Re-using these screws can result in torque loss and damage to brake components. (00319c)**

2. See Figure 2. Install valve stem assembly (L or M) on wheel. Refer to TIRES in service manual.
3. Assemble wheel installation kit components and brake disc(s) to wheel, using the appropriate service parts table. Refer to FRONT WHEEL in service manual.

**SERVICE PARTS**

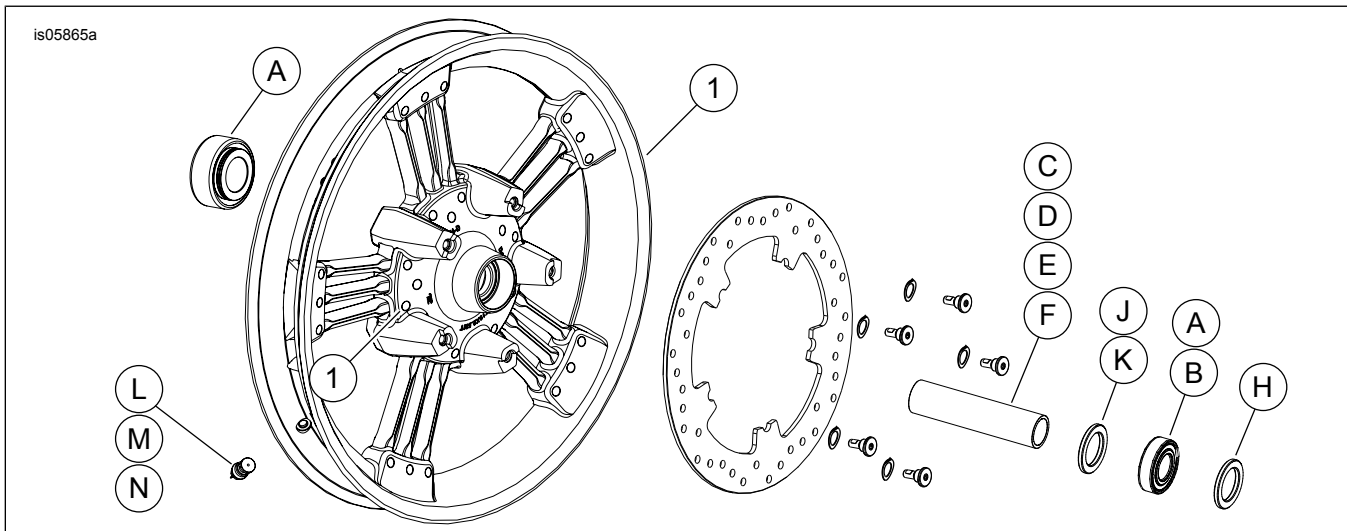

**Figure 2. Service Parts: Front Magnum 5 Wheels (19-inch shown)**

**NOTE**

**For 2007 and later Softail models or 2008 and later Dyna models:** Install the bearing shim indicated in the service parts table for your year and model motorcycle.

Install the primary bearing first with the WHEEL BEARING REMOVER/INSTALLER, following the service manual instructions.

The brake mounting surfaces on the left side of the wheel indicate the primary bearing side.

4. Install wheel assembly parts from the appropriate service parts table for your fitment and stock brake disc(s). Discard parts from the installation kit that are not required. Refer to FRONT WHEEL in service manual.
5. Mount and balance tire.
6. Install wheel spacer (H) previously removed.
7. Install front wheel (1), stock axle and stock axle nut. Refer to FRONT WHEEL in service manual.

**MAINTENANCE AND CLEANING**

Chrome parts must be maintained regularly so they keep their original shine and luster.

1. Clean heavily-soiled wheel surfaces using Harley-Davidson Wheel and Tire Cleaner, applied with Harley Wheel and Spoke Brush.
2. Thoroughly clean chrome with a good quality chrome cleaner, such as Harley Bright Chrome Cleaner.
3. After cleaning and polishing, seal the finish with a good quality sealer, such as Harley Glaze Polish and Sealant.

**Table 2. Service Parts and Wheel Kit Contents**

Kit	Item	Description (Quantity)	Part Number
43621-09, 40516-10, 40806-09, 40125-10, 43300049, 43300051	1	Wheel	Not Sold Separately

**Table 3. FRONT 3/4 Inch Bearing Wheel Installation Kit (43833-07A)**

FRONT 3/4 Inch Bearing Wheel Installation Kit (43833-07A)		ITEM (Quantity Used and Description)									
Fitment	Wheel Size	A	C	D	E	G	H	I	L	M	
2000-2006 FLST and FLSTF (except 2006 FLSTFSE2)	16 x 3.0 in	2	0	1	0	0	0	0	*	*	
2000-2006 FLSTC and FLSTN	16 x 3.0 in	2	0	1	0	0	0	1	*	*	
2006 FLSTFSEI	17 x 3.5 in	2	0	1	0	0	0	1	*	*	
2008-later FLSTSB	18 x 3.5 in	2	0	***	0	***	0	0	*	*	
2000-2007 XL; 2000-2003 Dyna (except FXDWG)	19 x 2.5 in	2	0	0	1	0	0	0	*	*	
2000-2007 XL; 2000-2003 Dyna (except FXDWG)	21 x 2.15 in	2	0	0	1	0	0	0	*	*	
2000-2006 FXST/B/C; 2000-2005 FXDWG**	21 x 2.15 in	2	1	0	0	0	0	0	*	*	
2000-2006 FXSTS**	21 x 2.15 in	2	1	0	0	0	1	0	*	*	
2000-2006 FXSTD (Except FXSTDSE)**	21 x 2.15 in	2	1	0	0	1	0	0	*	*	
Installation kits are designed to work with many different wheel styles and fitments. Contact a Harley-Davidson dealer to verify that the wheel and installation kits are both designed and approved for the motorcycle they are being installed on. NOTES: * See NOTE above valve installation step in INSTALLATION to determine which valve stem to use for your particular kit. Discard other valve stem(s). ** The right side of the wheel is the primary bearing side for this fitment. *** See INSTALLATION section for separate hardware kit to be used for FLSTSB models.	A	Bearing, regular (2)						9267			
	C	Axle sleeve						43536-00			
	D	Axle sleeve						43608-00			
	E	Axle sleeve						43613-00			
	G	Spacer, axle						40910-00A			
	H	Spacer, axle						43313-98			
	I	Spacer, wheel						43617-00A			
L	Valve stem, short						43157-83A				
M	Valve stem, long						43206-01				

**Table 4. FRONT 1 Inch Bearing Wheel Installation Kit (43848-08A)**

FRONT 1 Inch Bearing Wheel Installation Kit (43848-08A)		ITEM (Quantity Used and Description)							
Fitment	Wheel Size	A	C	D	E	F	L	M	
2000-2007 Touring	16 x 3.0 in	2	1	0	0	0	*	*	
2004-2007 Touring	18 x 3.5 in	2	1	0	0	0	*	*	
2004-2005 Dyna (except FXDWG)	19 x 2.5 in	2	0	0	0	1	*	*	
2006-2007 Dyna (except FXDWG)	19 x 2.5 in	2	0	0	1	0	*	*	
2002-2007 VRSC	19 x 3.0 in	2	0	0	1	0	*	*	
2006-2007 FXDWG**	21 x 2.15 in	2	0	1	0	0	*	*	
2004-2005 Dyna (except FXDWG)	21 x 2.15 in	2	0	0	0	1	*	*	
Installation kits are designed to work with many different wheel styles and fitments. Contact a Harley-Davidson dealer to verify that the wheel and installation kits are both designed and approved for the motorcycle they are being installed on. NOTES: * See NOTE above valve installation step in INSTALLATION to determine which valve stem to use for your particular kit. Discard other valve stem(s). ** The right side of the wheel is the primary bearing side for this fitment.	A	Bearing, regular (2)						9247	
	C	Axle sleeve						43517-00	
	D	Axle sleeve						43633-06	
	E	Axle sleeve						43641-01	
	F	Axle sleeve						43755-04	
	L	Valve stem, short						43157-83A	
	M	Valve stem, long						43206-01	

**Table 5. FRONT 25 mm Bearing Wheel Installation Kit (41455-08C)**

FRONT 25 mm Bearing Wheel Installation Kit (41455-08C)		ITEM (Quantity Used and Description)								
Fitment	Wheel Size	A	C	D	J	K	L	M	N	
2008 Touring; 2009 and later FLHRC (non-ABS) and Trike (non-ABS)	16 x 3.0 in	2	0	1	0	**	*	*	*	
2009 and later Touring (non-ABS)	17 x 3.0 in	2	0	1	0	0	*	*	*	
2008 and later Touring (non-ABS)	18 x 3.5 in	2	0	1	0	**	*	*	*	
2008 and later Dyna (except FLD, FXDWG and FXDF)	19 x 2.5 in	2	1	0	**	0	*	*	0	
2008 and later VRSCAW, VRSCD, VRSCF and VRSCDX (non-ABS)	19 x 3.0 in	2	1	0	**	0	*	*	0	
2009 and later Touring (non-ABS)	19 x 3.5 in	2	0	1	0	0	*	*	*	

**Table 5. FRONT 25 mm Bearing Wheel Installation Kit (41455-08C)**

FRONT 25 mm Bearing Wheel Installation Kit (41455-08C)		ITEM (Quantity Used and Description)								
Fitment	Wheel Size	A	C	D	J	K	L	M	N	
Installation kits are designed to work with many different wheel styles and fitments. Contact a Harley-Davidson dealer to verify that the wheel and installation kits are both designed and approved for the motorcycle they are being installed on. NOTES: * See NOTE above valve installation step in INSTALLATION to determine which valve stem to use for your particular kit. Discard other valve stem(s). ** See NOTES for your wheel kit above the wheel assembly step in INSTALLATION to determine if bearing shim is used for your particular wheel kit and fitment. *** Bearing shim installed under the primary bearing.		A	Bearing, regular (2)		9276					
		C	Axle sleeve		41748-08					
		D	Axle sleeve		41900-08					
		J	Bearing shim***		41450-08					
		K	Bearing shim***		43903-08					
		L	Valve stem, short		43157-83A					
		M	Valve stem, long		43206-01					
	N	Valve stem, pull thru		40999-87						

**Table 6. FRONT 25 mm Bearing Wheel Installation Kit (43851-11A)**

FRONT 25 mm Bearing Wheel Installation Kit (43851-11A)		ITEM (Quantity Used and Description)								
Fitment	Wheel Size	A	C	G	H	J	L	M	N	
2007 and later FLSTC, FLSTN and FLS (non-ABS)	16 x 3.0 in	2	1	0	1	****	*	*	*	
2008 and later FXDF	16 x 3.0 in	2	1	0	0	0	*	*	*	
2007 and later FLSTF and FLSTFB (non-ABS)	17 x 3.5 in	2	1	0	0	0	*	*	*	
2008 and later FLSTF and FLSTFB (non-ABS)	18 x 3.5 in	2	1	0	0	0	*	*	*	
2008 and later FXDF; 2012 and later FLD	18 x 3.5 in	2	1	0	0	0	*	*	*	
2007 and later FXS, FXST/B/C (non-ABS); 2008 and later FXD-WG***	21 x 2.15 in	2	1	0	0	1	*	*	*	
2007 FXSTD***	21 x 2.15 in	2	1	1	0	1	*	*	*	
Installation kits are designed to work with many different wheel styles and fitments. Contact a Harley-Davidson dealer to verify that the wheel and installation kits are both designed and approved for the motorcycle they are being installed on. NOTES: * See NOTE above valve installation step in INSTALLATION to determine which valve stem to use for your particular kit. Discard other valve stem(s). ** Bearing shim installed under the primary bearing. *** The left side of the wheel is the primary bearing side for this fitment. **** See NOTES for your wheel kit above the wheel assembly step in INSTALLATION to determine if the bearing shim is needed.		A	Bearing, regular (2)		9276					
		C	Axle sleeve		41349-07					
		G	Spacer, axle		41504-07					
		H	Spacer, axle		41695-07					
		J	Bearing shim**		43315-07					
		L	Valve stem, short		43157-83A					
		M	Valve stem, long		43206-01					
	N	Valve stem, pull-thru		40999-87						

**Table 7. FRONT 25 mm Bearing ABS Wheel Installation Kit (41454-08B)**

FRONT 25 mm Bearing ABS Wheel Installation Kit (41454-08B)		ITEM (Quantity Used and Description)								
Fitment	Wheel Size	A	B	C	D	J	K	L	M	N
2008 Touring and 2009 and later FLHRC with ABS	16 x 3.0 in	1	1	0	1	0	**	*	*	0
2009 and later Touring with ABS	17 x 3.0 in	1	1	0	1	0	0	*	*	*
2008 and later Touring with ABS	18 x 3.5 in	1	1	0	1	**	**	*	*	*
2012 and later Dyna with ABS (Except FLD, FXDWG and FXDF)	19 x 2.5 in	1	1	1	0	**	0	*	*	0
2008 and later VRSCAW, VRSCD, VRSCF and VRSCDX with ABS	19 x 3.0 in	1	1	1	0	**	**	*	*	0
2009 and later Touring with ABS	19 x 3.5 in	1	1	0	1	0	0	*	*	*
Installation kits are designed to work with many different wheel styles and fitments. Contact a Harley-Davidson dealer to verify that the wheel and installation kits are both designed and approved for the motorcycle they are being installed on. NOTES: * See NOTE above valve installation step in INSTALLATION to determine which valve stem to use for your particular kit. Discard other valve stem(s). ** See NOTES for your wheel kit above the wheel assembly step in INSTALLATION to determine which bearing shim to use for your particular wheel kit and fitment. *** Red side of bearing must be installed toward the wheel. The ABS bearing is primary. **** Bearing shim installed under the primary bearing.		A	Bearing, regular		9276					
		B	Bearing, ABS***		9252					
		C	Axle sleeve		41748-08					
		D	Axle sleeve		41900-08					
		J	Bearing shim****		41450-08					
		K	Bearing shim****		43903-08					
		L	Valve stem, short		43157-83A					
	M	Valve stem, long		43206-01						
	N	Valve stem, pull thru		40999-87						

**Table 8. FRONT 25 mm Bearing ABS Wheel Installation Kit (42400010)**

FRONT 25 mm Bearing ABS Wheel Installation Kit (42400010)		ITEM (Quantity Used and Description)								
Fitment	Wheel Size	A	B	C	G	J	K	L	M	N
2011 and later FLSTC, FLSTN and FLS with ABS	16 x 3.0 in	1	1	1	1	0	****	*	*	*
2012 and later FXDF with ABS	16 x 3.0 in	1	1	1	0	0	0	*	*	*
2011 and later FLSTF and FLSTFB with ABS	17 x 3.5 in	1	1	1	0	0	0	*	*	*
2011 and later FLSTF and FLSTFB with ABS	18 x 3.5 in	1	1	1	0	0	0	*	*	*
2012 and later FXDF and FLD with ABS	18 x 3.5 in	1	1	1	0	0	0	*	*	*

**Table 8. FRONT 25 mm Bearing ABS Wheel Installation Kit (42400010)**

FRONT 25 mm Bearing ABS Wheel Installation Kit (42400010)		ITEM (Quantity Used and Description)									
Fitment	Wheel Size	A	B	C	G	J	K	L	M	N	
2011 and later FXS, FXST and 2012 and later FXDWG with ABS	21 x 2.15 in	1	1	1	0	0	1	*	*	*	
Installation kits are designed to work with many different wheel styles and fitments. Contact a Harley-Davidson dealer to verify that the wheel and installation kits are both designed and approved for the motorcycle they are being installed on. NOTES: * See <i>NOTE</i> above valve installation step in INSTALLATION to determine which valve stem to use for your particular kit. Discard other valve stem(s). ** Red side of bearing must be installed toward the wheel. The ABS bearing is the primary bearing. *** Bearing shim installed under the primary bearing. **** See NOTES for your wheel kit above the wheel assembly step in INSTALLATION to determine if the bearing shim is needed.		A	Bearing, regular		9276A						
		B	Bearing, ABS**		9252						
		C	Axle sleeve		41349-07						
		G	Spacer		41695-07						
		J	Bearing shim***		41448-08						
		K	Bearing shim***		43315-07						
		L	Valve stem, short		43157-83A						
		M	Valve stem, long		43206-01						
N	Valve stem, pull-thru		40999-87								