



INSTRUCTIONS

J04678

2017-10-25



6-SPEED TRANSMISSION MAINSHAFT KIT

GENERAL

Kit Number

35467-06C

Models

This kit fits all models equipped with a 6-Speed Cruise Drive Transmission.

Additional Parts Required

Proper installation of this kit requires the use of the following tools: Retaining Ring Pliers (J-5586-A) and Bearing Race Puller and Installation Tool (HD-34902-B).

⚠ WARNING

Rider and passenger safety depend upon the correct installation of this kit. Use the appropriate service manual procedures. If the procedure is not within your capabilities or you do not have the correct tools, have a Harley-Davidson dealer perform the installation. Improper installation of this kit could result in death or serious injury. (00333b)

NOTE

This instruction sheet references service manual information. A service manual for your model motorcycle is required for this installation and is available from a Harley-Davidson Dealer.

Kit Contents

See Figure 1 and Table 1.

INSTALLATION

NOTE

*The new guide hub, retaining ring and inner race bearing **must** be installed when replacing the mainshaft.*

Refer to an appropriate service manual and replace the transmission mainshaft, guide hub, retaining ring and inner race included in the kit.

SERVICE PARTS

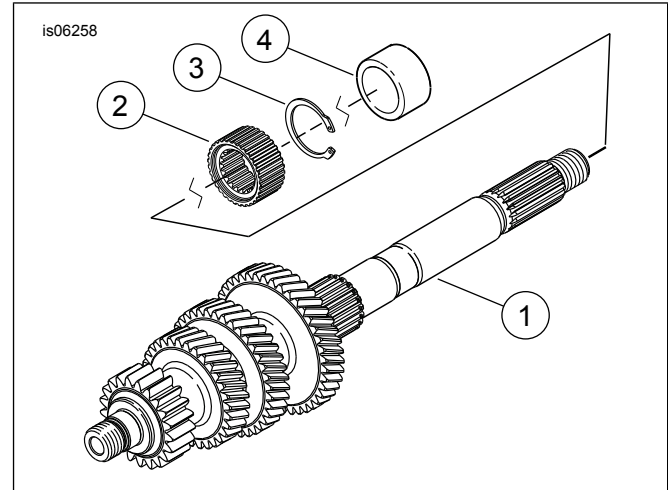

Figure 1. Service Parts: 6-Speed Transmission Mainshaft Kit

Table 1. Service Parts

Item	Description (Quantity)	Part Number
1	Mainshaft	35000177
2	Guide hub	35000178
3	Retaining ring	12200144
4	Inner race bearing	34091-08