



INSTRUCTIONS

J04828

2013-04-22



SIGNATURE SERIES PILLION KIT

GENERAL

Kit Number

51770-09 and 52000133

Models

For model fitment information, see the P&A Retail Catalog or the Parts and Accessories section of www.harley-davidson.com (English only).

Additional Parts Required

Separate purchase of the Signature Series Solo Seat Kit (Part No. 51700-09) is required for proper installation of this kit.

⚠ WARNING

Rider and passenger safety depend upon the correct installation of this kit. Use the appropriate service manual procedures. If the procedure is not within your capabilities or you do not have the correct tools, have a Harley-Davidson dealer perform the installation. Improper installation of this kit could result in death or serious injury. (00333b)

NOTE

This instruction sheet references service manual information. A service manual for your model motorcycle is required for this installation and is available from a Harley-Davidson dealer.

Kit Contents

See Figure 2 and Table 1.

REMOVAL

1. Remove stock seat and grab strap following the instructions in the service manual.
2. Remove fender trim strips (if equipped):
 - a. Cover the tip of a regular screwdriver with a piece of tape to protect chrome and painted surfaces.
 - b. See Figure 1. Insert the tip of the screwdriver between the chrome bezel and the rubber trim strip.
 - c. Pry up the bezel enough to get a hold of it, then pull it up and away from the rubber trim strip.
 - d. Starting at either end, peel the rubber trim strip away from the fender.
 - e. Clean any remaining adhesive off of the fender using an approximately 1:1 solution of distilled water and isopropyl alcohol.

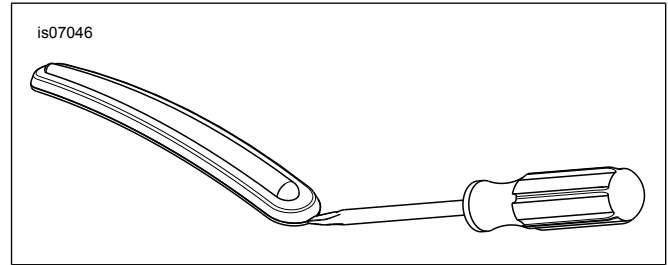

Figure 1. Remove Fender Trim Strip

INSTALLATION

Kit 52000133:

1. Install grab strap end into grab strap bracket slot. Align the grab strap hole with the bracket hole.
2. Install grab strap screw (G) and washer (H). Tighten to 5.4–8.1 N·m (4–6 ft-lbs).

Kit 51770-09

1. Install the grab strap (4) with the seat mounting studs (A) through the inner grab strap holes (F).

For All Models

1. Refer to solo seat instruction sheet for installation of rider seat (C) and backrest (D).
2. Install the mounting nuts (E).
3. Tighten nuts snugly.
4. Slide slots on leading edge of passenger pillion (1) onto seat mounting nuts (E) while sliding the pillion through the grab strap.
5. Install mounting screw (B) from stock seat through the mounting tab and tighten to 4–7 N·m (36–60 in-lbs).

⚠ WARNING

After installing seat, pull upward on seat to be sure it is locked in position. While riding, a loose seat can shift causing loss of control, which could result in death or serious injury. (00070b)

6. Pull on seat and pillion to verify they are securely installed.



SERVICE PARTS

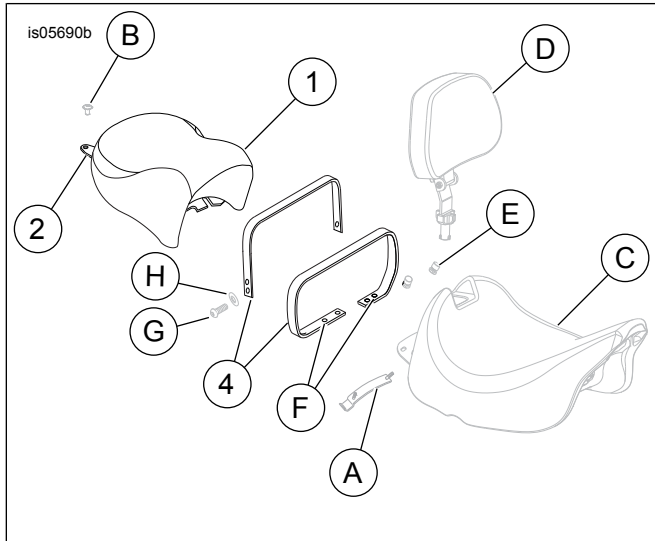

Figure 2. Service Parts: Pillion Kit

Table 1. Service Parts Table

Item	Description (Quantity)	Part Number
1	Pillion	Not Sold Separately
2	Mounting tab	51652-97A
3	Mounting tab screw (2) (not shown)	3588
4	Grab strap (Kit 51770-09)	51863-09
	Grab strap (Kit 52000133)	52400098
Items mentioned in text, but not included in kit:		
A	Mounting stud (2)	
B	Stock screw	2952A
Signature Series Solo Seat Kit (purchased separately) includes Items C-E		51700-09
C	Seat	
D	Backrest	
E	Mounting nut (2)	3638
F	Inner grab strap mounting holes	
G	OE grab strip screw (2)	2952A
H	OE grab strip washer (2)	6703