



INSTRUCTIONS

J04125

2018-02-12



CLASSIC COVERS MOTORCYCLE KITS

GENERAL

Kit Numbers

94946-07, 94947-07, 94948-07, 94949-07, 94921-09, 94922-09, 94923-09, 94924-09, 12700115

Models

B covers 1999-later Dyna, not 1999-2008.

G covers 2009-later Softail except models covered by E and F, which ARE NOT in the 2015 Book.

- See Table 2 for recommended usage area and intended fasteners for each group of covers.
- See Figure 2 for images of each cover and corresponding fasteners.
- If ordering replacement covers from a Harley-Davidson dealer, the part number listed in Table 2 is for a **quantity of one**.

INSTALLATION

NOTE

- Before final installation of cover, test-fit cover to fastener to make sure of proper fitment.
- See Figure 1. For the plug style covers (1), apply adhesive in the area marked "x". For cap style covers (2), apply adhesive in the area marked "x".
- All fasteners must be clean and dry before cover installation. Wash and completely dry the entire motorcycle. Pay particular attention to fastener heads.

Table 1. Models

Kit	Kit Number	Models
A	94946-07	2004-later Sportster® models
B	94947-07	1999-2008 Dyna® models
C	94948-07	2000-2008 Softail® models
D	94949-07	1999-2008 Touring models
E	94921-09	2008-later FXCW/C models
F	94922-09	2008-later FLSTSB models
G	94923-09	2009-later Softail models
H	94924-09	2009-later Touring models
I	12700115	2090-later Touring models

Installation Requirements

Harley-Davidson High-Performance Sealant - Gray (Part No. 99650-02) or equivalent RTV silicone sealant is required for installation of this kit.

NOTE

Due to variations in cover fitments between models and model years, extra covers could remain after kit installation. Covers could also be missing after kit installation. Contact a Harley-Davidson dealer to purchase needed individual covers.

Kit Contents

See Table 2.

NOTE

- The different sizes and types of covers are packaged in groups (with part number on each package).

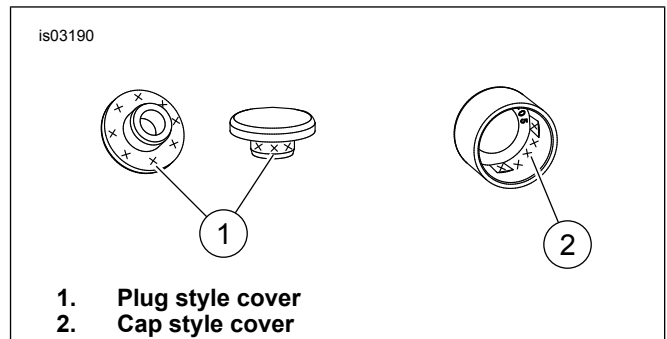

Figure 1. Silicone Adhesive Application Area

1. Open only one part numbered bag of covers at a time. Start in one area of motorcycle and test fit several covers over fasteners. Once correct fitment is confirmed, apply a small amount of Harley-Davidson High-Performance Sealant - Gray (Part No. 99650-02) or equivalent RTV silicone sealant to inside wall of cover. Install over fastener. Remove excess sealant. Repeat with the next part numbered bag of covers.
2. Allow the silicone sealant to cure for a minimum of 12 hours before operating motorcycle.

Table 2. Kit Contents

	Intended Fastener	Recommended Usage (Not applicable to all models)	Part Number	Quantity In Kit								
				A	B	C	D	E	F	G	H	I
1	1/4 in socket head cap screw	Miscellaneous engine and transmission cover screws.	94903-07	56	56	50	50	50	50	50	55	55
2	5/16 in socket head cap screw	Handlebar clamp bolts. Transmission clutch release cover screws.	94904-07 (cap style)	11	11	11	7	7	6	11	8	8
3	5/16 in socket head cap screw	Front fender mounting screws.	94905-07 (plug style)	5	8	8	0	0	5	4	0	0

Table 2. Kit Contents

	Intended Fastener	Recommended Usage (Not applicable to all models)	Part Number	Quantity In Kit								
				A	B	C	D	E	F	G	H	I
4	3/8 in socket head cap screw	Footpeg mounting bolts. Exhaust mounting bolts.	94906-07	3	6	12	3	5	7	6	3	3
5	5/16 in hex socket screw	Rocker box cover screws.	94907-07 (cutaway)	0	8	8	8	8	8	8	8	8
6	5/16 in T40 TORX® button head screw	Front brake disc screws.	94908-07	0	5	5	10	5	5	5	10	10
7	3/8 in T45 TORX button head screw	Rear brake disc screws.	94909-07	0	5	5	0	5	5	5	0	0
8	1/4 in 12-point socket head screw	Brake caliper pins.	94910-07	0	4	4	4	0	0	0	0	0
9	10mm 12-point socket head screw	Brake caliper screws.	94911-07	4	8	8	8	7	2	5	4	4
10	1/2 in flanged hex bolt	Right front motor mount bolt.	94912-07	1	0	1	0	1	1	1	2	2
11	3/8 in T45 TORX button head screw	Rear fender strut screws.	94913-07	4	4	18	0	0	10	10	2	2
12	7/16 in hex bolt	Rear sprocket bolts.	94914-07	5	5	5	0	5	5	5	0	0
13	3/8 in hex bolt (9/16 in hex)	Footpeg mounting bolts.	94915-07	1	11	11	16	2	0	1	0	0
14	3/8 in deep hex bolt (9/16 in hex)	Transmission to engine mounting screws. Footpeg mounting nuts	94916-07	2	6	6	0	0	0	0	0	0
15	1/4 in hex bolt (7/16 in hex)	Tourpak mounting screws. Regulator mounting nut.	94917-07	0	1	0	14	0	2	0	14	14
16	5/16 in hex bolt (1/2 in hex)	Engine case screws.	94918-07	8	10	12	16	4	4	4	10	10
17	1/2 in hex bolt (3/4 in hex)	Rear shock mounting bolts. Handlebar riser bolts.	94919-07	2	2	4	0	4	4	4	0	0
18	1/2 in deep hex nut	Left front motor mount nut.	94920-07	0	0	1	0	1	1	1	0	0
19	7/16 in hex bolt (5/8 in hex)	Engine mount screws. Passenger footboard mounting screws.	94941-07	3	0	0	3	0	0	0	0	0
20	5/16 in T40 TORX® deep button head screw	Brake pedal pivot screw. Front wheel hub screw. Spotlamp and saddlebag mounting bracket screws.	94942-07	4	6	6	9	1	1	4	0	0

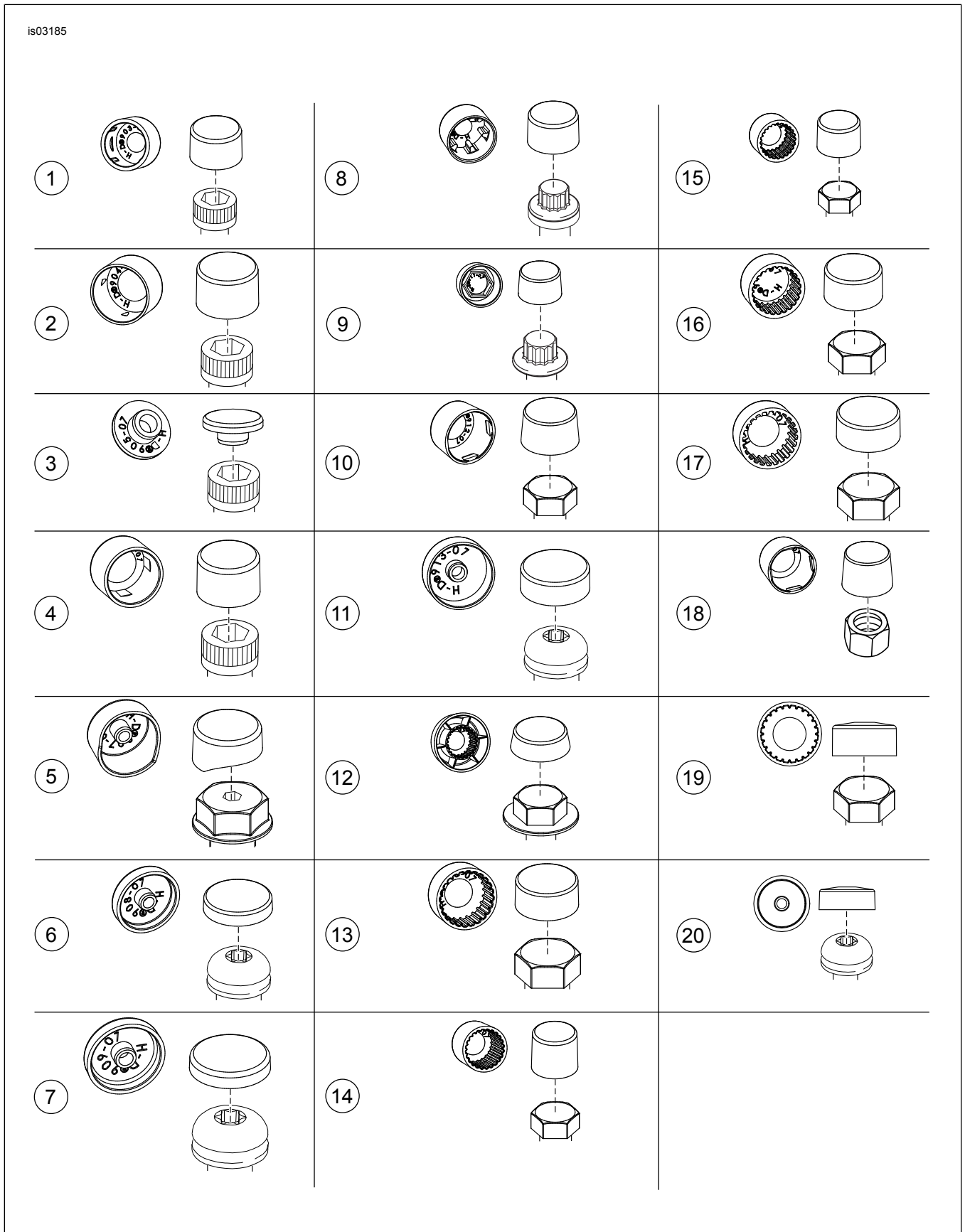

Figure 2. Classic Covers and Corresponding Fasteners